

EXTENSION

TIMBERLANE WOODS SUBDIVISION

This is a request for a one-year extension of a previously approved 33-lot subdivision. The subdivision is located at the North terminus of Cros Creek Drive, extending to the West termini of Larchmont Drive and Timberline Ridge.

This is the first request for an extension since the subdivision was originally approved in 2005. There have not been changes in conditions in the surrounding area that would affect the subdivision as previously approved, nor have there been changes to the regulations that would affect the previous approval.

Based on the preceding, it is recommended that this request for extension be approved.

LOCATOR MAP

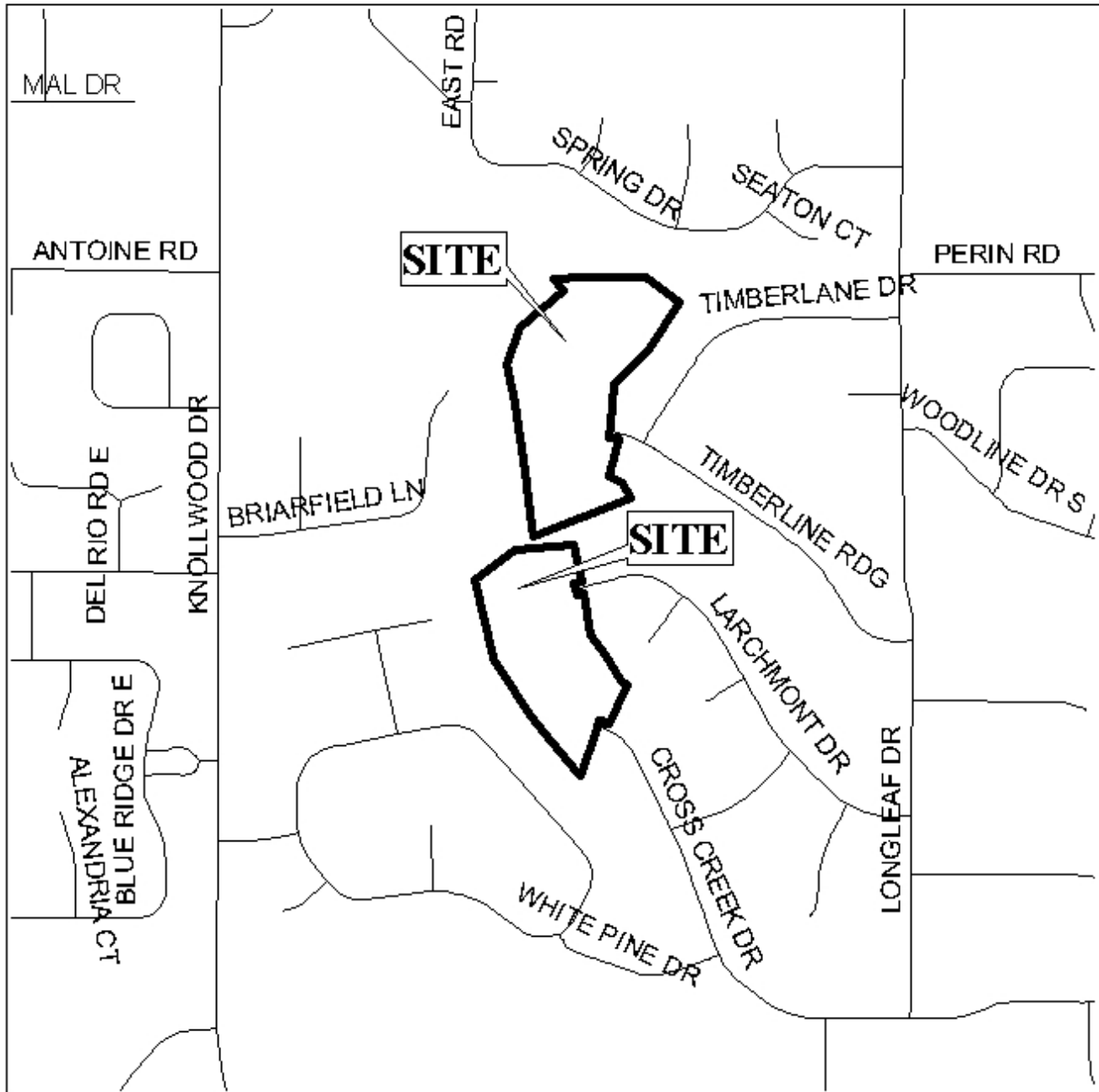

APPLICATION NUMBER Extension DATE January 5, 2006
APPLICANT Timberlane Woods Subdivision
REQUEST Subdivision



TIMBERLANE WOODS SUBDIVISION

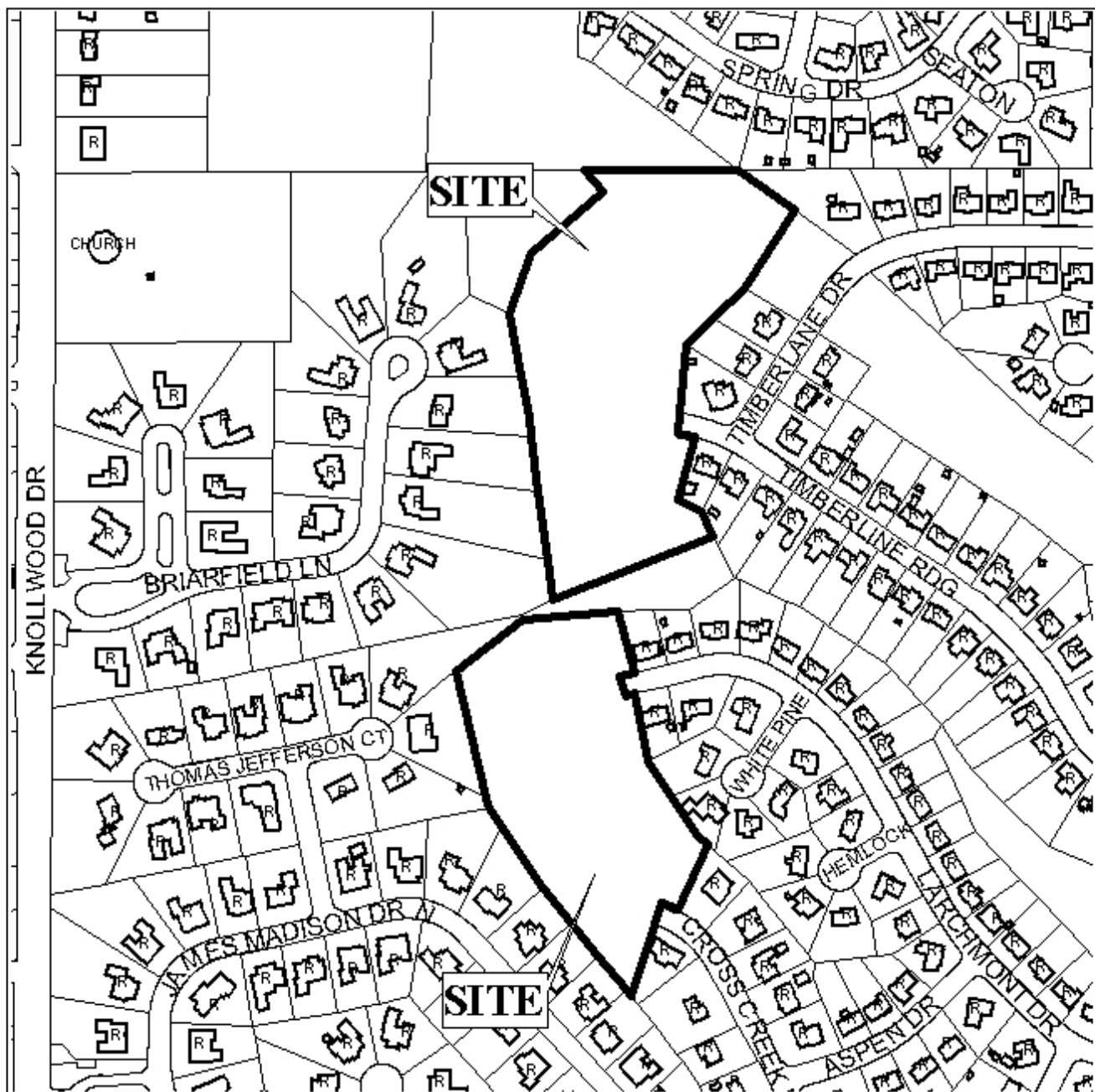

APPLICATION NUMBER Extension DATE January 5, 2006

LEGEND



NTS

DETAIL SITE PLAN

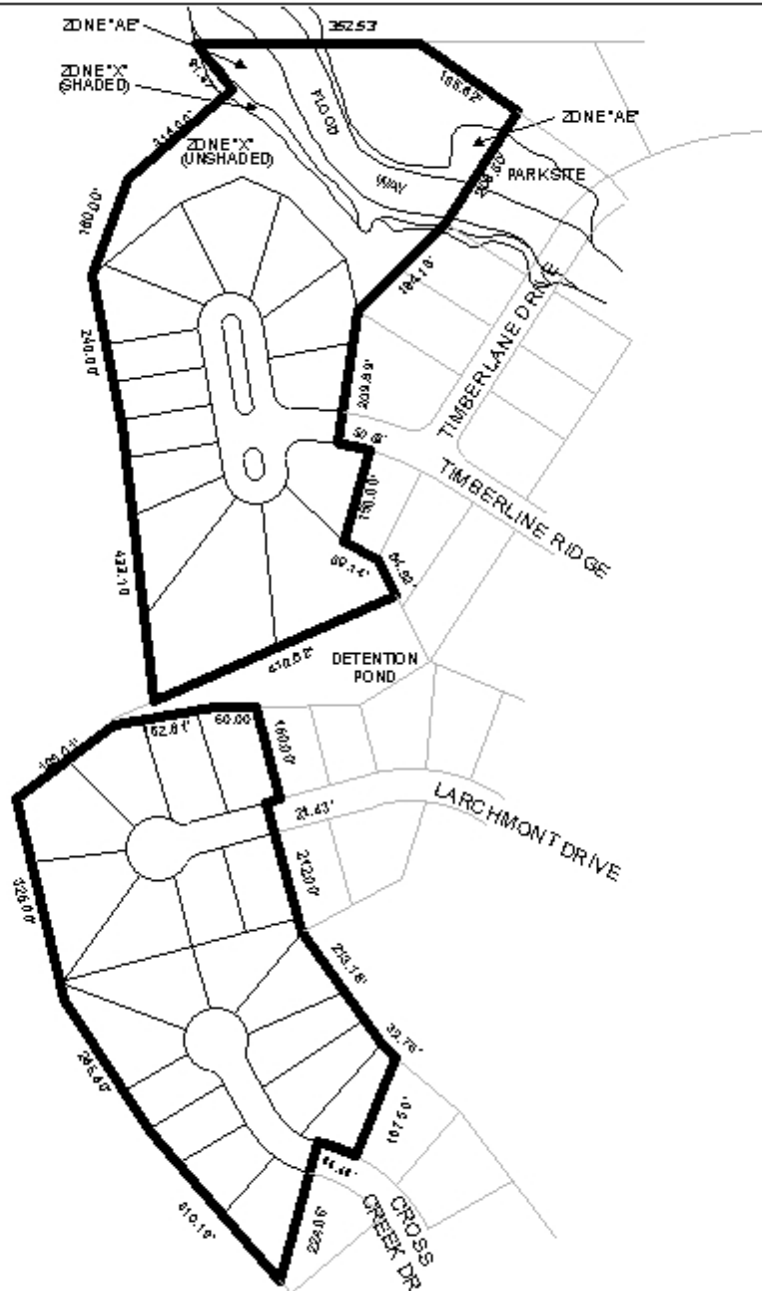

APPLICATION NUMBER Extension DATE January 5, 2006
APPLICANT Timberlane Woods Subdivision
REQUEST Subdivision

