

EXTENSION

COLONNADE SUBDIVISION

This is a request for a one-year extension of a previously approved 20-lot subdivision. The subdivision is located at the southeast corner of Cottage Hill Road and Sollie Road.

There have been no extensions since the subdivision was originally approved, and no units have been recorded. There have been no changes in conditions in the surrounding area that would affect the subdivision as previously approved; nor have there been changes to the Regulations that would affect the previous approval.

Based on the preceding, it is recommended that this request for extension be approved.

LOCATOR MAP

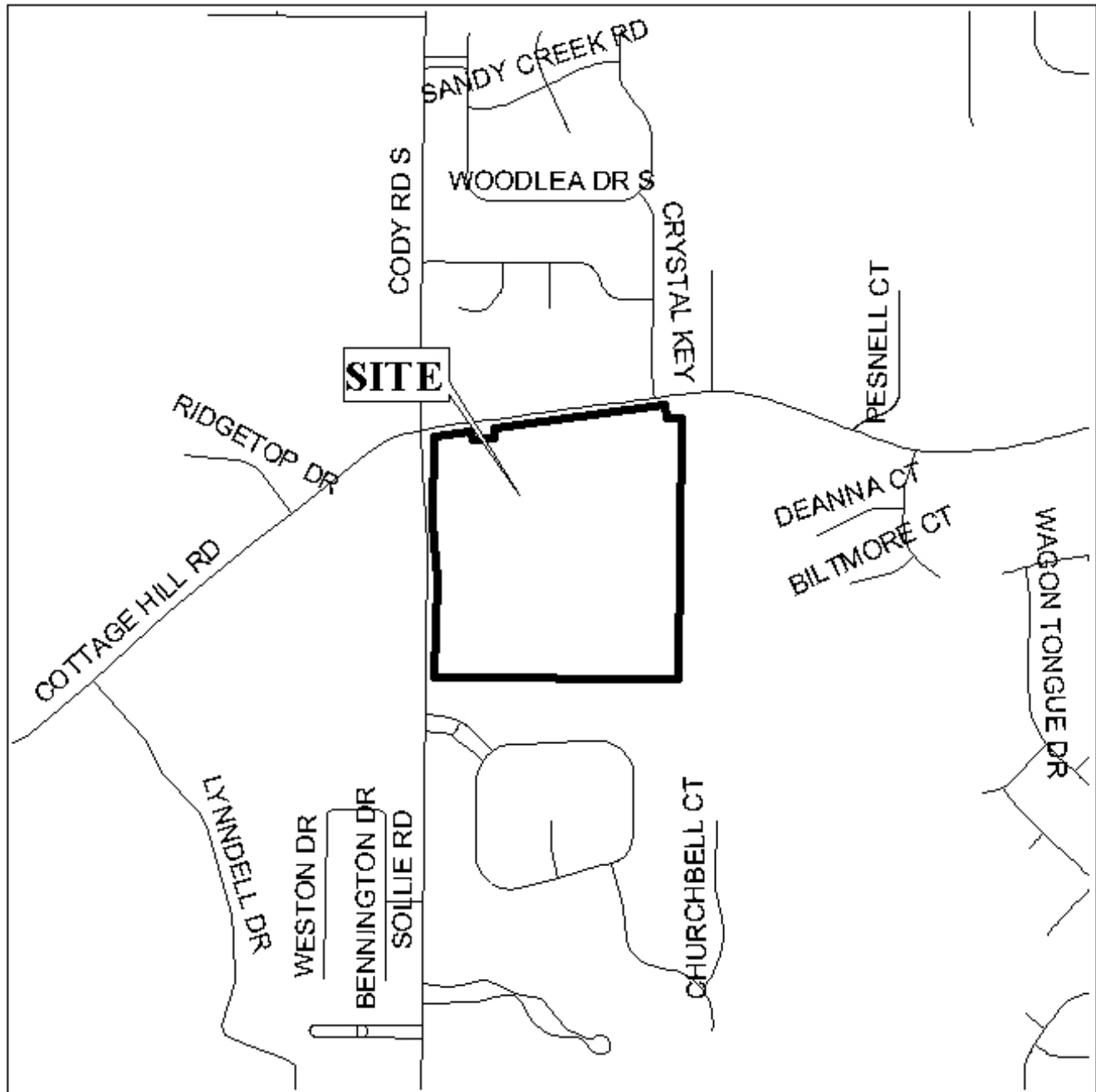

APPLICATION NUMBER Extension DATE February 17, 2005
APPLICANT Colonnade Subdivision
REQUEST Subdivision



NTS

COLONNADE SUBDIVISION

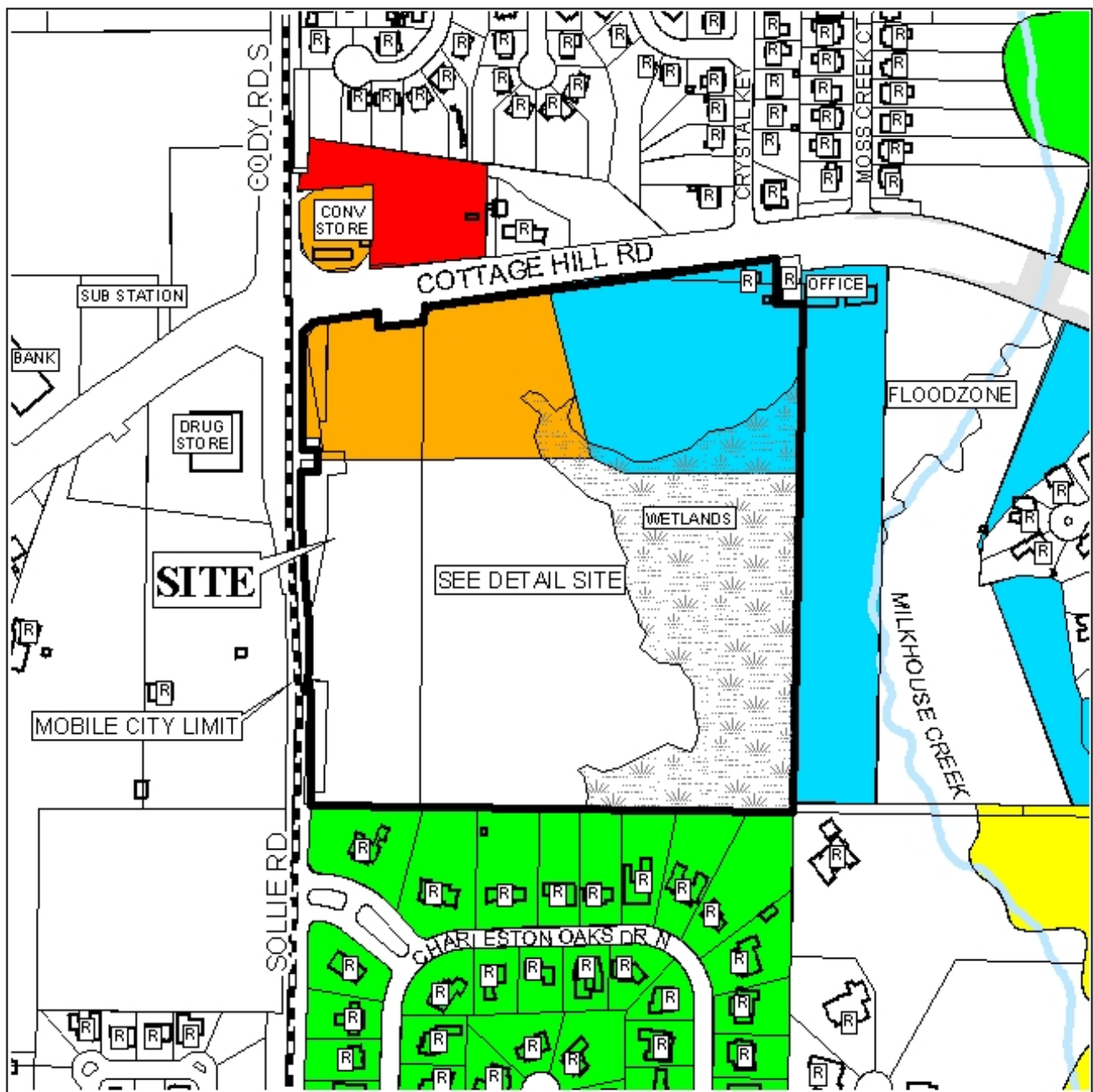

APPLICATION NUMBER Extension DATE February 17, 2005

LEGEND

R-1	R-2	R-3	R-4	R-B	H-B	B-1	LB-2	B-2	B-3	B-4	B-5	I-1	I-2
-----	-----	-----	-----	-----	-----	-----	------	-----	-----	-----	-----	-----	-----

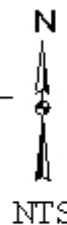

DETAIL SITE PLAN

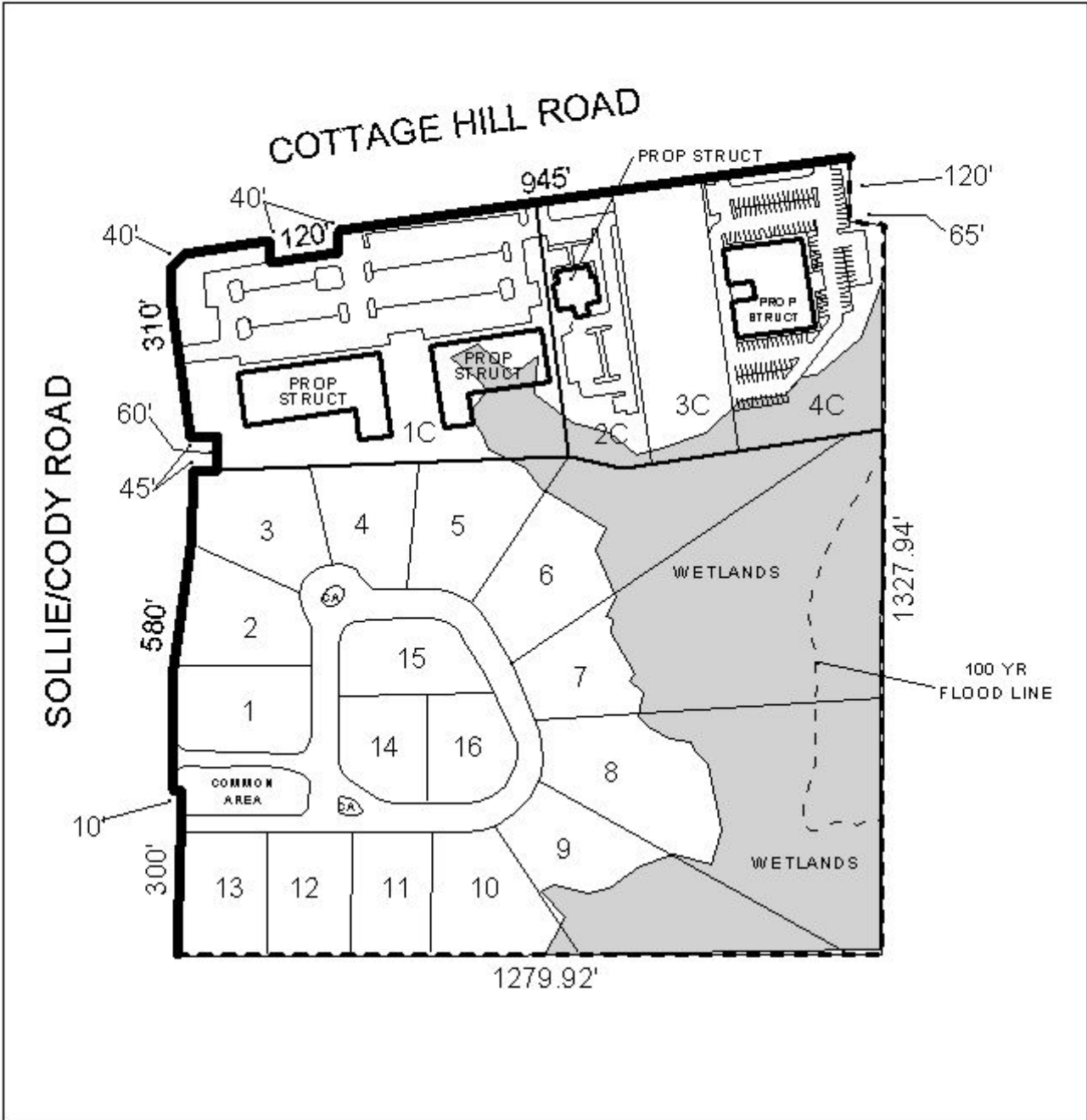

APPLICATION NUMBER Extension DATE February 17, 2005
 APPLICANT Colonnade Subdivision
 USE/REQUEST Subdivision

N

 NTS

NTS