

EXTENSION

RANGELINE PARK SUBDIVISION

This is a request for a one-year extension of a previously approved 45-lot subdivision. The subdivision is located at the Southeast corner of Rangeline Road and Rabbit Creek Drive and extending through to Old Rangeline Road.

There have been five extensions since the subdivision was originally approved in 1996 and Four units have been recorded. There have been no changes in conditions in the surrounding area that would affect the subdivision as previously approved; nor have there been changes to the Regulations that would affect the previous approval.

Based upon the preceding, it is recommended that this request for extension be denied.

LOCATOR MAP

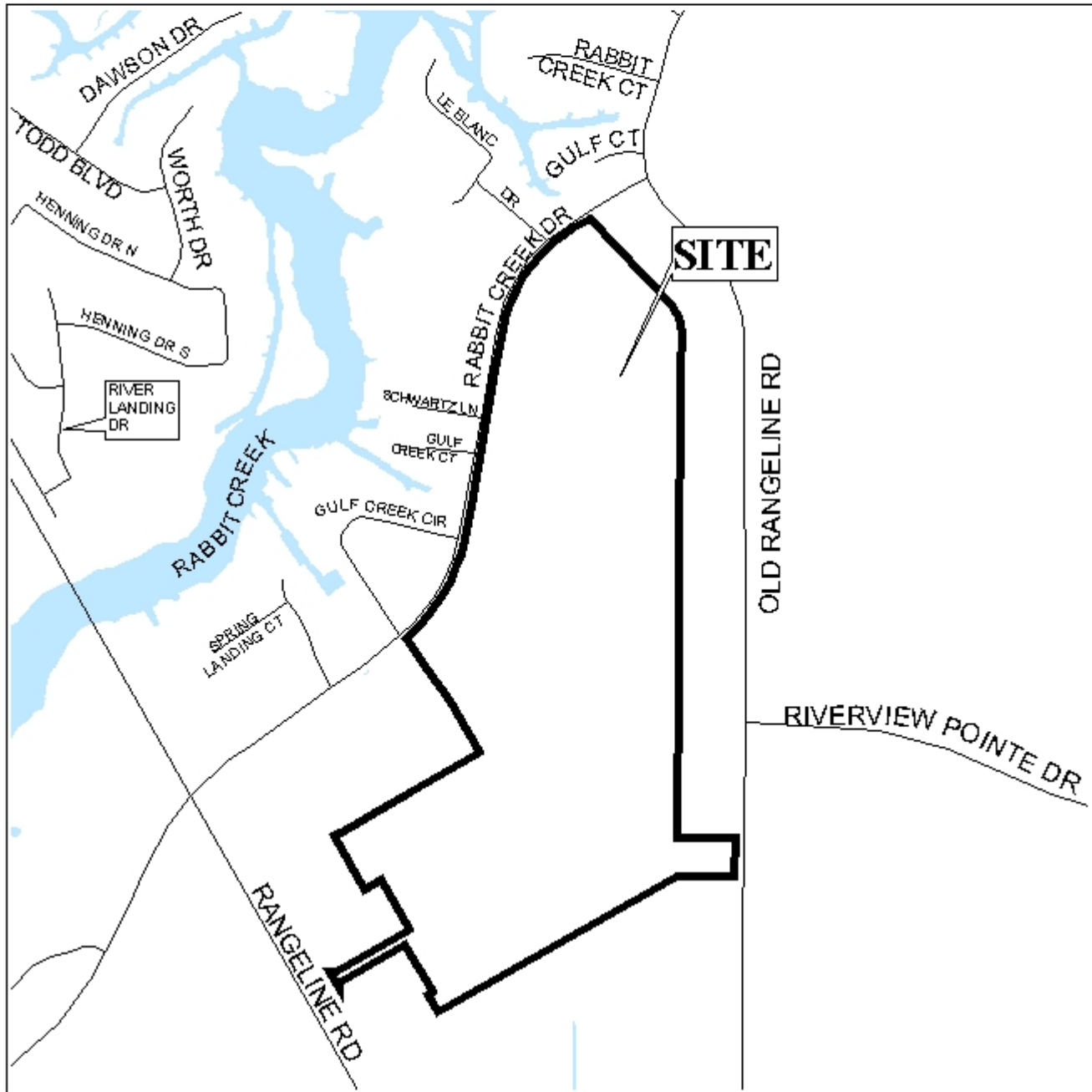

APPLICATION NUMBER Extension DATE August 19, 2004

APPLICANT Rangeline Park Subdivision

REQUEST Subdivision



NTS

RANGELINE PARK SUBDIVISION

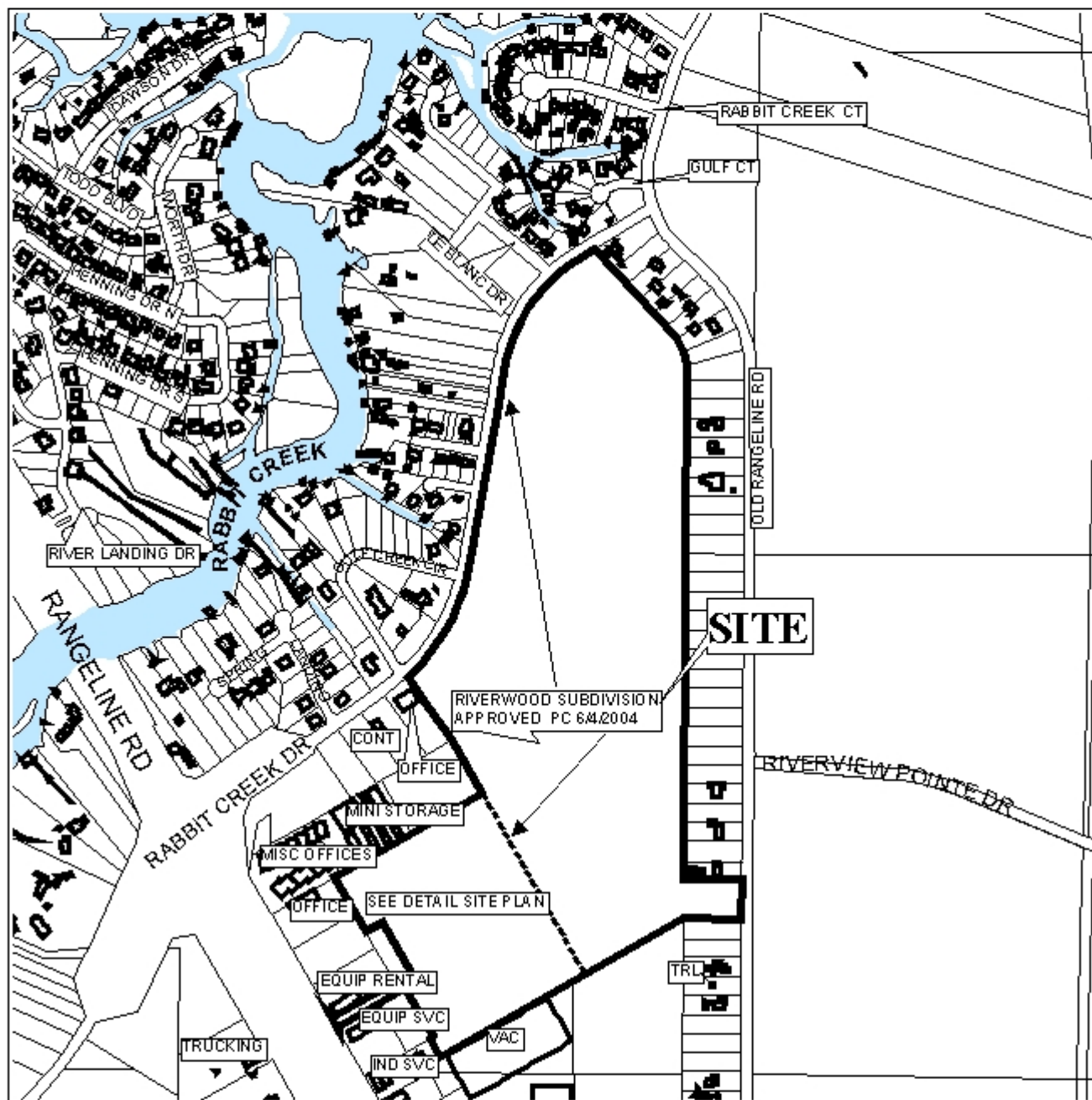

APPLICATION NUMBER Extension DATE August 19, 2004

LEGEND

R-1	R-2	R-3	R-A	R-B	H-B	B-1	LB-2	B-2	B-3	B-4	B-5	I-1	I-2



NTS

DETAIL SITE PLAN

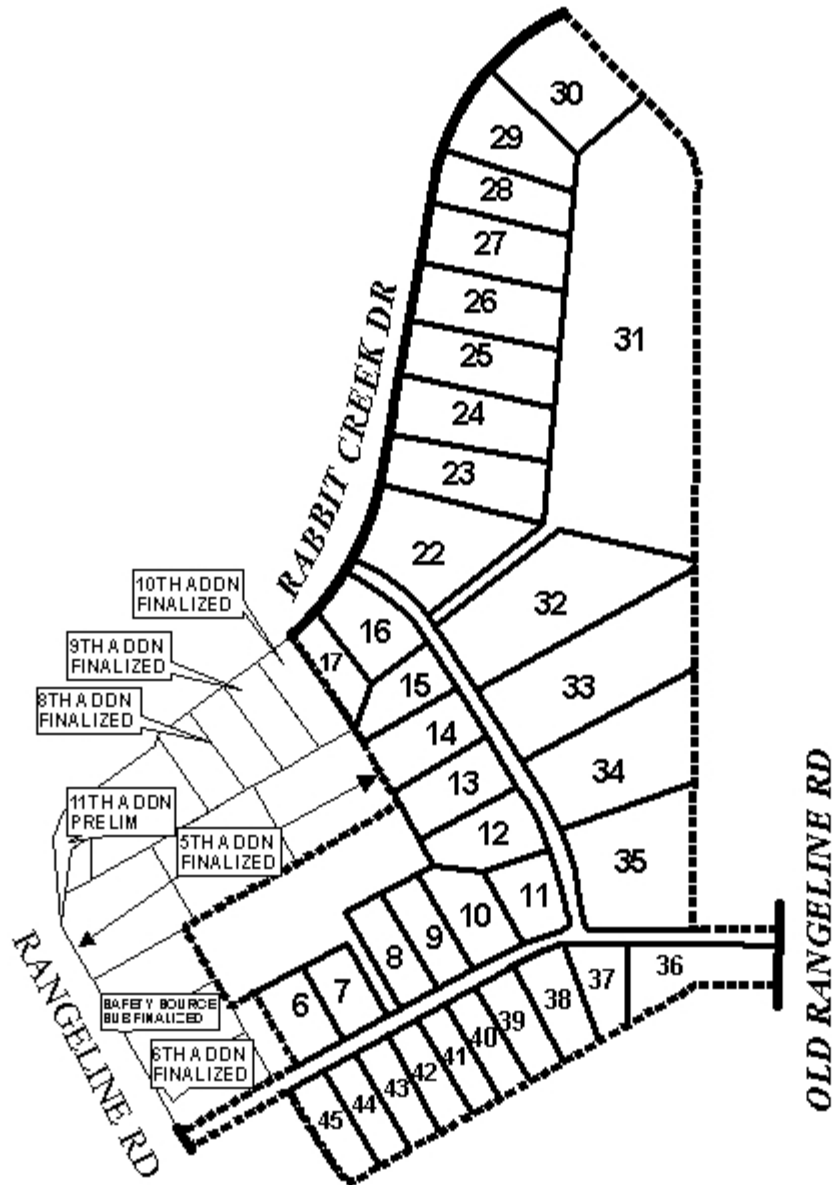

APPLICATION NUMBER Extension DATE August 19, 2004

APPLICANT Rangeline Park Subdivision

REQUEST Subdivision



NTS