

EXTENSION

WESTCHESTER PLACE SUBDIVISION, THIRD ADDITION

This is a request for a one-year extension of a previously approved 8-lot subdivision. The subdivision is located on the East side of Pebble Creek Drive, 200'± North of Westchester Lane.

There have been three extensions since the subdivision was originally approved in 2000. There have been no changes in conditions in the surrounding area that would affect the subdivision as previously approved; nor have there been changes to the Regulations that would affect the previous approval.

It should be noted that when the previous (third) extension was approved, the applicant was informed that a fourth extension would be unlikely. However, the applicant has submitted construction drawings to the County for approval and the lots have been staked out, thus indicating the applicant is moving forward with the development.

Based upon the preceding, it is recommended that this request for extension be approved.

LOCATOR MAP

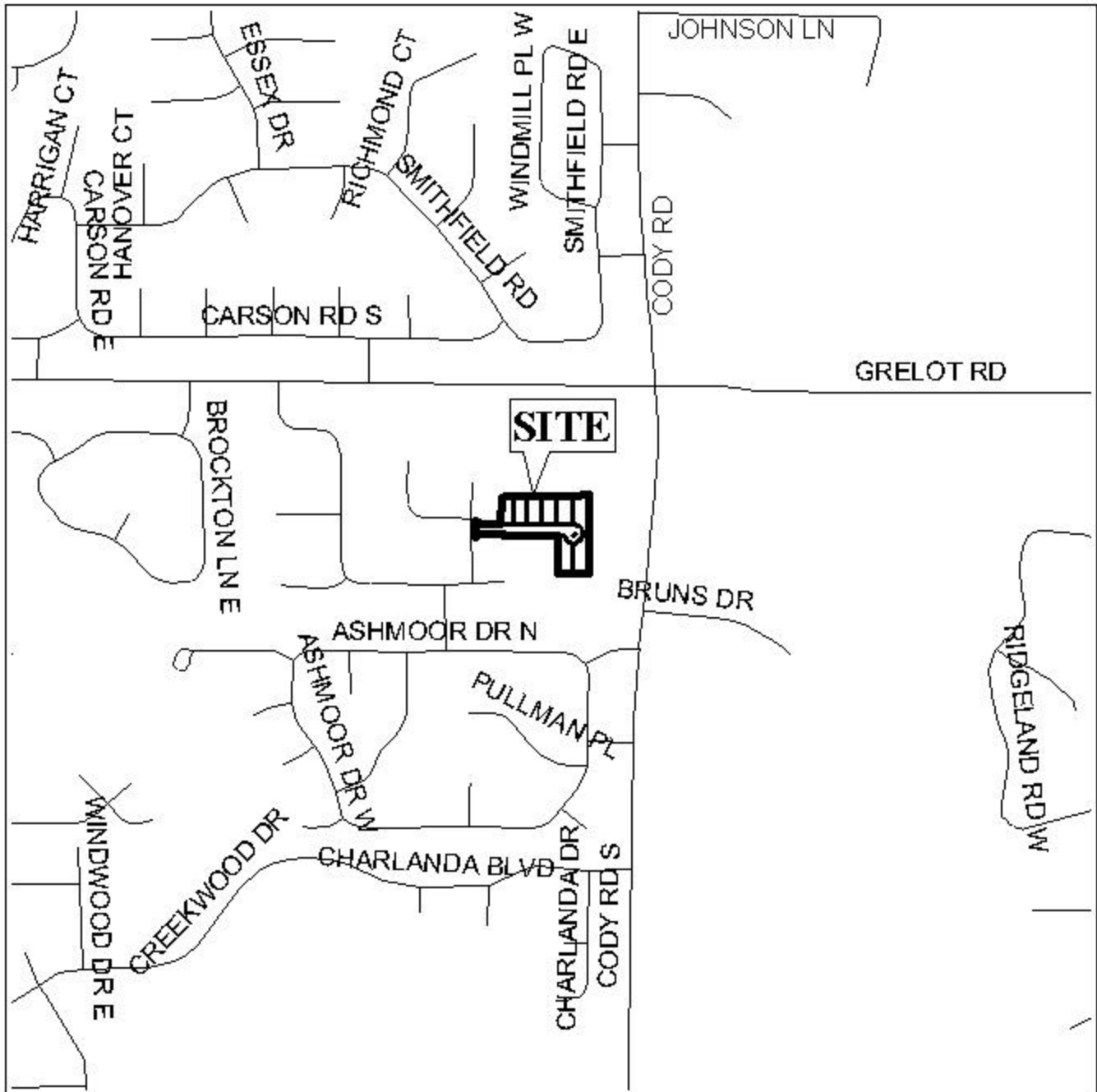

APPLICATION NUMBER Extension DATE February 5, 2004

APPLICANT Westchester Place Subdivision, Third Addition

REQUEST Subdivision



NTS

WESTCHESTER PLACE SUBDIVISION THIRD ADDITION

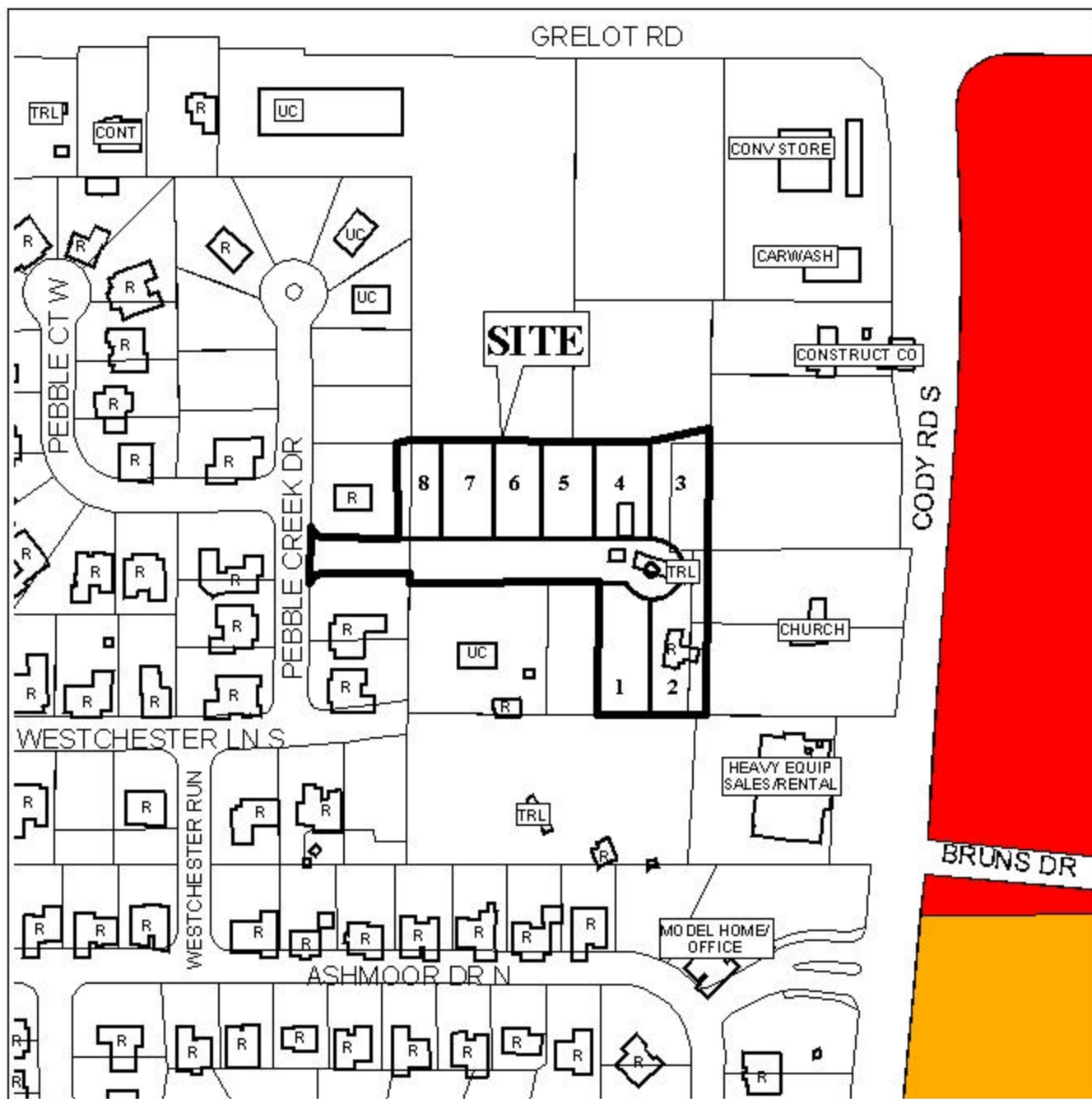

APPLICATION NUMBER Extension DATE February 5, 2004

LEGEND



NTS