

## **EXTENSION**

### **PLANNED UNIT DEVELOPMENT**

### **AND SUBDIVISION EXTENSION STAFF REPORT**

**Date: April 7, 2005**

#### **DEVELOPMENT NAME**

Sollie Road Development Subdivision

#### **SUBDIVISION NAME**

Sollie Road Development Subdivision

#### **LOCATION**

East side of Sollie Road, 400' North of the East terminus of Isle of Palms Drive, extending to the East terminus of Raleigh Boulevard

#### **REMARKS**

The applicant is requesting a one-year extension of a 152-lot, 70.3±-acre subdivision and a previously approved Planned Unit Development (PUD) to allow a single-family residential subdivision with alleyway access.

This is the first extension since the subdivision and PUD were originally approved in 2004, and no units have been recorded. There have been no changes in conditions in the surrounding area that would affect the subdivision and PUD as previously approved, nor have there been changes to the Regulations or Ordinance that would affect the previous approvals.

#### **RECOMMENDATION**

Based on the preceding, it is recommended that these requests for extension be approved.

## LOCATOR MAP

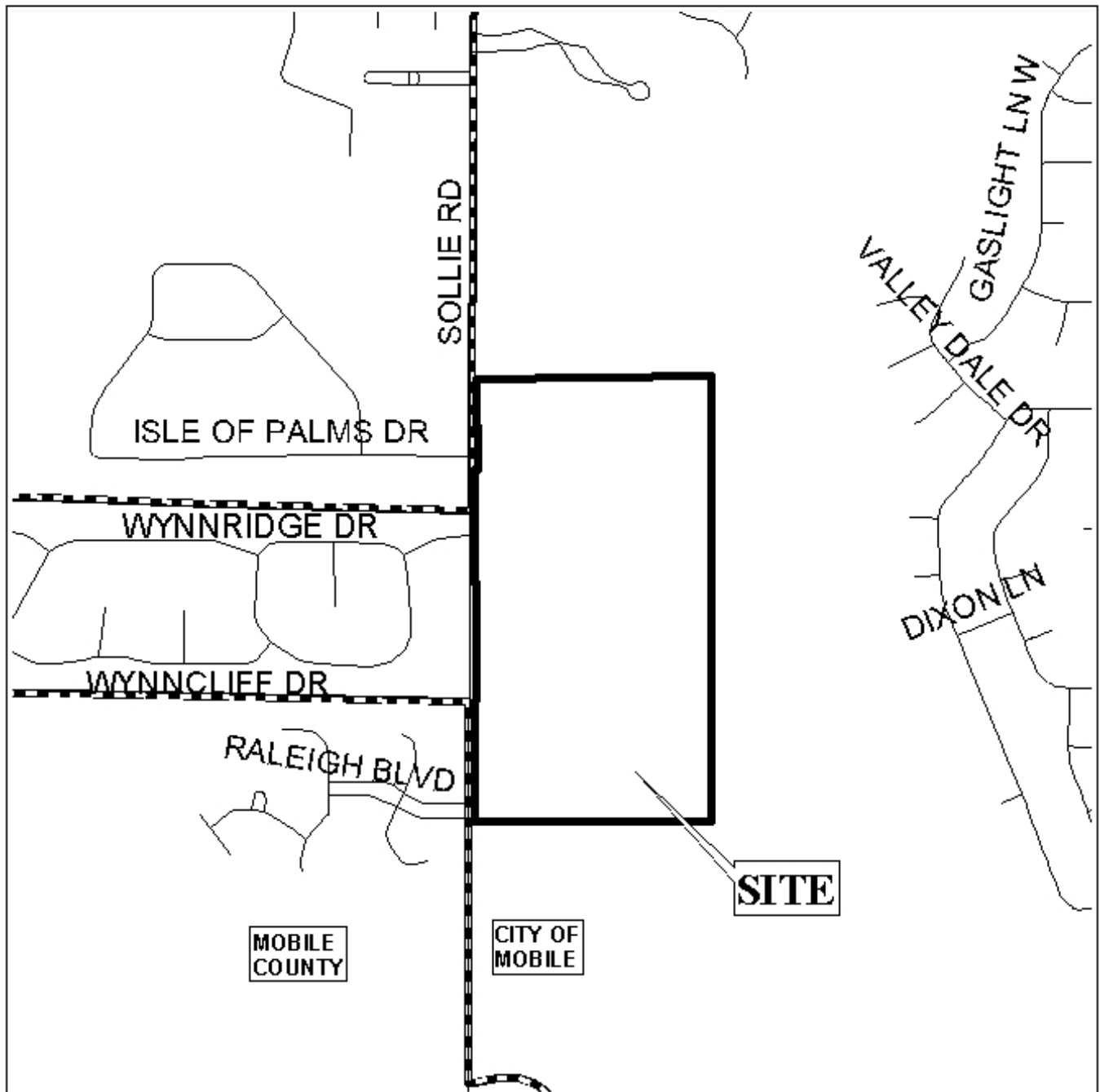

APPLICATION NUMBER Extension DATE April 7, 2005  
APPLICANT Sollie Road Development Subdivision  
REQUEST Planned Unit Development, Subdivision

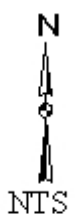

# PLANNING COMMISSION VICINITY MAP - EXISTING ZONING

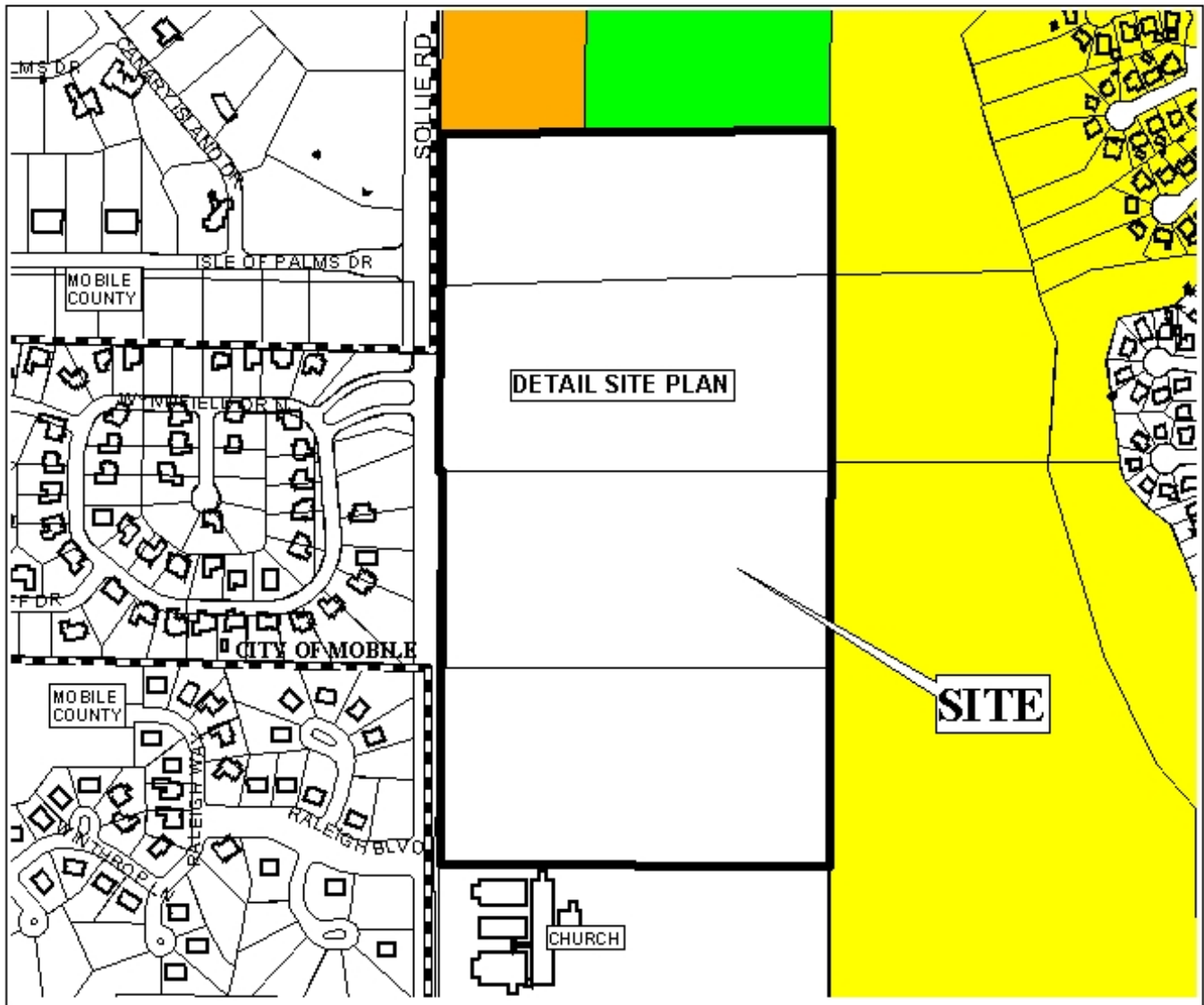

The site is surrounded by single family residential dwellings,  
with a church located to the South.

APPLICATION NUMBER Extension DATE April 7, 2005

APPLICANT Sollie Road Development Subdivision

REQUEST Planned Unit Development, Subdivision

LEGEND

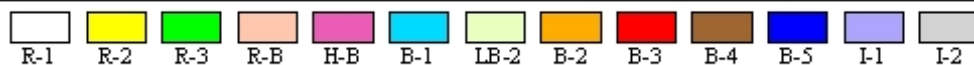

## SITE PLAN

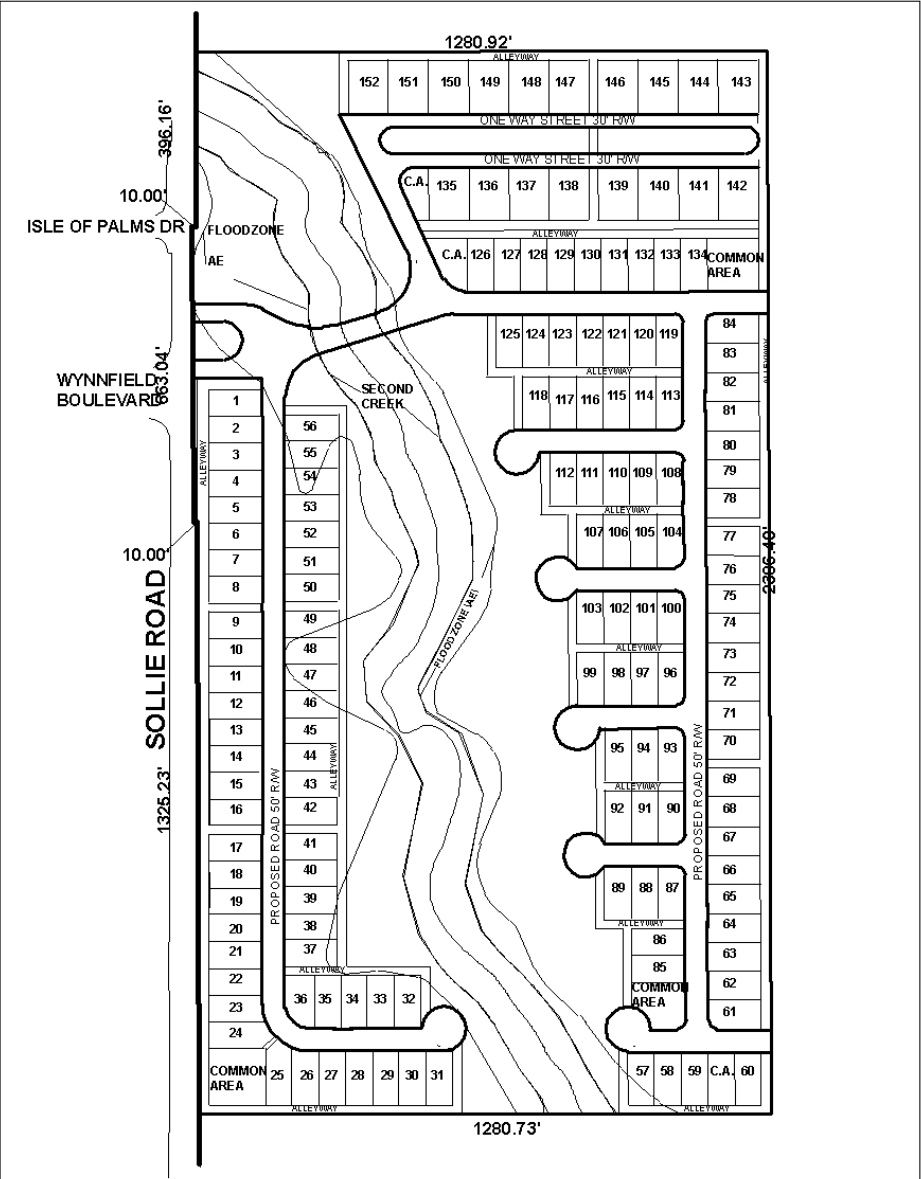

The site is located on the East side of Sollie Road, 400' North of the East terminus of Isle of Palms Drive, extending to the East terminus of Raleigh Boulevard.  
The plan illustrates the subdivision layout.

NTS