

**PLANNED UNIT DEVELOPMENT EXTENSION
STAFF REPORT****Date: September 7, 2006**

DEVELOPMENT NAME

Richard A. Russell

SUBDIVISION NAME

Russell, LLC

LOCATION4450 Halls Mill Road
(North side of Halls Mill Road, 2/10 mile \pm West of Riviere
du Chien Road)**REMARKS**

This is a request for a one-year extension of a previously approved Planned Unit Development. The PUD site is located at the North side of Halls Mill Road, 2/10 mile \pm West of Riviere du Chien Road.

There have been no extensions since the PUD was originally approved. There have been no changes in conditions in the surrounding area that would affect the PUD as previously approved; nor have there been changes to the Regulations that would affect the previous approval.

RECOMMENDATION

Based on the preceding, it is recommended that this request for extension be approved.

LOCATOR MAP



APPLICATION NUMBER Extension DATE September 7, 2006

APPLICANT Russell LLC Subdivision

REQUEST Planned Unit Development



PLANNING COMMISSION VICINITY MAP - EXISTING ZONING

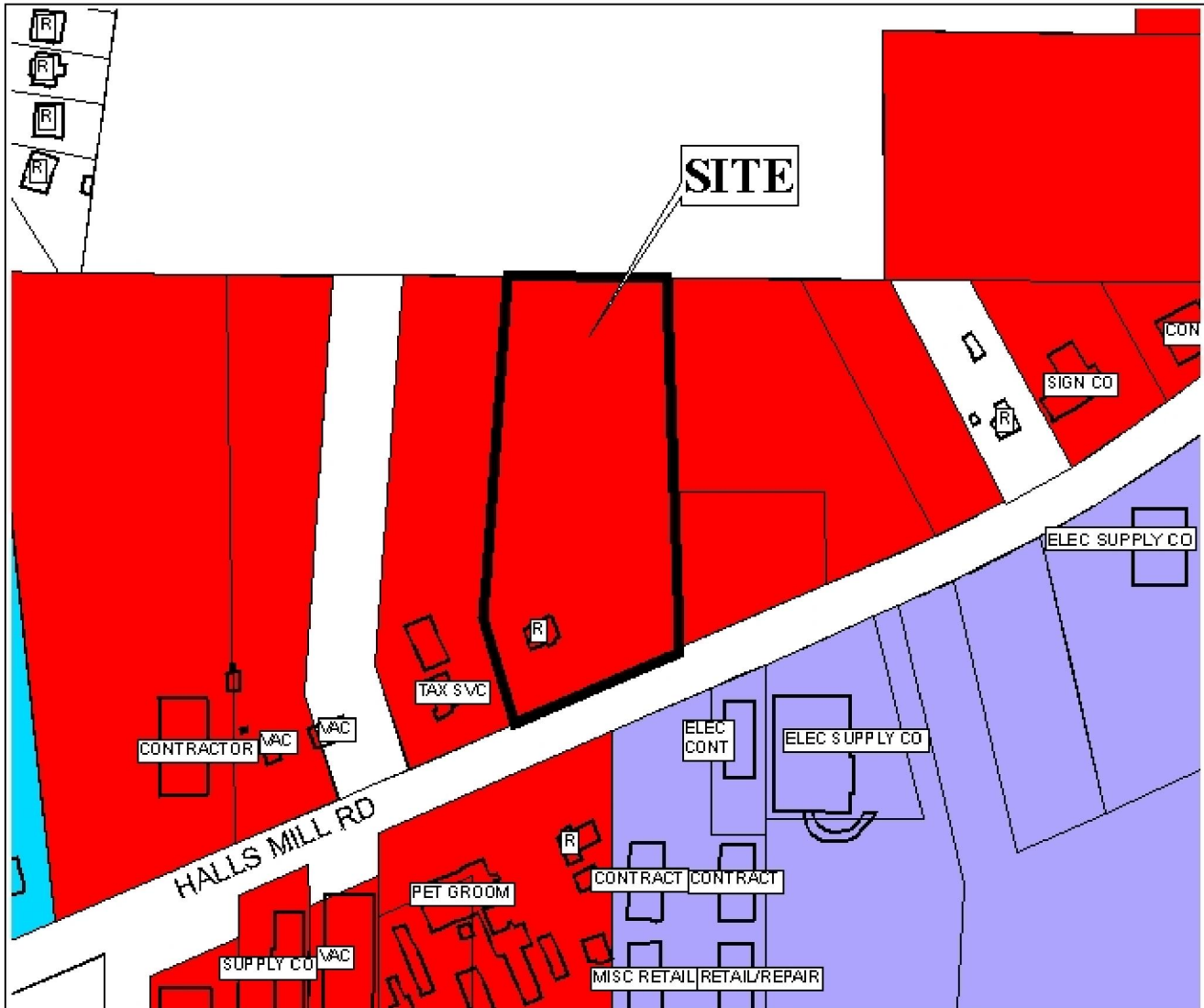

Located to the North and East of the site is vacant property. Located to the South and West of the site are miscellaneous businesses and single family residential dwellings.

APPLICATION NUMBER Extension DATE September 7, 2006

APPLICANT Russell LLC Subdivision

REQUEST Planned Unit Development

LEGEND

R-1	R-2	R-3	R-A	R-B	H-B	B-1	LB-2	B-2	B-3	B-4	B-5	I-1	I-2
-----	-----	-----	-----	-----	-----	-----	------	-----	-----	-----	-----	-----	-----

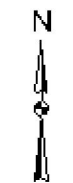

NTS

SITE PLAN

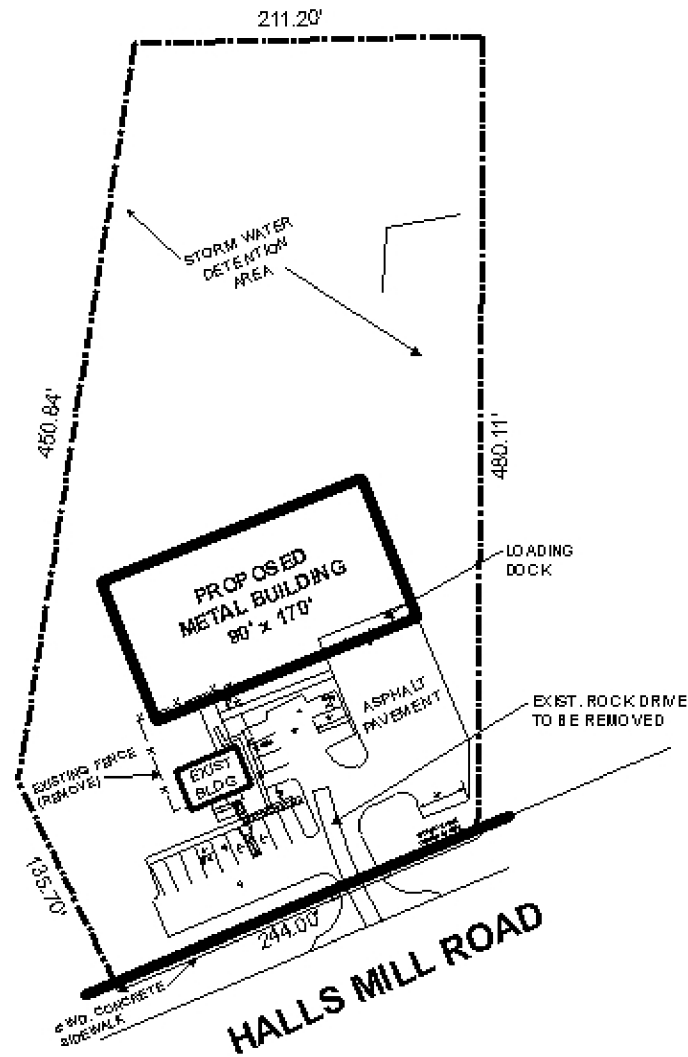

The site is located on the North side of Halls Mill Road, 2/10 mile West of Riviere du Chien Road. The plan illustrates the existing structure and parking, along with the proposed building.

APPLICATION NUMBER Extension DATE September 7, 2006
APPLICANT Russell LLC Subdivision
REQUEST Planned Unit Development

