

EXTENSION

RANGELINE ROAD COMMERCIAL AND INDUSTRIAL PARK SUBDIVISION, REVISED PRELIMINARY PLAT FOR

This is a request for a one-year extension of a previously approved 3-lot subdivision. The subdivision is located on the East side of Rangeline Road, 880'± North of Old Rangeline Road, extending Northeastwardly to the West side of Old Rangeline Road, 770'± South of the West terminus of Riverview Pointe Drive.

This is the second extension since the subdivision was originally approved in 2001. There have been no changes in conditions in the surrounding area that would affect the subdivision as previously approved; nor have there been changes to the Regulations that would affect the previous approval. As there is no road construction proposed for this extension, the applicant should be advised that a third extension is unlikely.

Based upon the preceding, it is recommended that this request for extension be approved and that the applicant be advised that a third extension is unlikely.

LOCATOR MAP

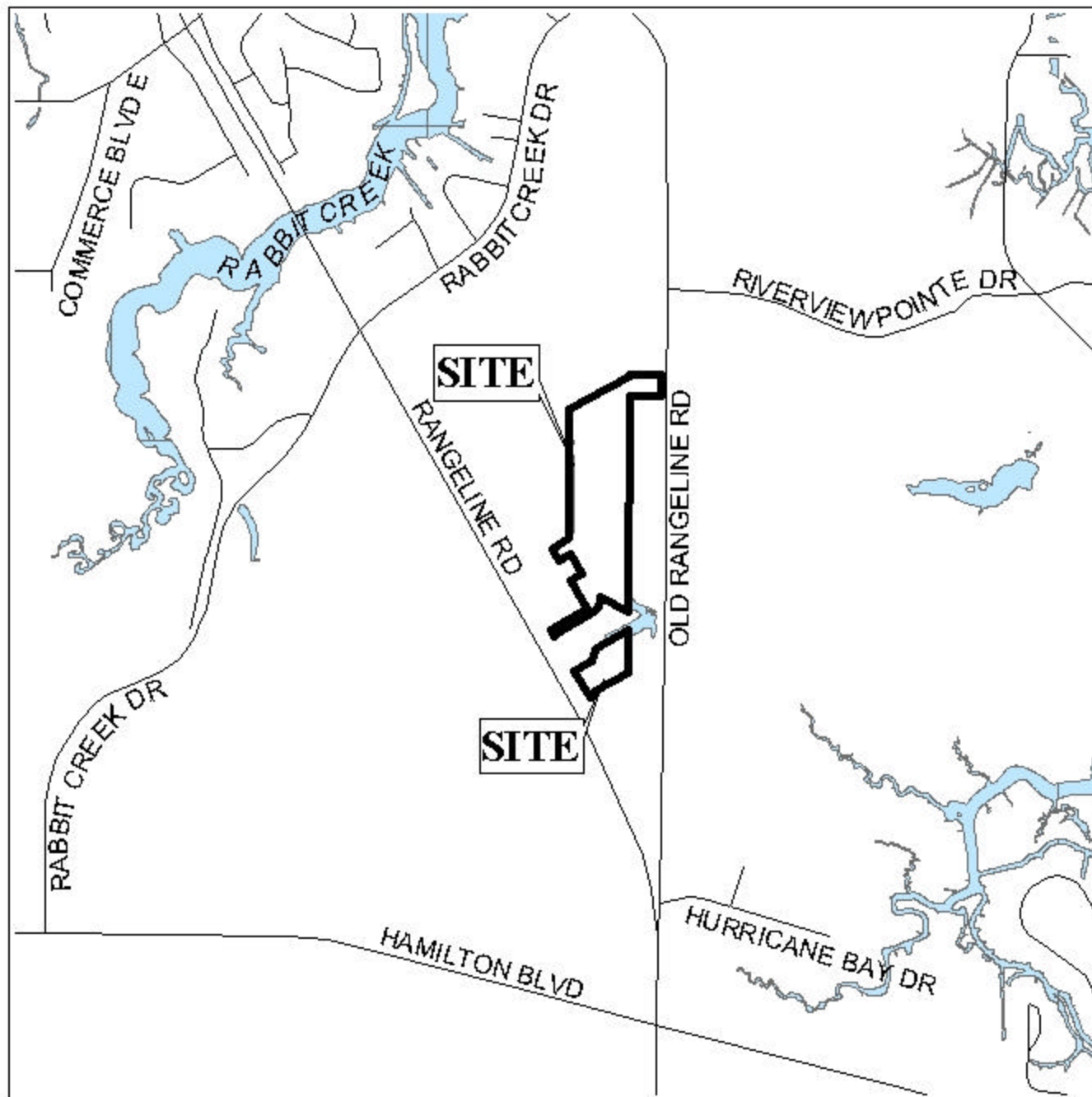

APPLICATION NUMBER Extension DATE April 17, 2003

APPLICANT Rangeline Road Commercial and Industrial Park Subdivision, Revised Preliminary Plat for

REQUEST Subdivision



RANGELINE ROAD COMMERCIAL AND INDUSTRIAL PARK SUBDIVISION, REVISED PRELIMINARY PLAT FOR

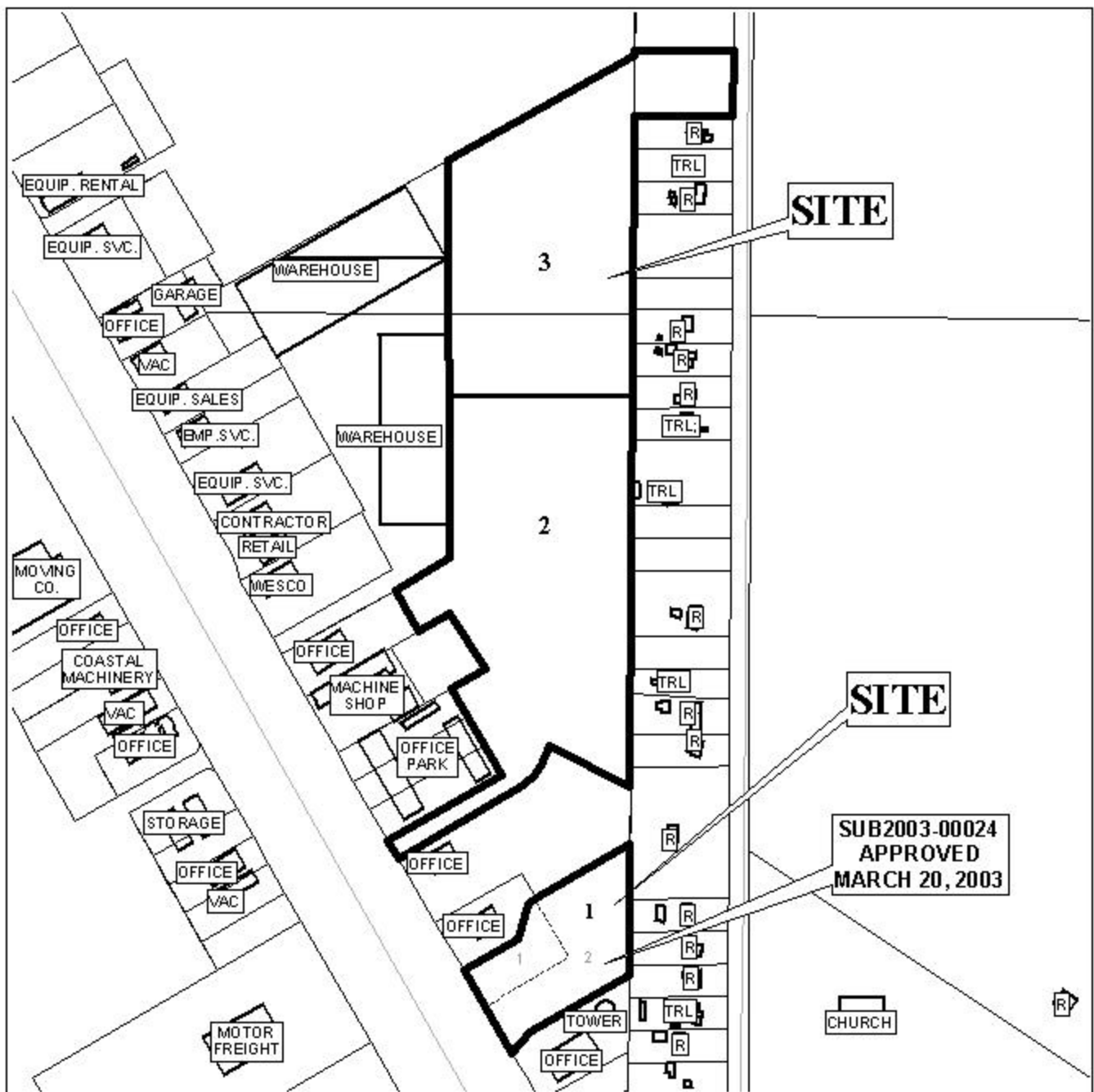

APPLICATION NUMBER Extension DATE April 17, 2003

LEGEND

