

EXTENSION

RANGELINE PARK SUBDIVISION

This is a request for a one-year extension of a previously approved 45-lot subdivision. The subdivision is located on the Southeast corner of Rangeline Road and Rabbit Creek Drive and extending through to Old Rangeline Road.

The subdivision was originally approved in September 1996. Since that time there have been five units recorded (6th Addition Phase II in 1996, 7th Addition in 1998, 8th Addition in 1999, 9th and 10th Additions in 2001) and four extensions. There have been no changes in conditions in the surrounding area that would affect the subdivision as previously approved; nor have there been changes to the Regulations that would affect the previous approval.

Based upon the preceding, it is recommended that this request for extension be approved.

LOCATOR MAP

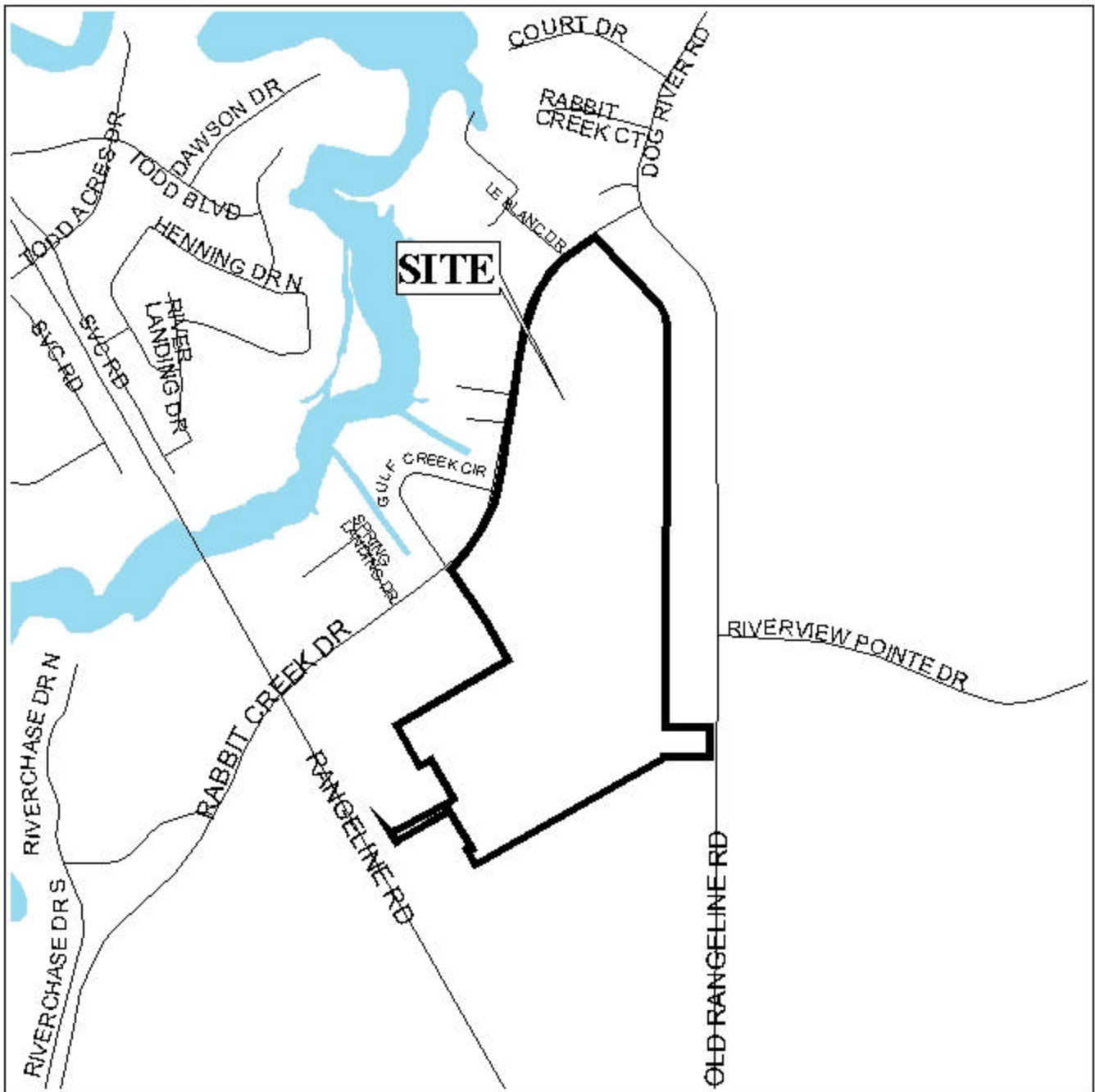

APPLICATION NUMBER _____ Extension DATE _____ August 21, 2003 _____

APPLICANT _____ Rangeline Park Subdivision _____

REQUEST _____ Subdivision _____



NTS

RANGELINE PARK SUBDIVISION

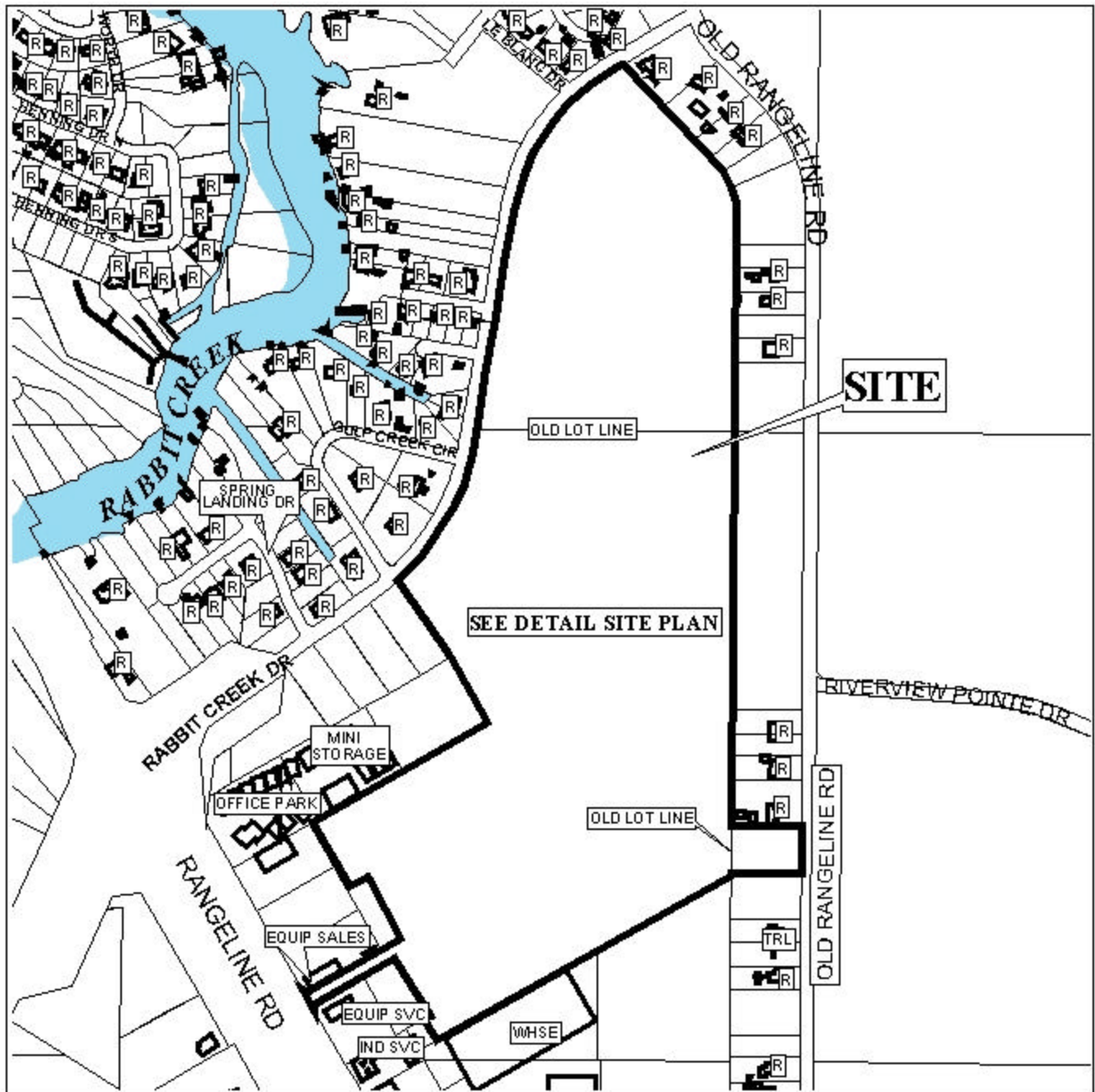

APPLICATION NUMBER Extension DATE August 21, 2003

LEGEND



NTS



DETAIL SITE PLAN

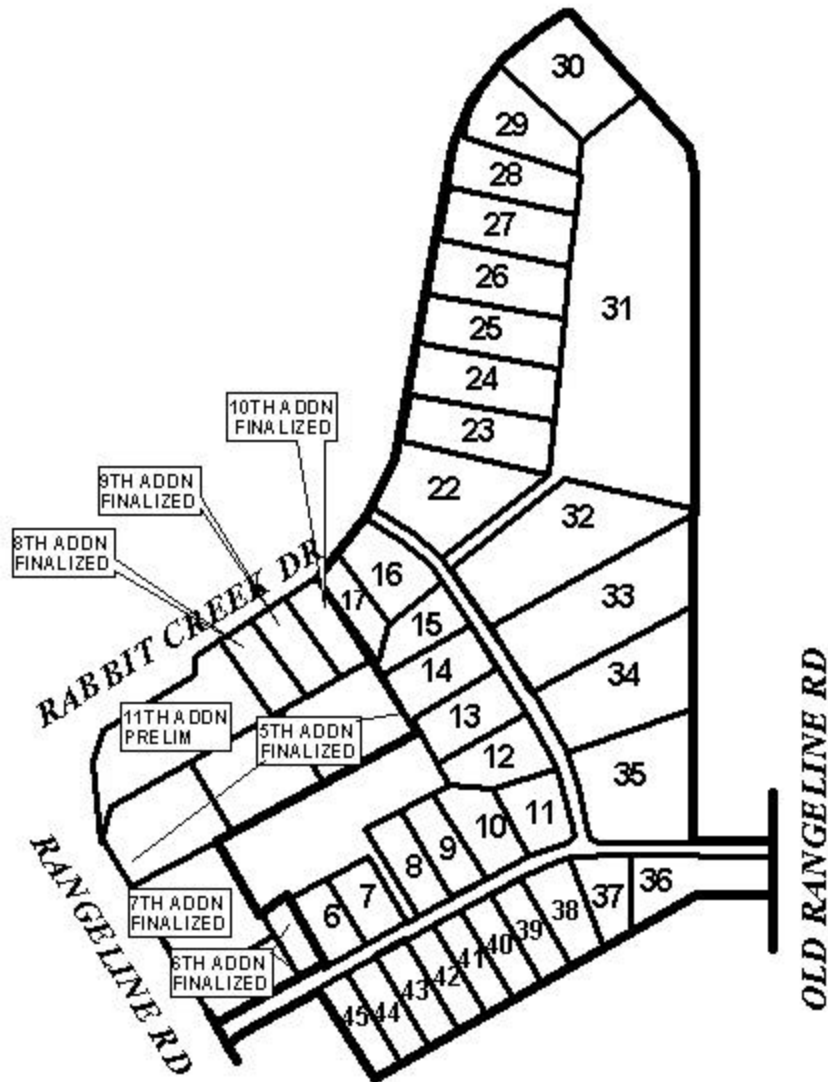

APPLICATION NUMBER Extension DATE August 21, 2003

APPLICANT Rangeline Park Subdivision

REQUEST Subdivision

