

EXTENSION

RALEIGH SUBDIVISION

This is a request for a one-year extension of a previously approved 165-lot subdivision. The subdivision is located on the West side of Cody Road, 870'+ south of Wynnfield Boulevard, and extending to the East terminus of Longview Drive.

There have been four extensions since the subdivision was originally approved in 1999 and three units have been recorded. There have been no changes in conditions in the surrounding area that would affect the subdivision as previously approved; nor have there been changes to the Regulations that would affect the previous approval.

Based on the preceding, it is recommended that this request for extension be approved, however, a fifth extension is unlikely.

LOCATOR MAP

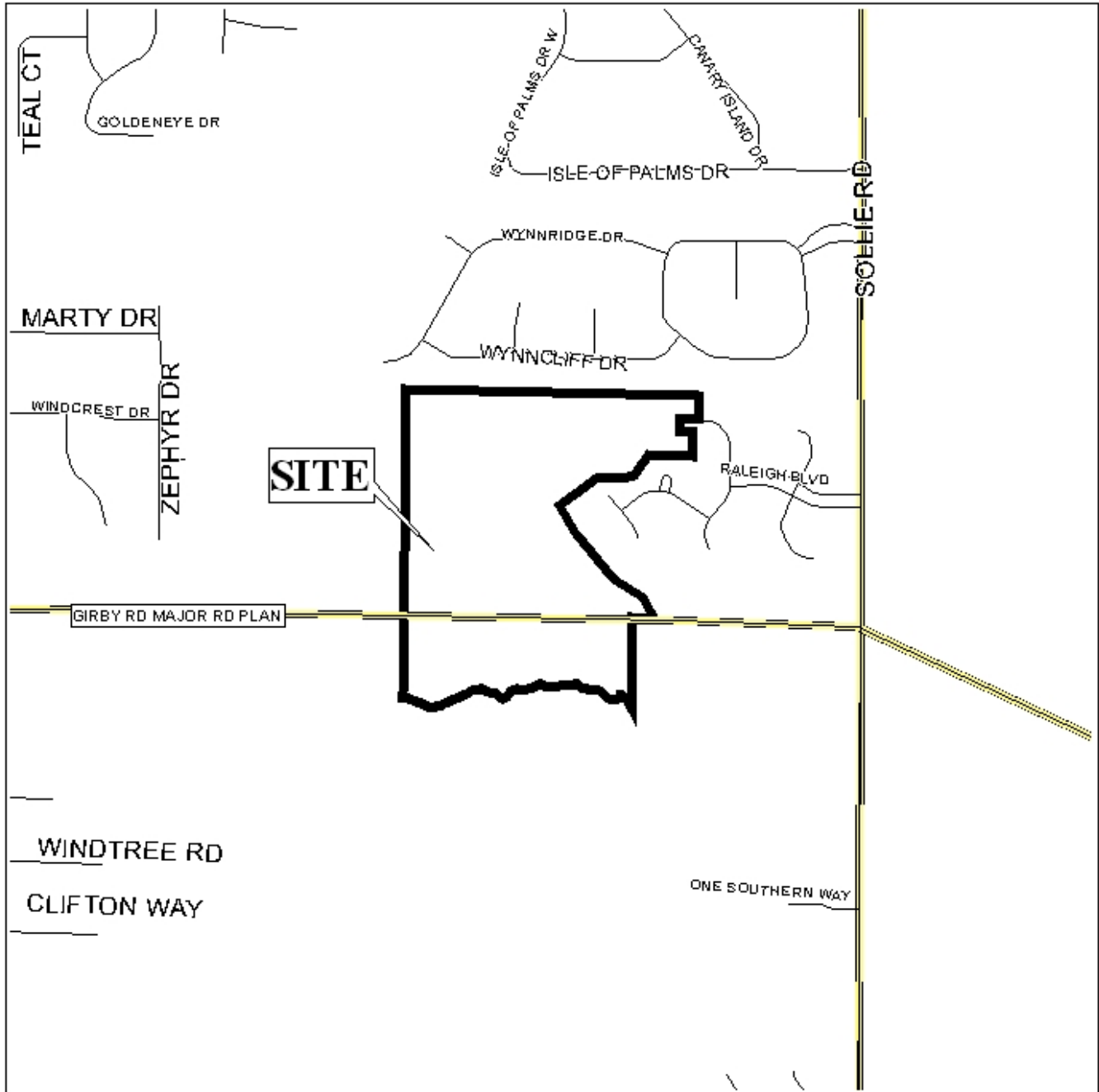

APPLICATION NUMBER Extension DATE November 3, 2005

APPLICANT Raleigh Subdivision

REQUEST Subdivision



NTS

RALEIGH SUBDIVISION

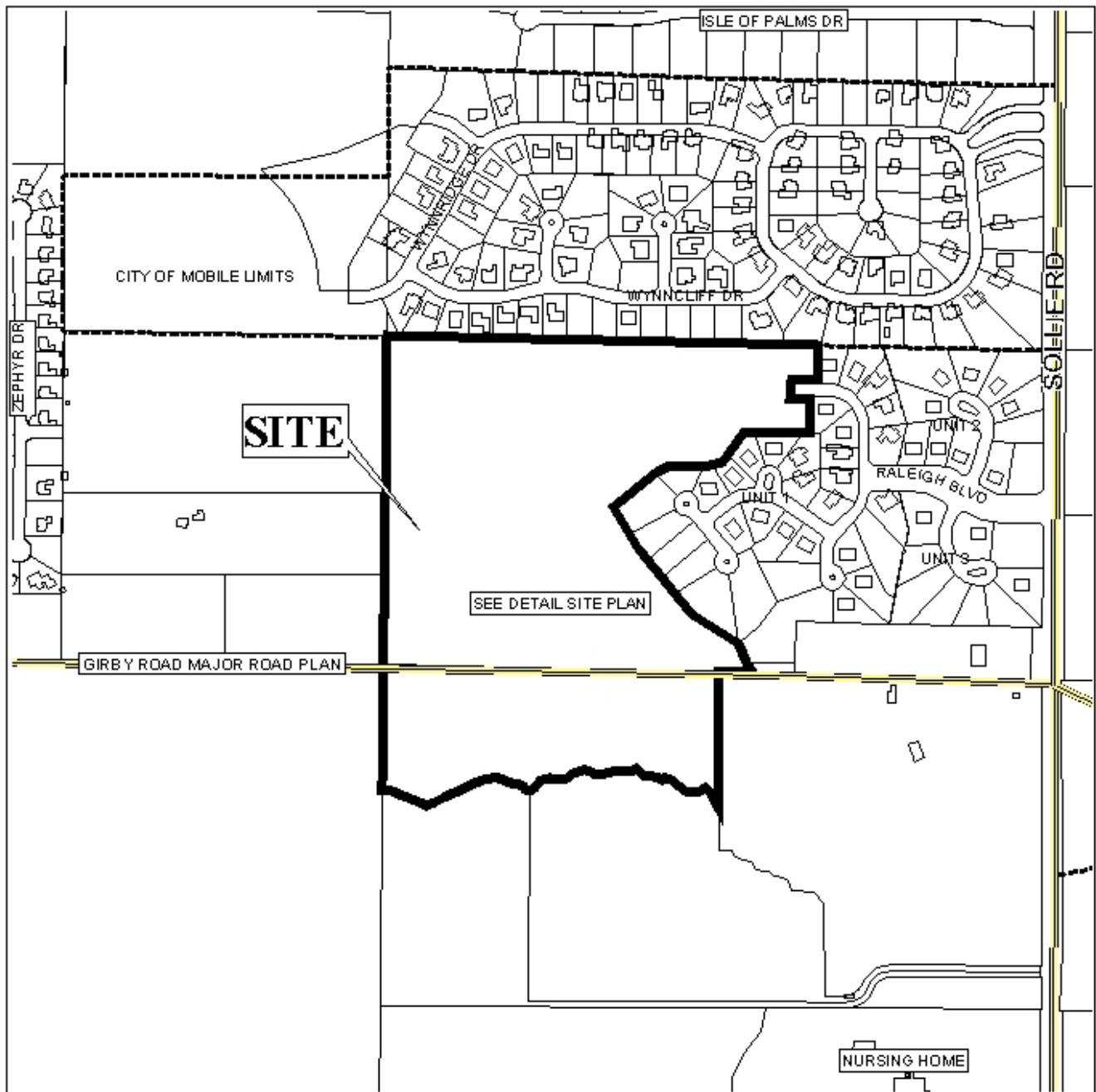

APPLICATION NUMBER Extension DATE November 3, 2005

LEGEND

R-1	R-2	R-3	R-A	R-B	H-B	B-1	LB-2	B-2	B-3	B-4	B-5	I-1	I-2



NTS

DETAIL SITE PLAN

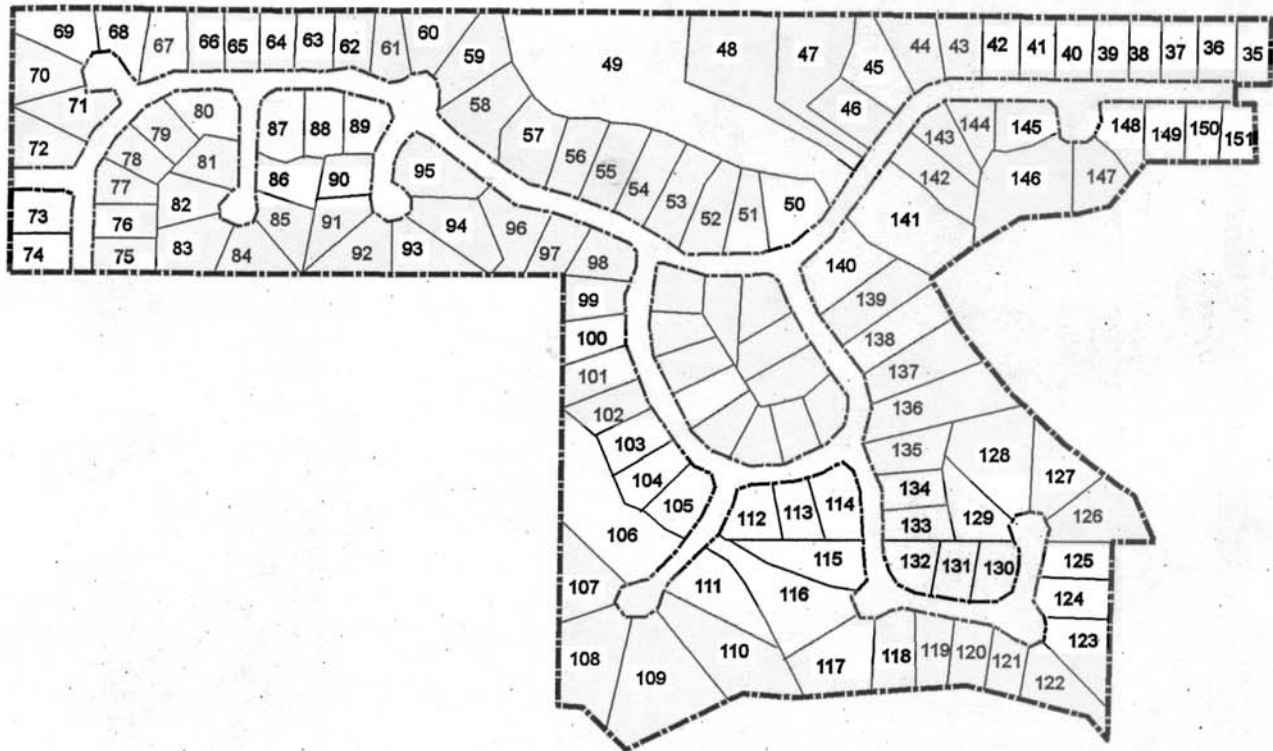

APPLICATION NUMBER Extension DATE November 3, 2005
APPLICANT Raleigh Subdivision
REQUEST Subdivision



NTS