

EXTENSION

RICHMOND SUBDIVISION

This is a request for a one-year extension of a previously approved 136-lot subdivision. The subdivision is located on the North side of Johnson Road at the North terminus of Scott Dairy Loop Road West.

This is the third extension since the subdivision was originally approved in 2000 with two units being recorded. There have been no changes in conditions in the surrounding area that would affect the subdivision as previously approved; nor have there been changes to the Regulations that would affect the previous approval. As illustrated on the Vicinity Map, the roadways to the North are under construction and two units (to the South) have been recorded.

Based upon the preceding, it is recommended that this request for extension be approved.

LOCATOR MAP

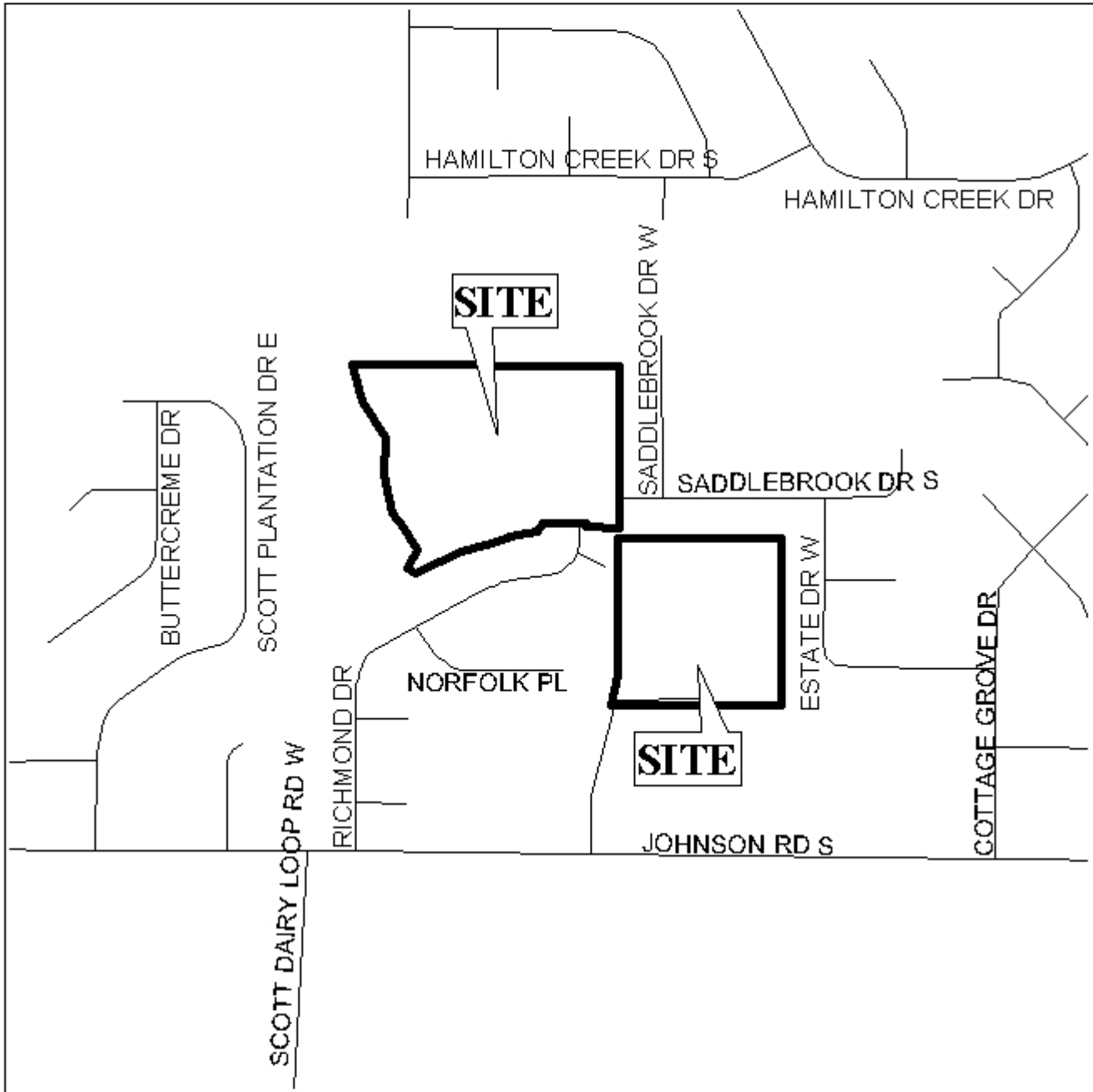

APPLICATION NUMBER Extension DATE May 6, 2004

APPLICANT Richmond Subdivision

REQUEST Subdivision



NTS

RICHMOND SUBDIVISION

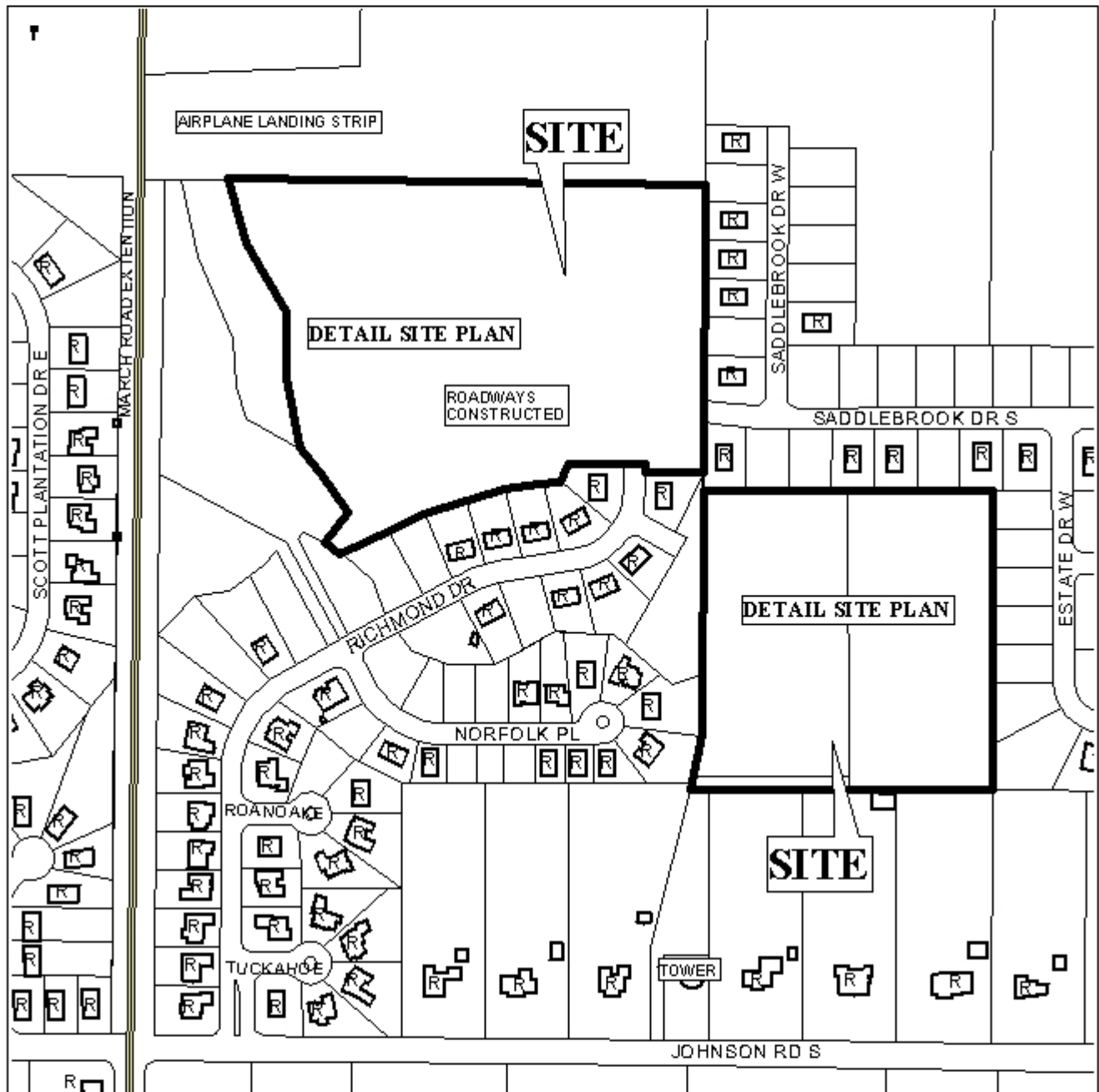

APPLICATION NUMBER Extension DATE May 6, 2004

LEGEND

R-1	R-2	R-3	R-A	R-B	H-B	B-1	LB-2	B-2	B-3	B-4	B-5	I-1	I-2



NTS

SUBDIVISION PLAT

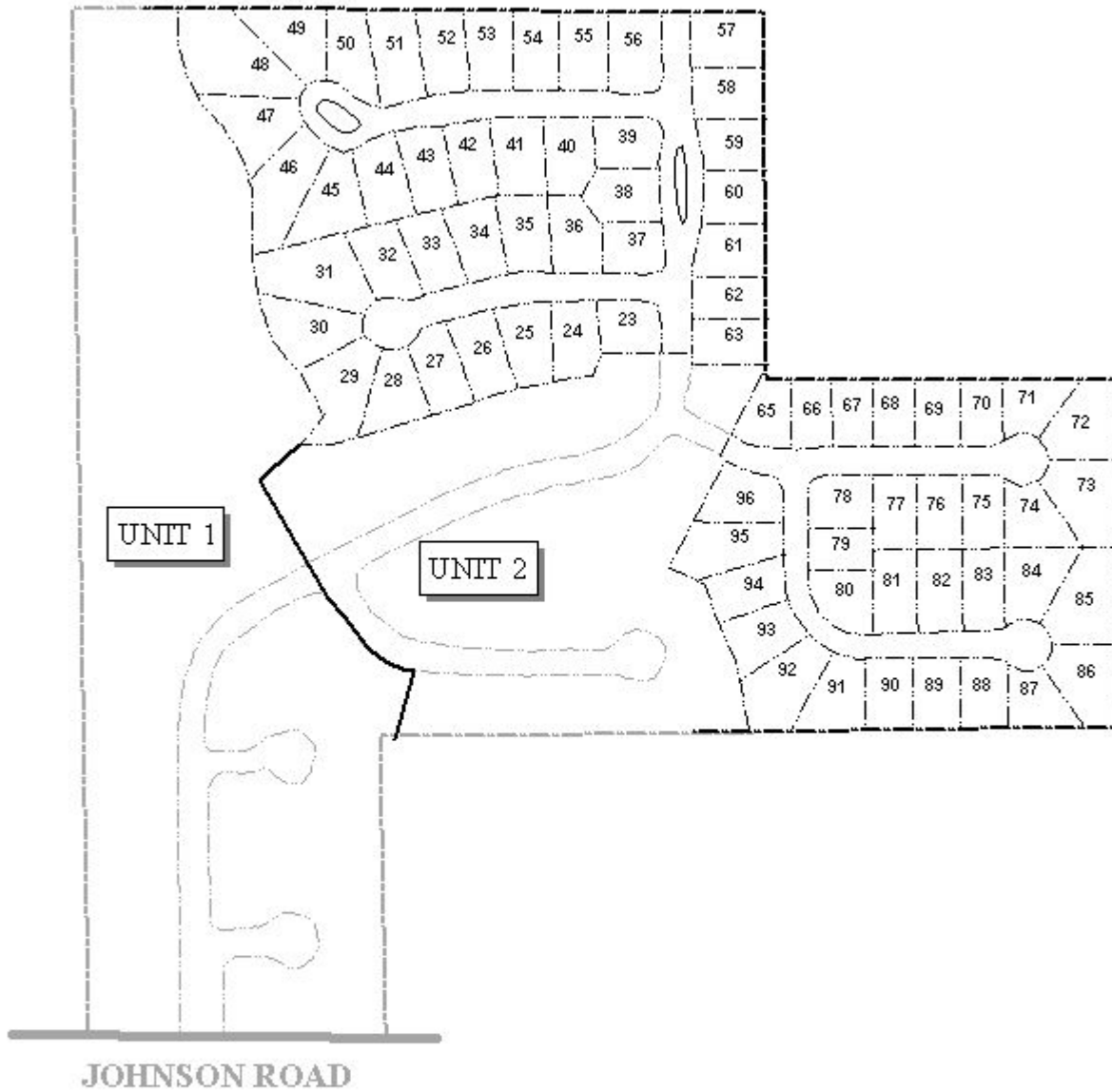

APPLICATION NUMBER Extension DATE May 6, 2004
APPLICANT Richmond Subdivision
USE/REQUEST Subdivision

