

# **EXTENSION**

## **RALEIGH SUBDIVISION**

This is a request for a one-year extension of a previously approved 165-lot subdivision. The subdivision is located on the West side of Cody Road, 870'+ south of Wynnfield Boulevard, and extending to the East terminus of Longview Drive.

There have been three extensions since the subdivision was originally approved in 1999 and two unit units have been recorded. There have been no changes in conditions in the surrounding area that would affect the subdivision as previously approved; nor have there been changes to the Regulations that would affect the previous approval.

Based upon the preceding, it is recommended that this request for extension be approved.

## LOCATOR MAP

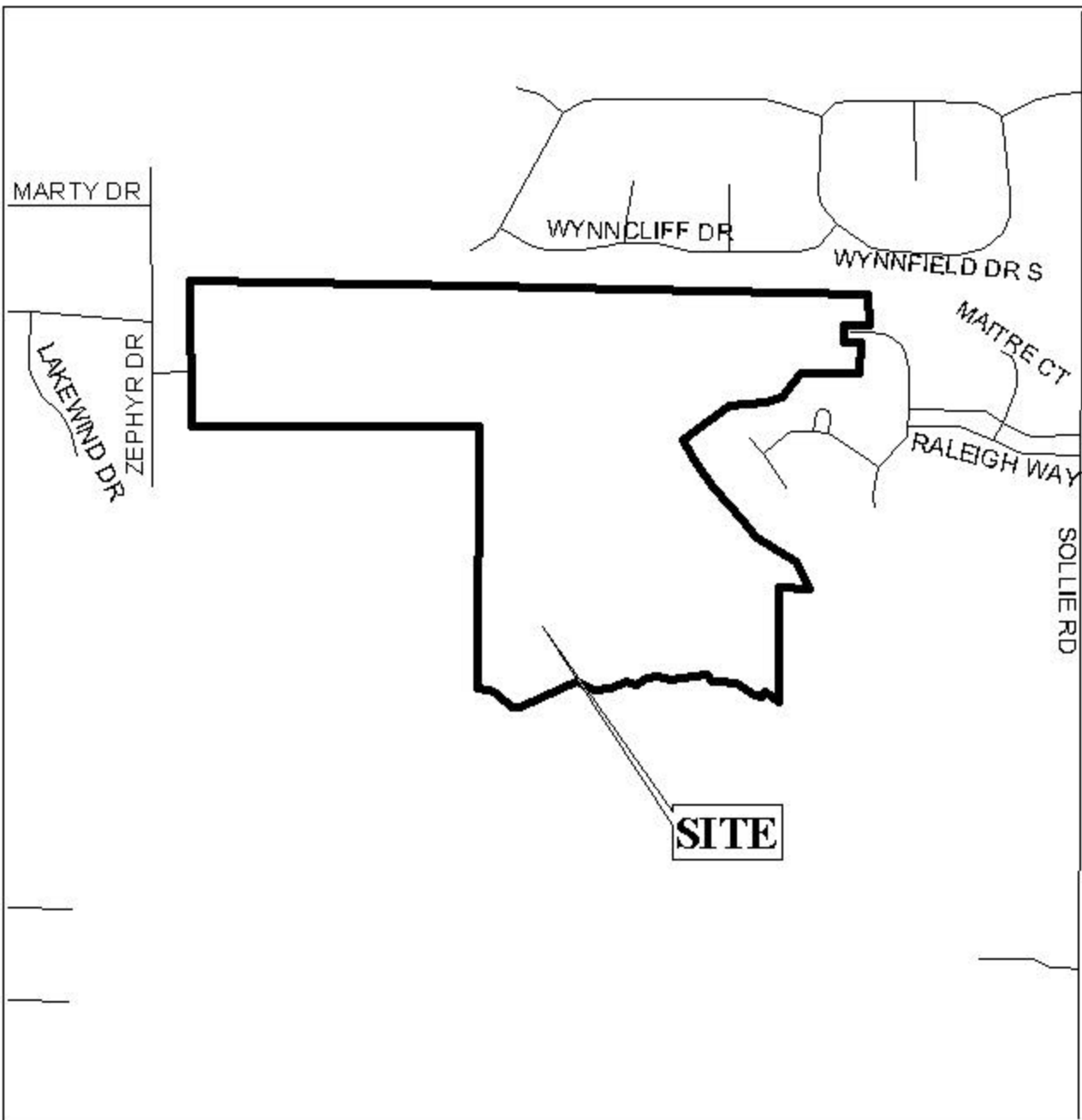

APPLICATION NUMBER Extension DATE November 6, 2003  
APPLICANT Raleigh Subdivision  
REQUEST Subdivision



NTS

# RALEIGH SUBDIVISION

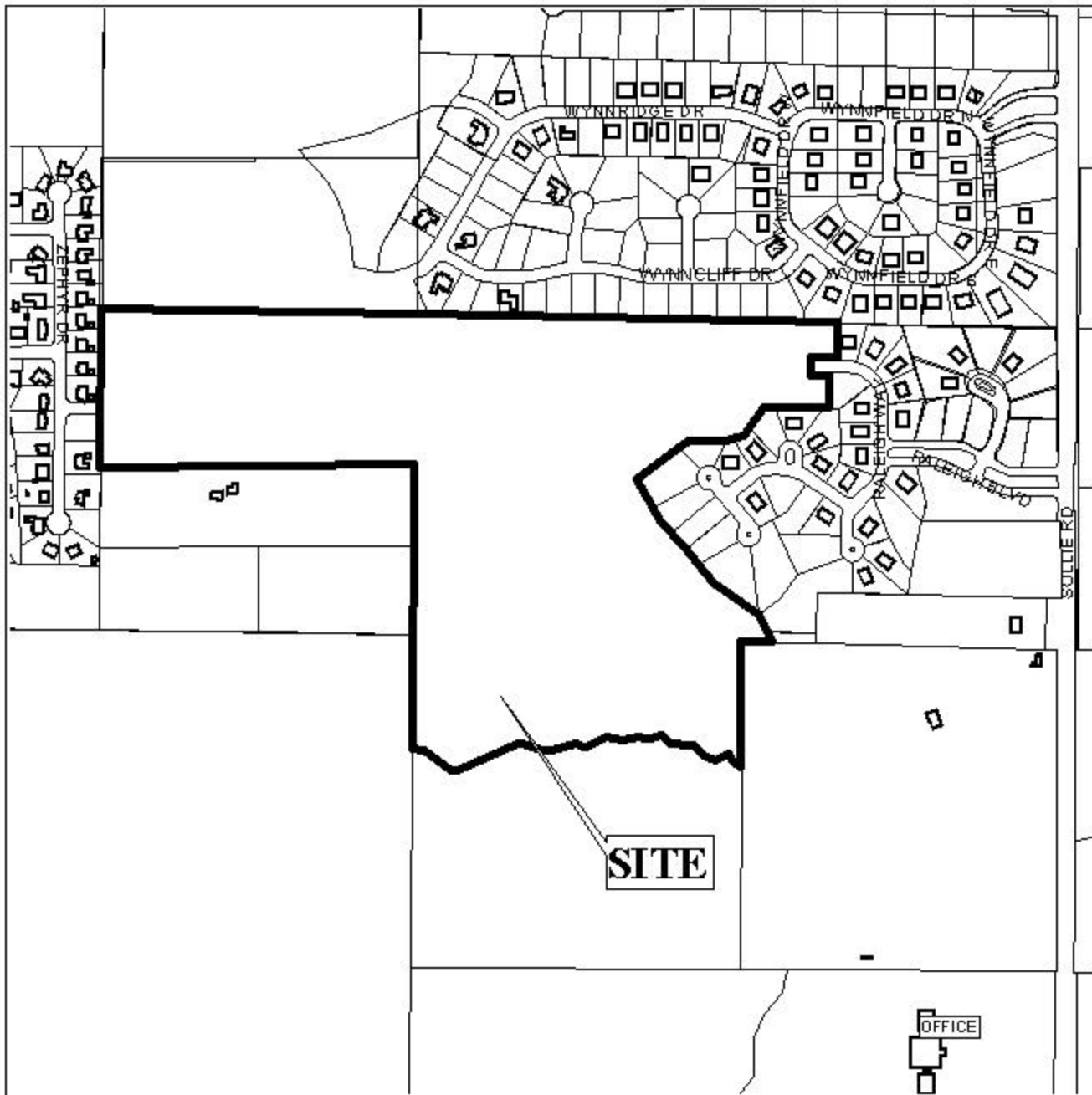

APPLICATION NUMBER Extension DATE November 6, 2003

LEGEND



NTS

## DETAIL SITE PLAN

This map illustrates the 150th Precinct, which contains 150 lots. The lots are numbered 1 through 150. The map shows a complex street network with several dead ends and a central area with a circular road. The lots are arranged in a grid-like pattern, with some areas being more densely packed than others. The map is oriented with North at the top.

23