

DIXON ESTATES SUBDIVISION,
UNIT ONE

This is a request for a one-year extension of a previously approved two-lot subdivision. The subdivision is located on the Northeast corner of Tuthill Lane and Stein Avenue.

This is the first request for an extension since the subdivision was originally approved in 2006. There have not been changes in conditions in the surrounding area that would affect the subdivision as previously approved, nor have there been changes to the regulations that would affect the previous approval.

It should be noted, however, that no road construction was required for this subdivision. The applicant should be advised that no additional extensions will be likely and recording of the final plat will be required.

Based on the preceding, it is recommended that this request for extension be approved and that the applicant be advised that future extensions will be unlikely.

LOCATOR MAP

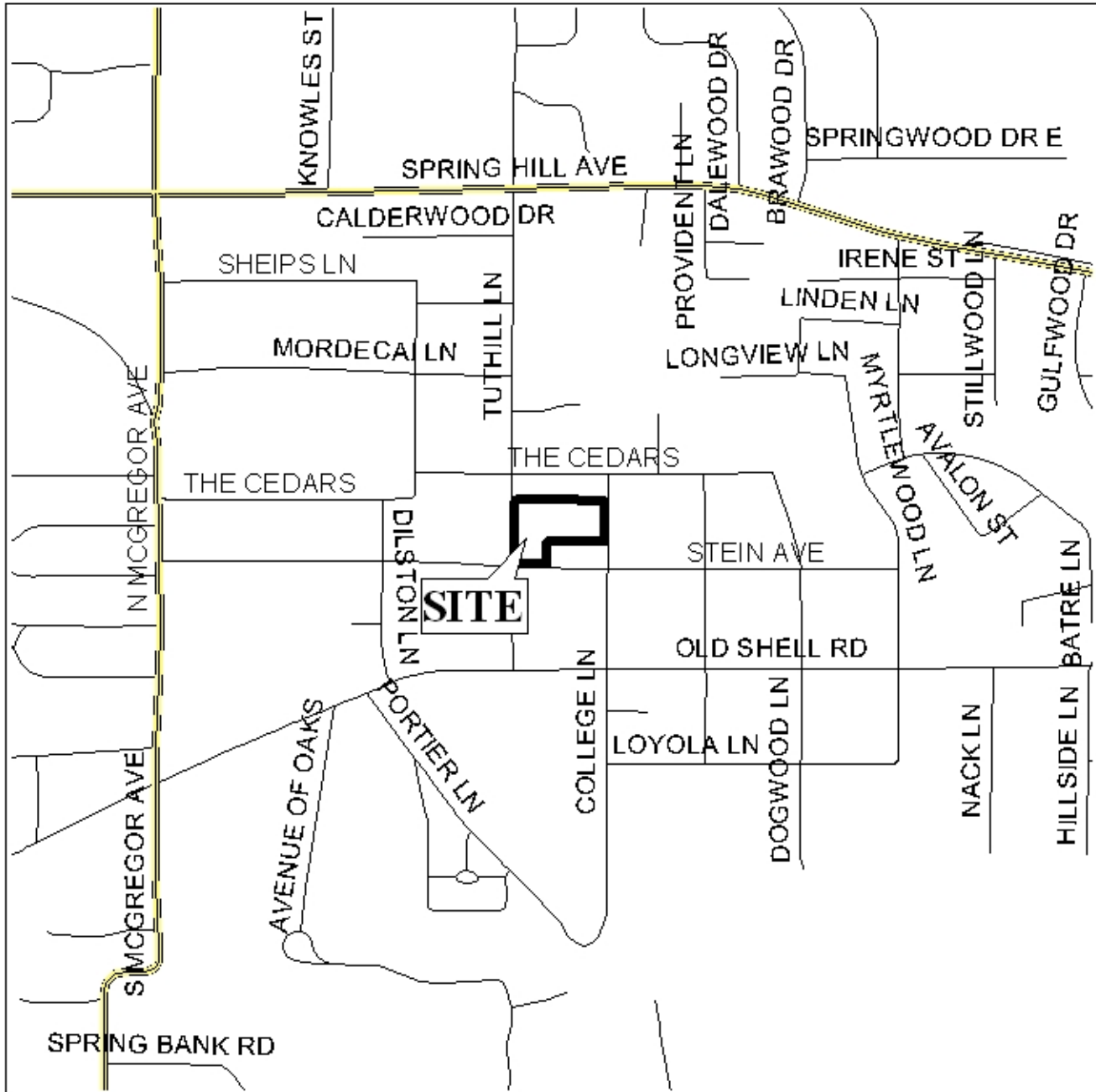

APPLICATION NUMBER Extension DATE March 15, 2007

APPLICANT Dixon Estates Subdivision, Unit One

REQUEST Subdivision

N



NTS

DIXON ESTATES SUBDIVISION, UNIT ONE

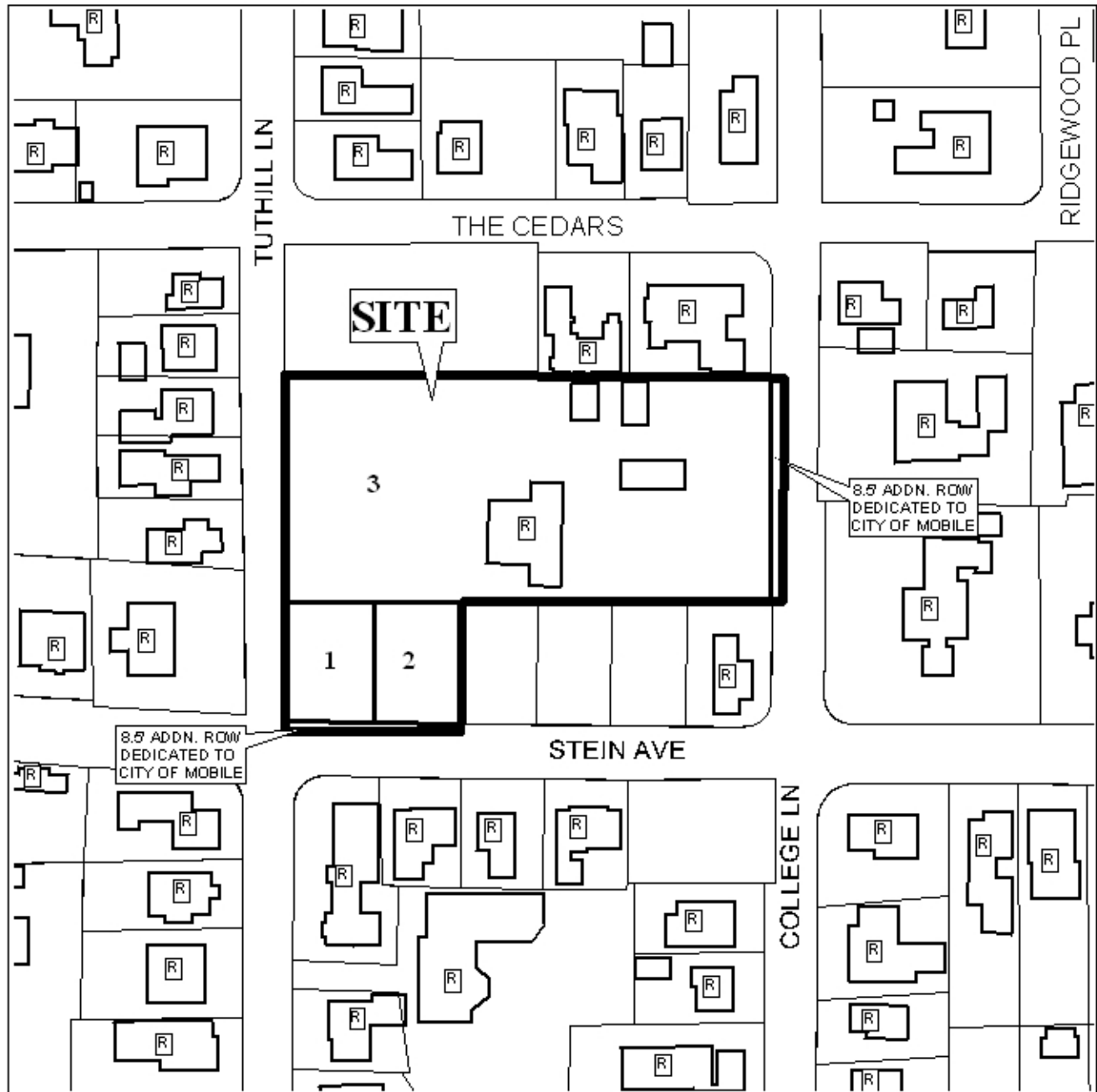

APPLICATION NUMBER Extension DATE March 15, 2007

LEGEND

R-1	R-2	R-3	R-A	R-B	H-B	B-1	LB-2	B-2	B-3	B-4	B-5	I-1	I-2
-----	-----	-----	-----	-----	-----	-----	------	-----	-----	-----	-----	-----	-----

N

NTS