

## **EXTENSION**

### **PLANNED UNIT DEVELOPMENT EXTENSION STAFF REPORT**

**Date: June 15, 2006**

#### **DEVELOPMENT NAME**

Country Club of Mobile  
(W. Kennon Drew, Agent)

#### **LOCATION**

4101 Wimbledon Drive West  
(South side of Wimbledon Drive West, 200'± West of  
Turnin Lane)

#### **PRESENT ZONING**

R-1, Single-Family Residential

#### **REMARKS**

The applicant is requesting a one-year extension of a previously approved Planned Unit Development (PUD) approval, which was granted in 2004. The PUD application joined a request for Planning Approval, which was required for expansion in an R-1 district, and is still valid.

Planned Unit Development review examines the site with regard to its location to ensure that it is generally compatible with neighboring uses; that adequate access is provided without generating excess traffic along minor residential streets in residential districts outside the PUD; and that natural features of the site are taken into consideration. PUD review also examines the design of the development to provide for adequate circulation within the development; to ensure adequate access for emergency vehicles; and to consider and provide for protection from adverse effects of adjacent properties as well as provide protection of adjacent properties from adverse effects from the PUD.

There has been one extension since the PUD was originally approved. There has been no change in conditions within the surrounding area that would affect the approval as previously approved; nor have there been changes to the regulations that would affect the previous approval.

#### **RECOMMENDATION**

Based on the preceding, it is recommended that this application be approved.

## LOCATOR MAP

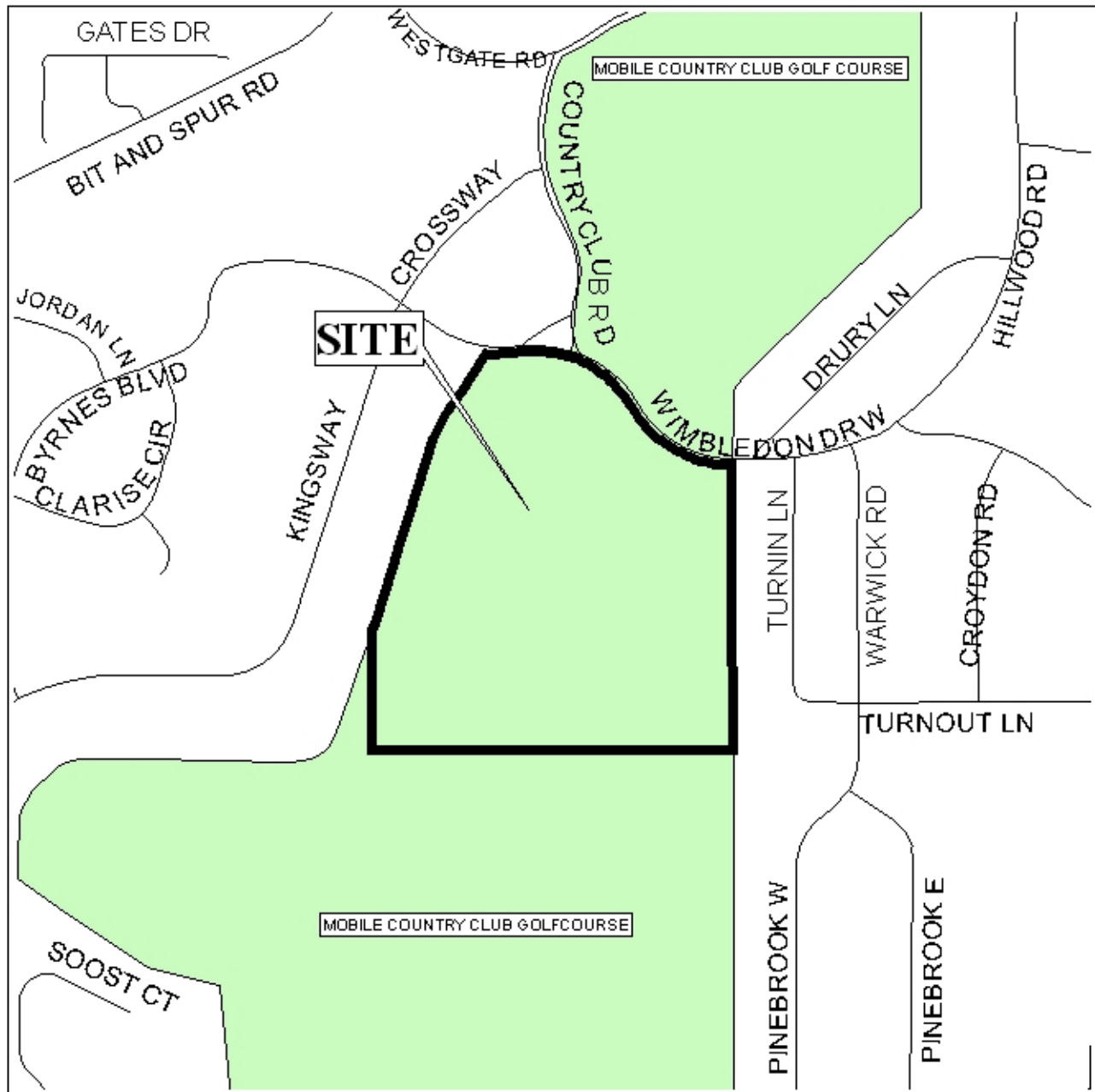

APPLICATION NUMBER Extension DATE June 15, 2006  
APPLICANT Country Club of Mobile ( W. Kennon Drew, Agent)  
REQUEST Planned Unit Development

N  
NTS

# PLANNING COMMISSION VICINITY MAP - EXISTING ZONING

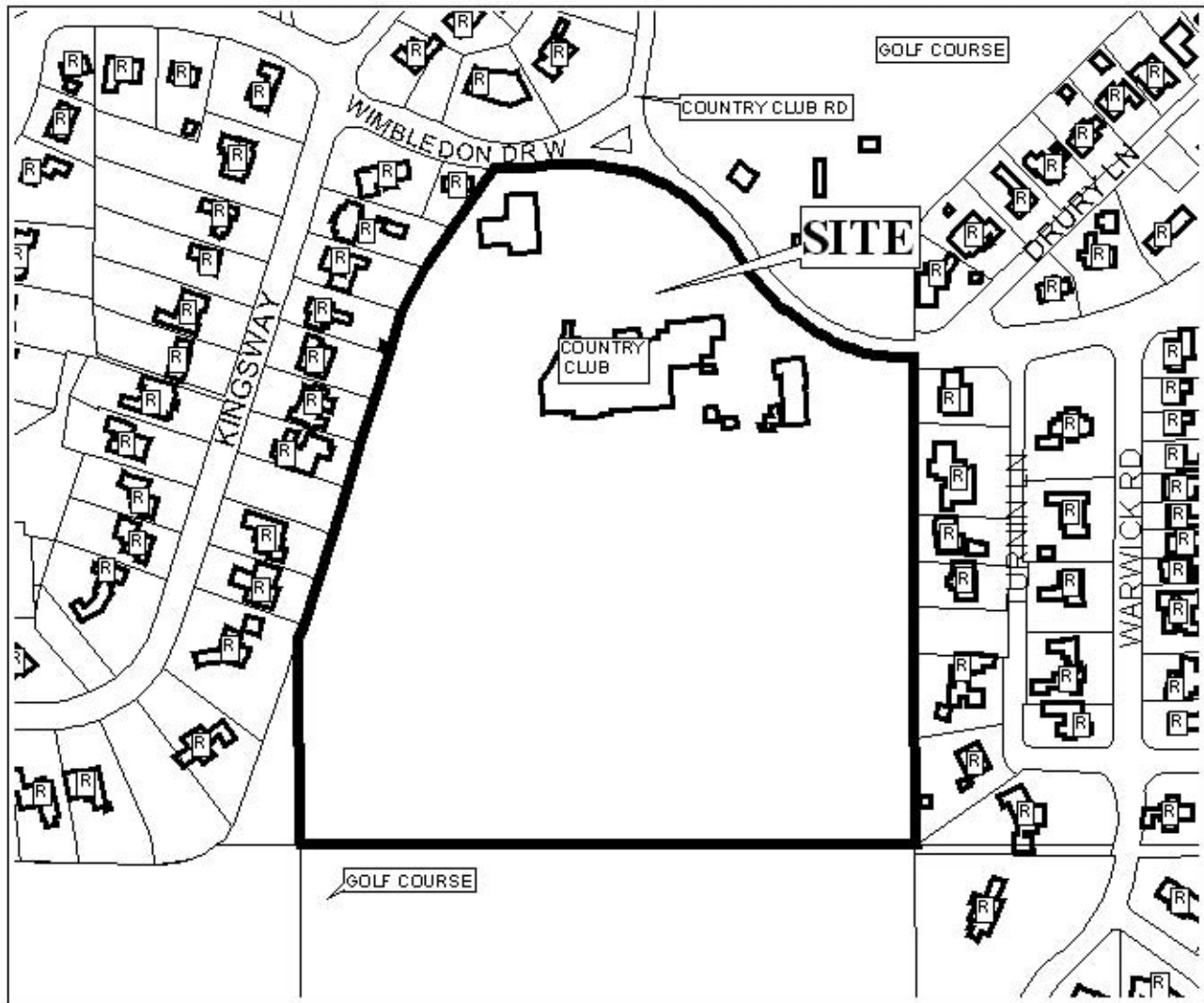

The site is surrounded by single-family residential units.  
A golf course is located to the north and south of the site.

APPLICATION NUMBER Extension DATE June 15, 2006

APPLICANT Country Club of Mobile ( W. Kennon Drew, Agent)

REQUEST Planned Unit Development

LEGEND

R-1	R-2	R-3	R-A	R-B	H-B	B-1	LB-2	B-2	B-3	B-4	B-5	I-1	I-2	NTS
-----	-----	-----	-----	-----	-----	-----	------	-----	-----	-----	-----	-----	-----	-----



## SITE PLAN

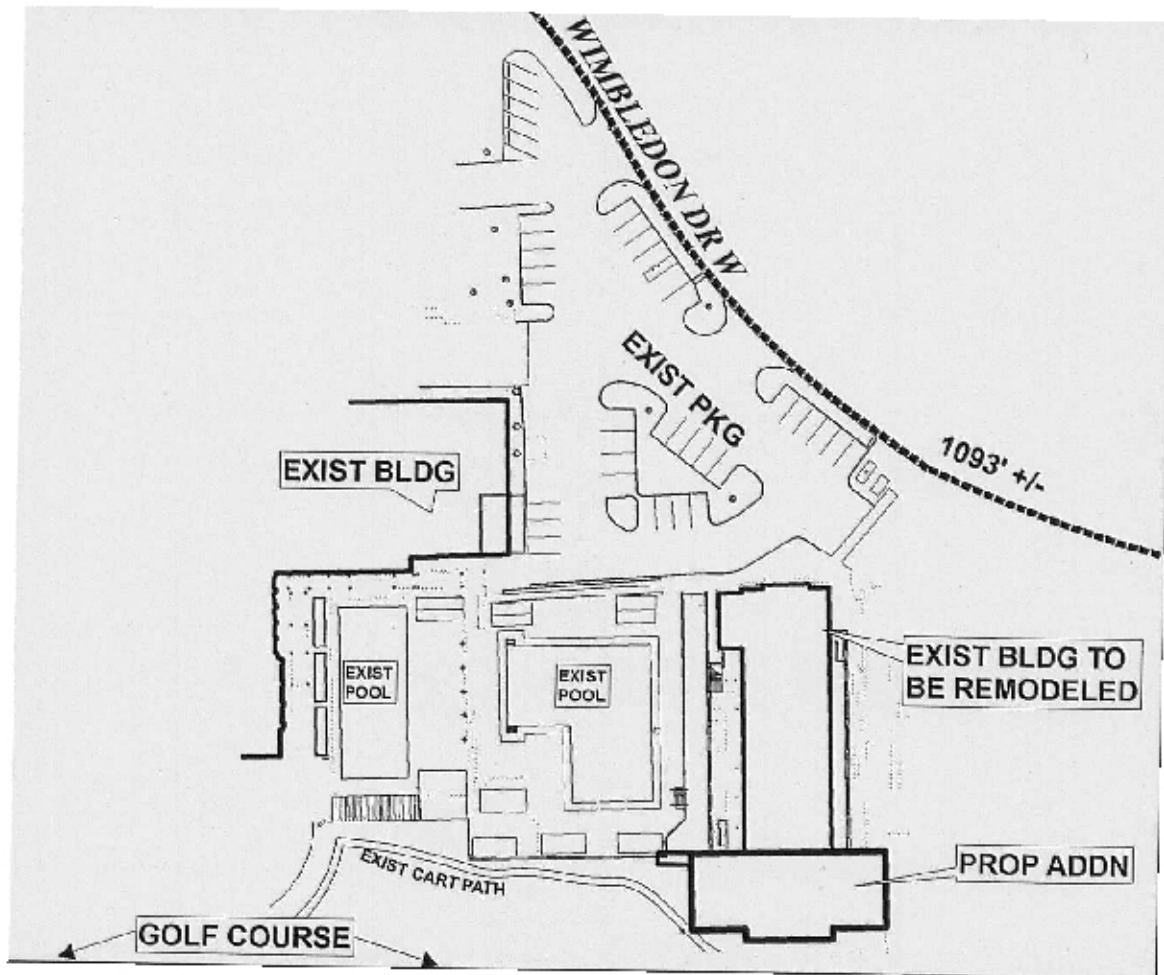

The site plan illustrates the existing buildings, parking, and proposed buildings

APPLICATION NUMBER Extension DATE June 15, 2006  
APPLICANT Country Club of Mobile ( W. Kennon Drew, Agent)  
REQUEST Planned Unit Development



NTS