

EXTENSION

AIRMONT PLACE SUBDIVISION

This is a request for a one-year extension of a previously approved seven lot subdivision. The subdivision is located on the South side of Pleasant Valley Road, 550' + West of Montlimar Drive, extending South to the East terminus of Markham Drive.

There has been one extension since the subdivision was originally approved in December 2000. There have been no changes in conditions in the surrounding area that would affect the subdivision as previously approved; nor have there been changes to the regulations that would affect the previous approval.

Based upon the preceding, it is recommended that this request for extension be approved.

LOCATOR MAP

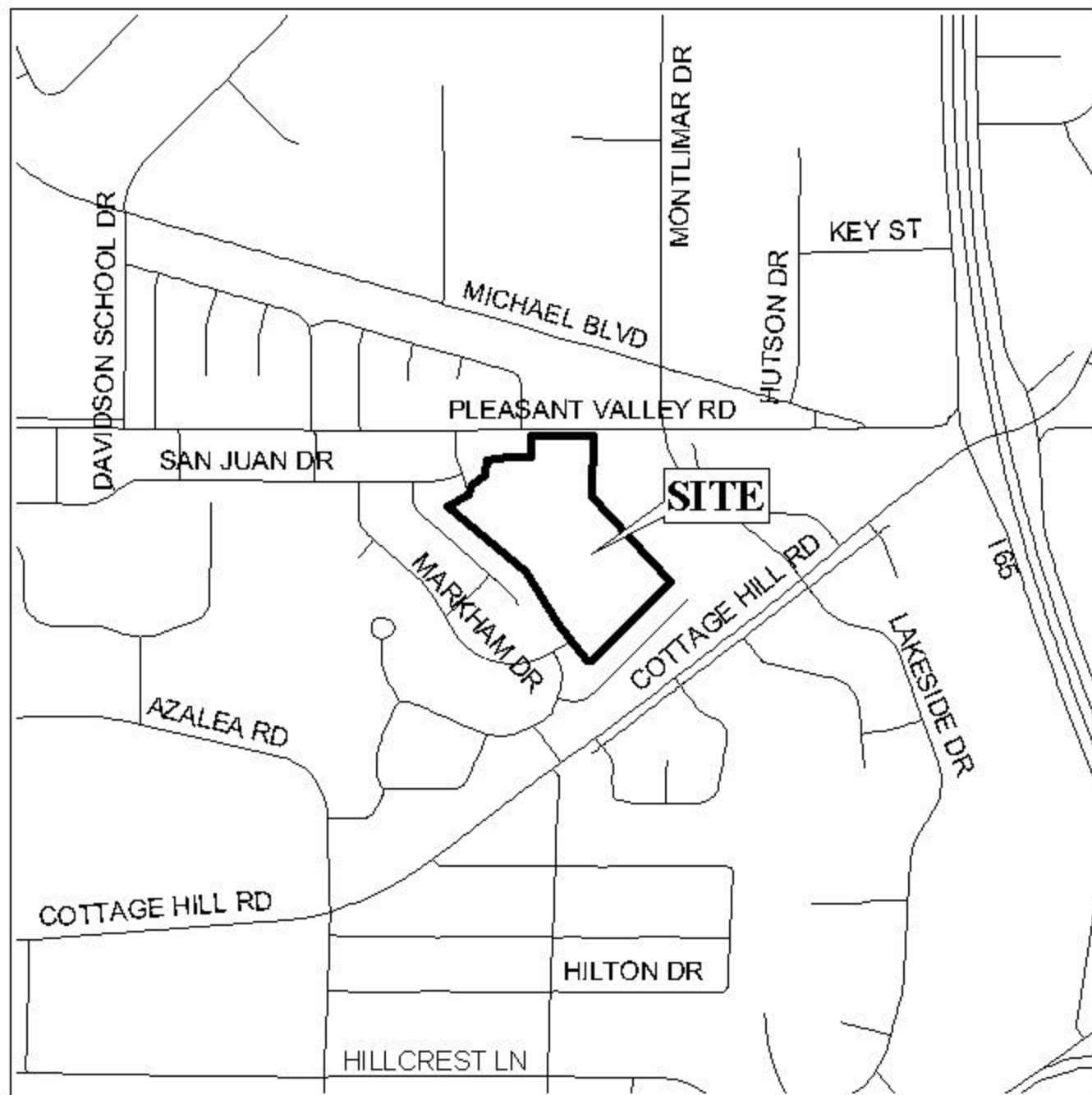

APPLICATION NUMBER Extension DATE March 20, 2003
APPLICANT Airmont Place Subdivision
REQUEST Subdivision



AIRMONT PLACE SUBDIVISION

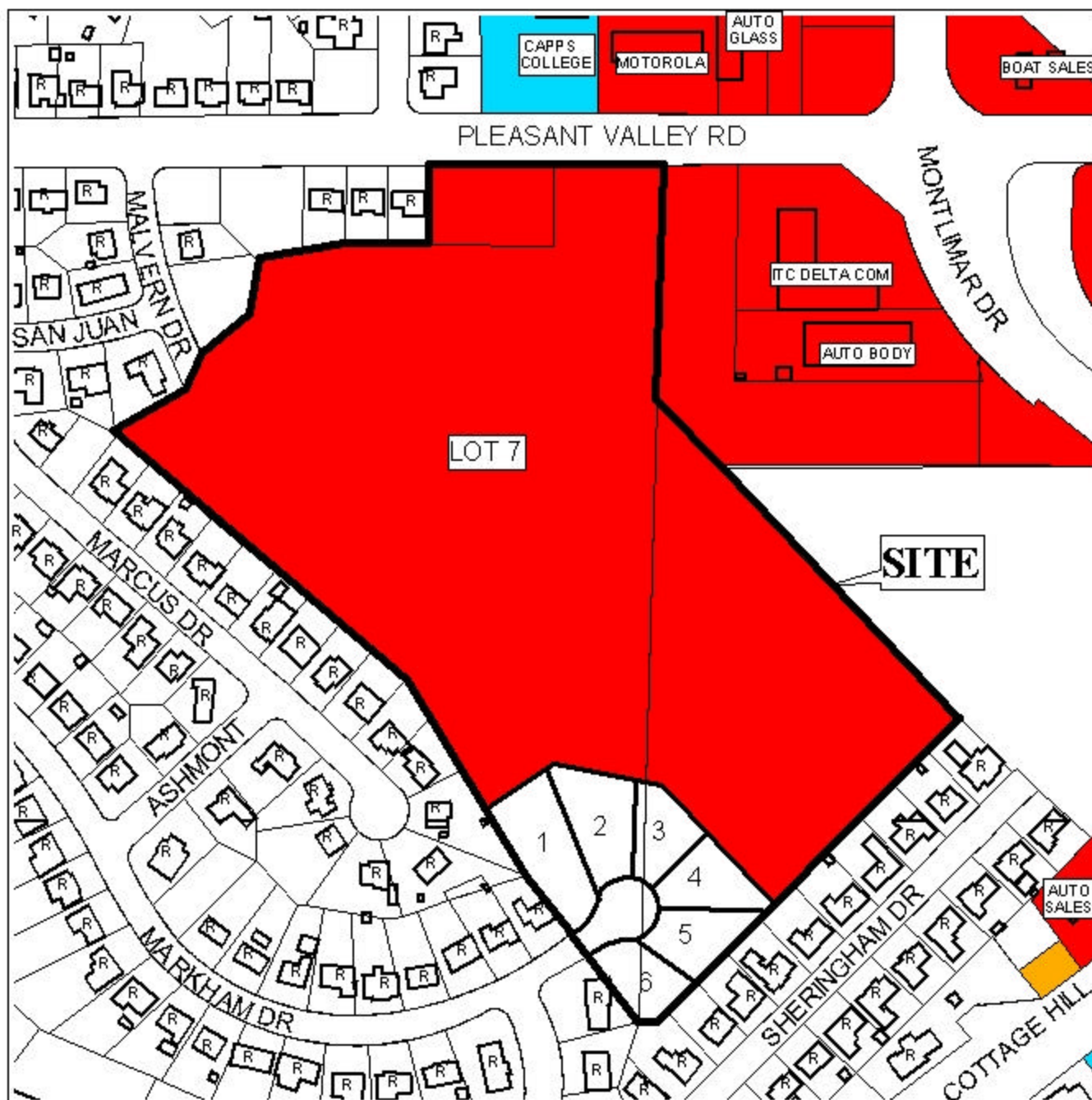

APPLICATION NUMBER Extension DATE March 20, 2003

LEGEND

