

**PLANNED UNIT DEVELOPMENT &
SUBDIVISION STAFF REPORT****Date: May 17, 2007**

<u>NAME</u>	Forest Cove Subdivision, Unit Three and Unit Four (Rester & Coleman Engineers, Inc., Agent)
<u>SUBDIVISION NAME</u>	Forest Cove Subdivision, Unit Three and Unit Four
<u>LOCATION</u>	(South side of Tulane Drive, 125'± East of Belle Wood Drive East, extending to the West side of Forest Dell Road, 725'± North of its South terminus)
<u>CITY COUNCIL DISTRICT</u>	District 7
<u>PRESENT ZONING</u>	R-1, Single-Family Residential
<u>AREA OF PROPERTY</u>	137 lots/ 44.4± acres
<u>CONTEMPLATED USE</u>	Reduced lot widths and sizes, reduced building setbacks, and increased site coverage in a single-family residential subdivision.
<u>TIME SCHEDULE FOR DEVELOPMENT</u>	Immediately
<u>REMARKS</u>	<p>The applicant is requesting a one year extension of a previously approved PUD and Subdivision. The applications were originally approved in 2005, no units have been recorded, and this is the second request for extension.</p> <p>There have been no changes in the area, nor have there been changes to the regulations that would impact the previous approvals.</p>
<u>RECOMMENDATION</u>	<p><i>Planned Unit Development:</i> Based on the preceding, it is recommended that the application for extension be approved.</p> <p><i>Subdivision:</i> Based on the preceding, it is recommended that the application for extension be approved.</p>

LOCATOR MAP

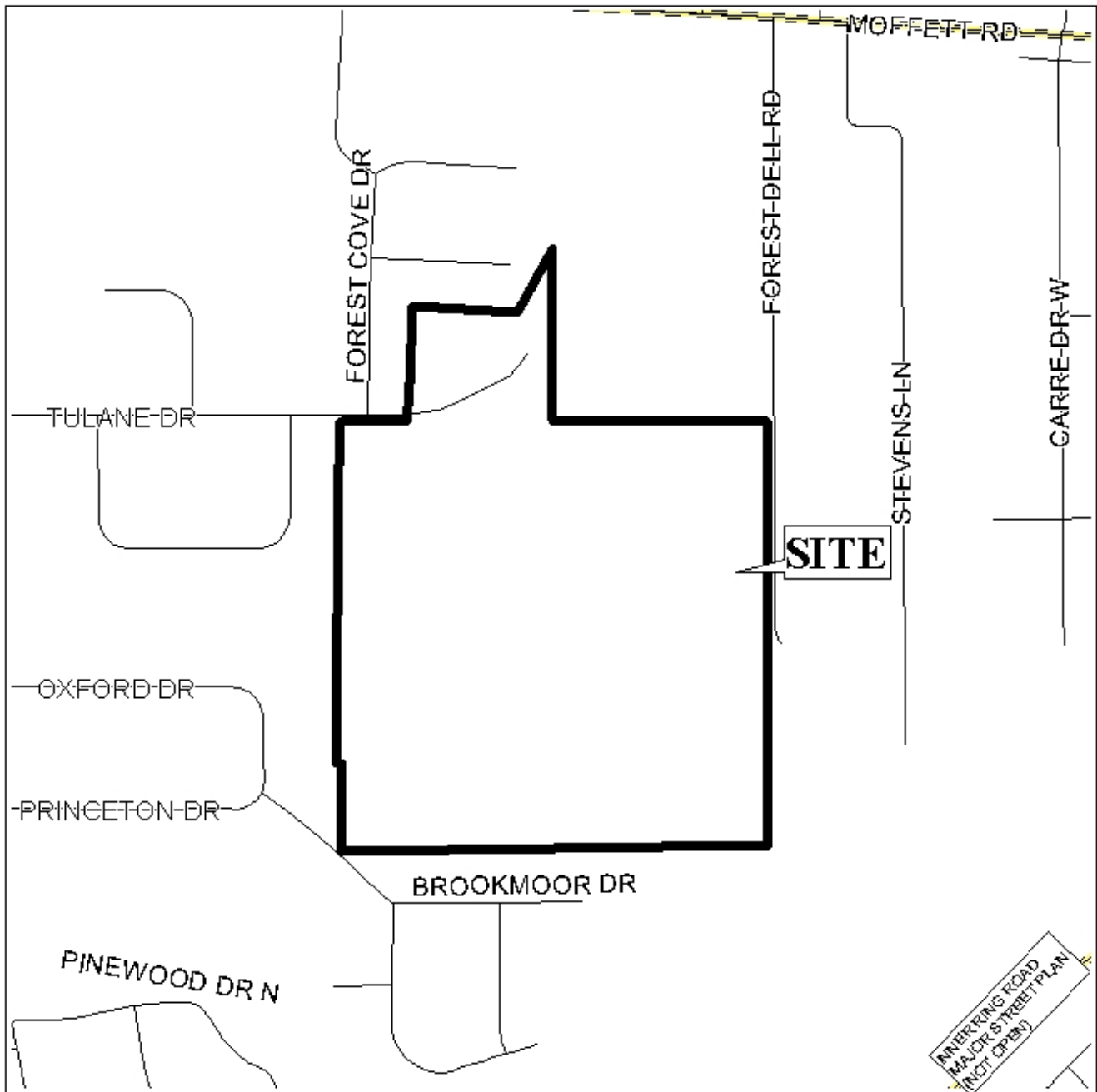

APPLICATION NUMBER 7 & 8 DATE May 17, 2007

APPLICANT Forest Cove Subdivision, Unit Three and Four

REQUEST Subdivision, Planned Unit Development



NTS

PLANNING COMMISSION VICINITY MAP - EXISTING ZONING

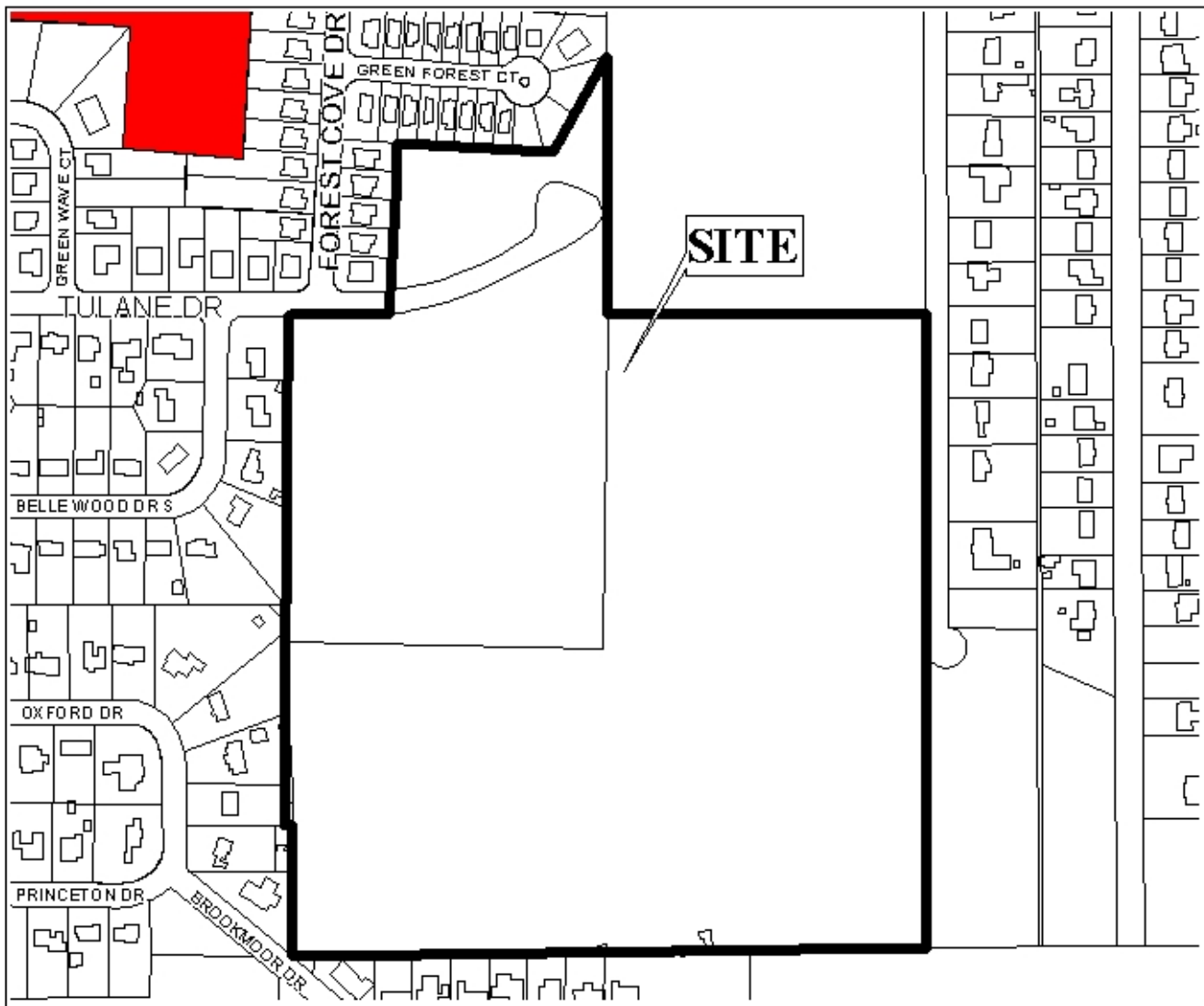

The site is surrounded by single-family residential units

APPLICATION NUMBER 7 & 8 DATE May 17, 2007
 APPLICANT Forest Cove Subdivision, Unit Three and Four
 REQUEST Subdivision, Planned Unit Development

LEGEND

R-1	R-2	R-3	R-A	R-B	H-B	B-1	LB-2	B-2	B-3	B-4	B-5	I-1	I-2



NTS

SITE PLAN

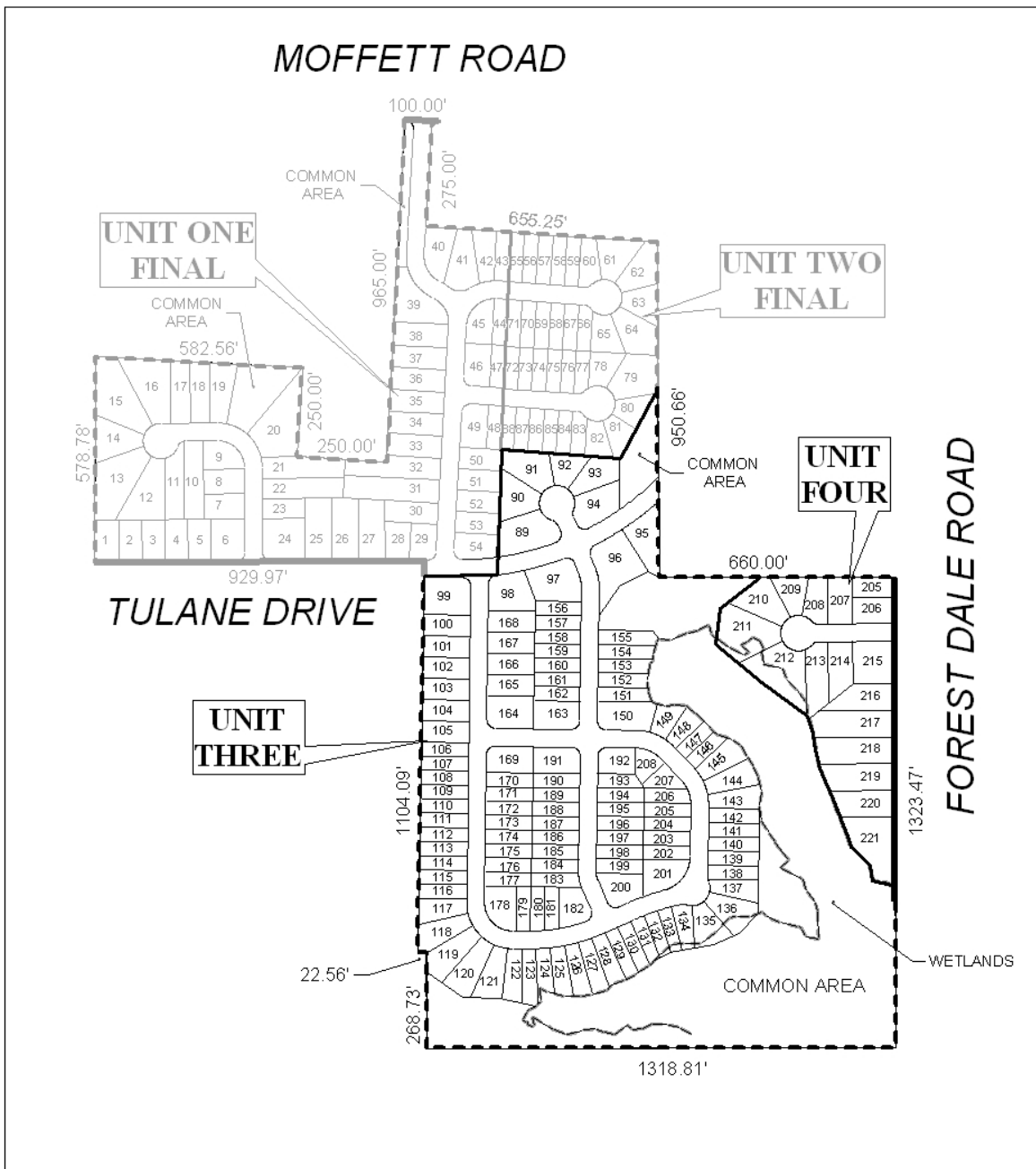

The site is located on the South side of Moffett Road at the South terminus of Northview Drive.
The plan illustrates the proposed lots and existing wetlands.

APPLICATION NUMBER 7 & 8 DATE May 17, 2007
 APPLICANT Forest Cove Subdivision, Unit Three and Unit Four
 REQUEST Planned Unit Development and Subdivision

N
 NTS

TYPICAL LOT DETAIL FOR SETBACKS

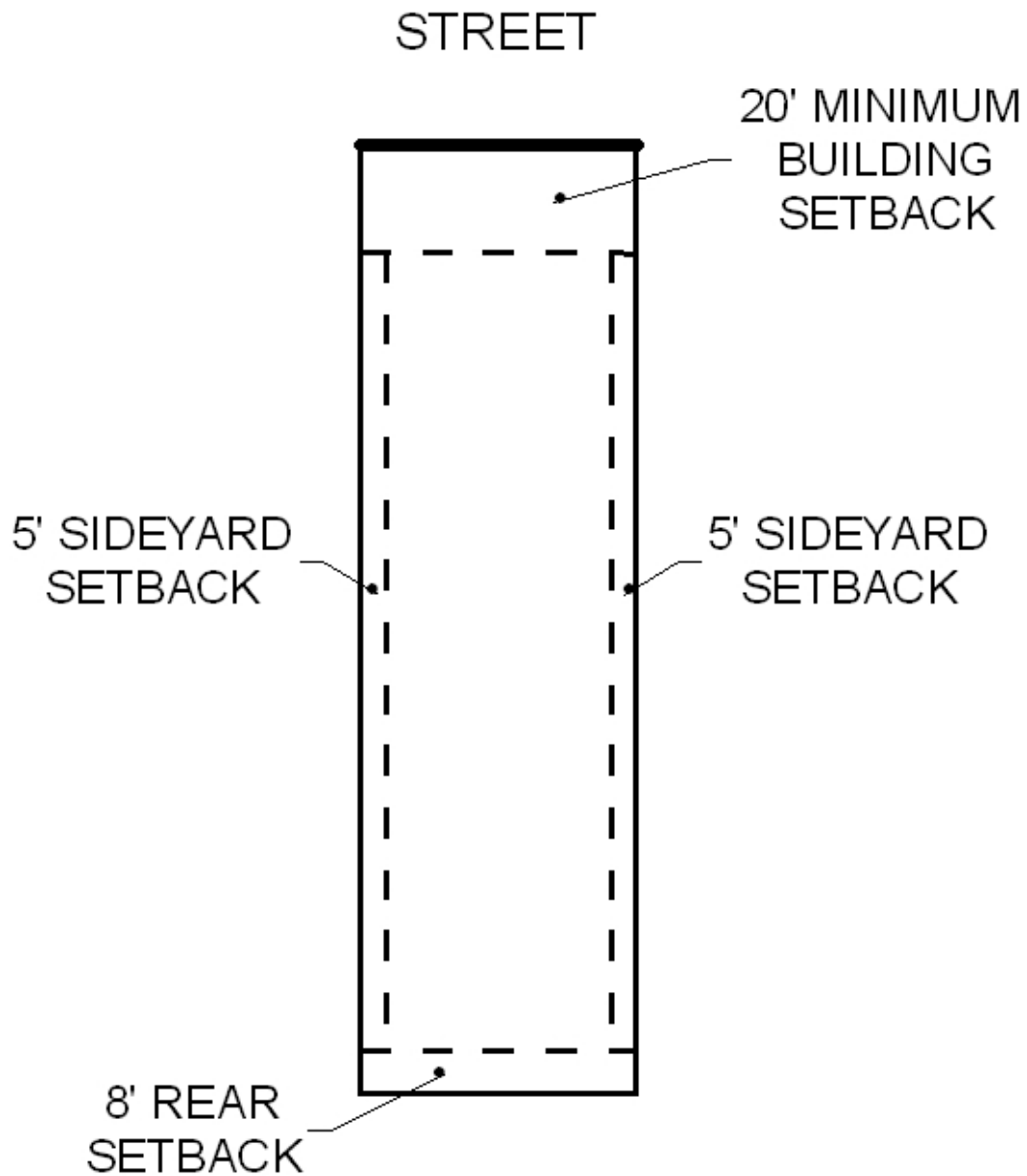

APPLICATION NUMBER 7 & 8 DATE May 17, 2007

APPLICANT Forest Cove Subdivision, Unit Three and Unit Four

REQUEST Planned Unit Development and Subdivision

