

EXTENSION

AIRMONT PLACE SUBDIVISION

This is a request for a one-year extension of a previously approved 7-lot subdivision. The subdivision is located on the South side of Pleasant Valley Road, 550'± West of Montlimar Drive, extending South to the East terminus of Markham Drive.

This is the third extension since the subdivision was originally approved in December 2000. There have been no changes in conditions in the surrounding area that would affect the subdivision as previously approved; nor have there been changes to the regulations that would affect the previous approval. However, as this subdivision requires cul-de-sac construction only the Commission does not typically approve more than one extension. Moreover, the applicant should be informed that a fourth extension is unlikely.

Based upon the preceding, it is recommended that this request for extension be approved; however, a fourth extension is unlikely.

LOCATOR MAP

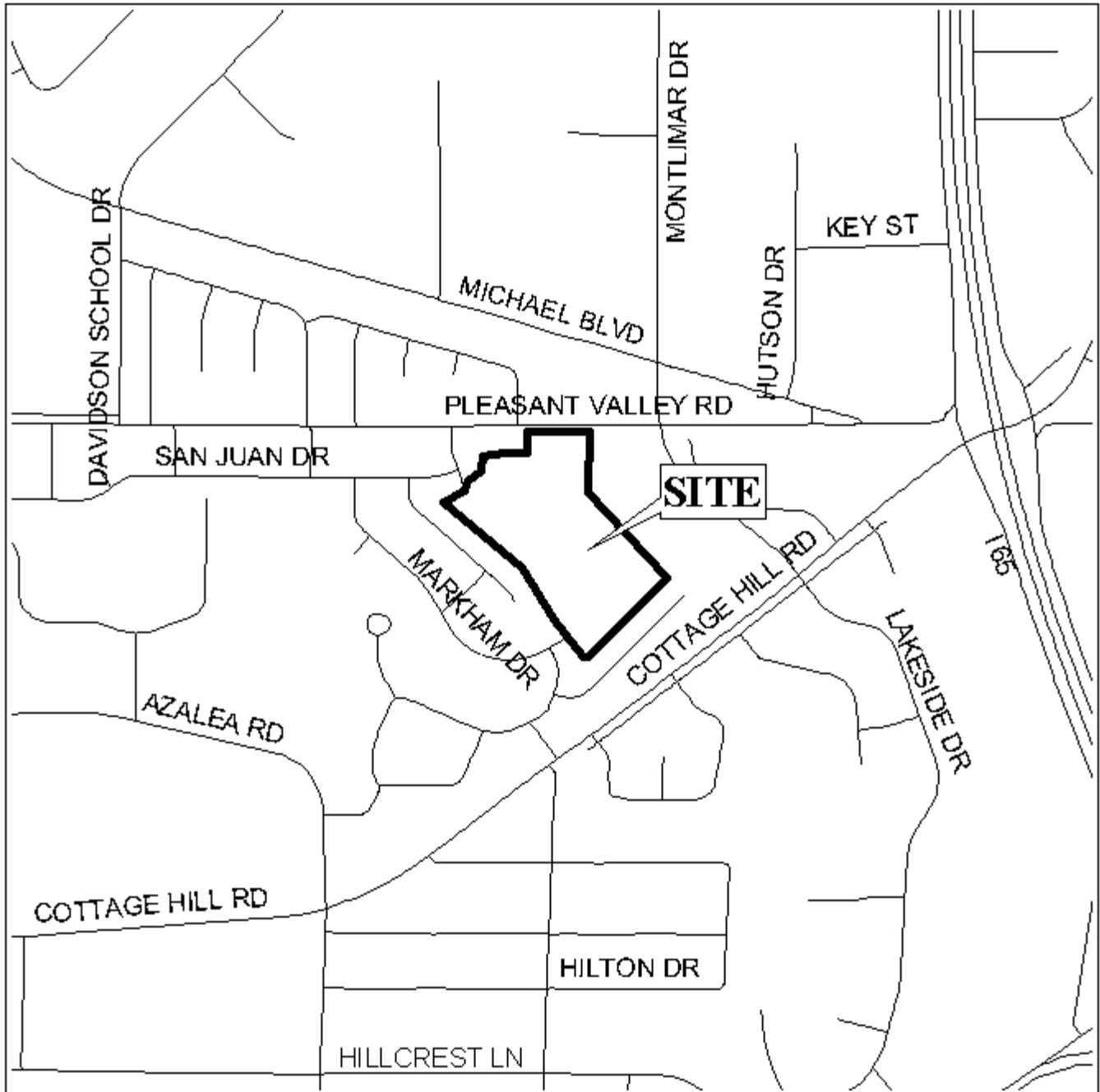

APPLICATION NUMBER Extension DATE March 20, 2003

APPLICANT Airmont Place Subdivision

REQUEST Subdivision



AIRMONT PLACE SUBDIVISION

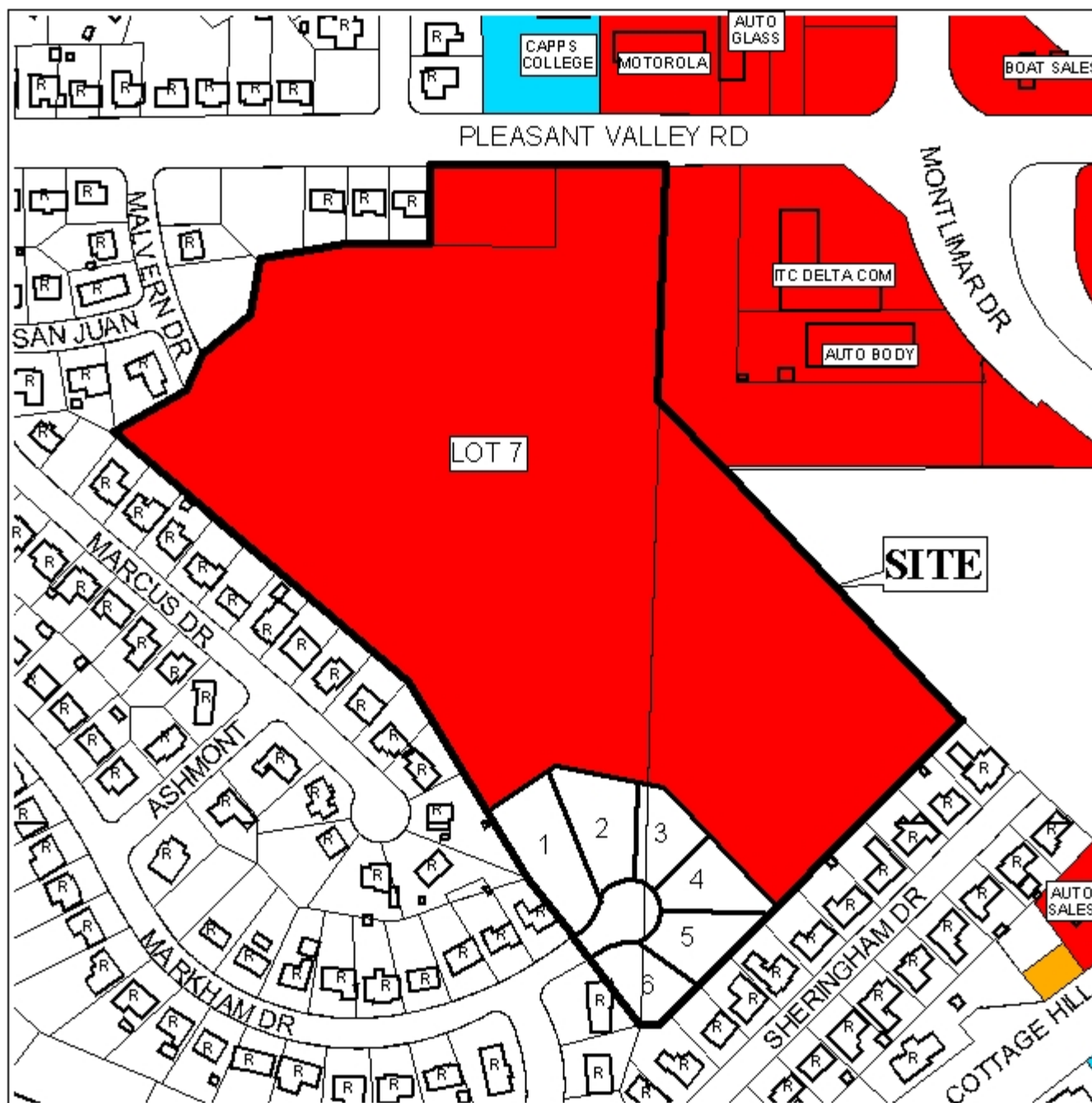

APPLICATION NUMBER Extension DATE March 20, 2003

LEGEND

