

MOBILE MEDICAL GROUP SUBDIVISION

This is a request for a one-year extension of a previously approved 1-lot subdivision. The subdivision is located on the South side of Airport Boulevard, between Wildwood and Pinemont Avenues.

This is the fourth extension request since the subdivision was originally approved in 2005. Though there have been no changes in conditions in the surrounding area that would affect the subdivision as previously approved; the applicant was advised after their third extension that future extensions would be unlikely. The previous extension was received for denial.

It should also be noted that no road construction is required.

Based on the preceding, it is recommended that this request for extension be denied.

LOCATOR MAP

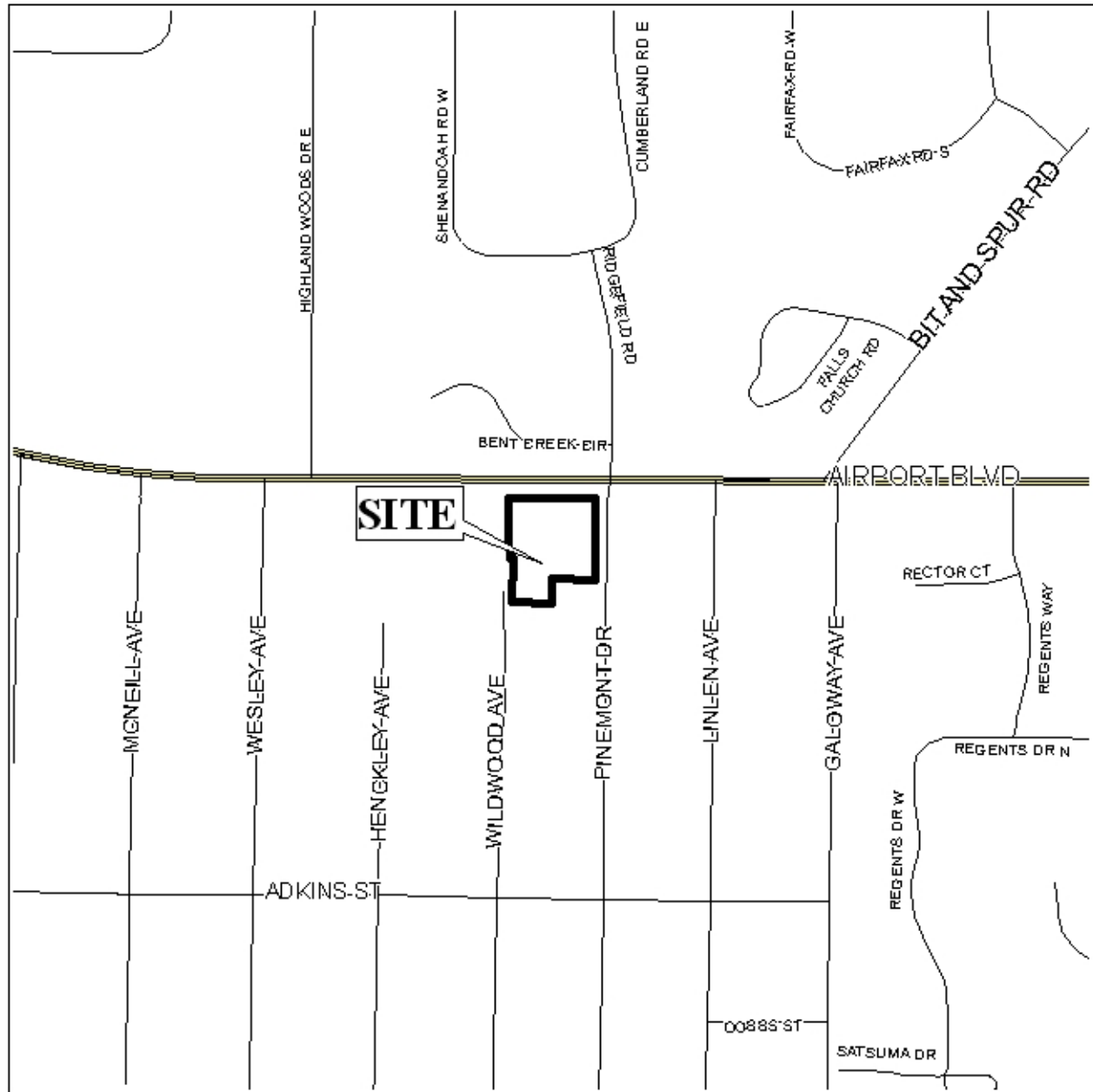

APPLICATION NUMBER 4 DATE October 1, 2009
 APPLICANT Mobile Medical Group Subdivision
 REQUEST Subdivision



NTS

PLANNING COMMISSION VICINITY MAP - EXISTING ZONING

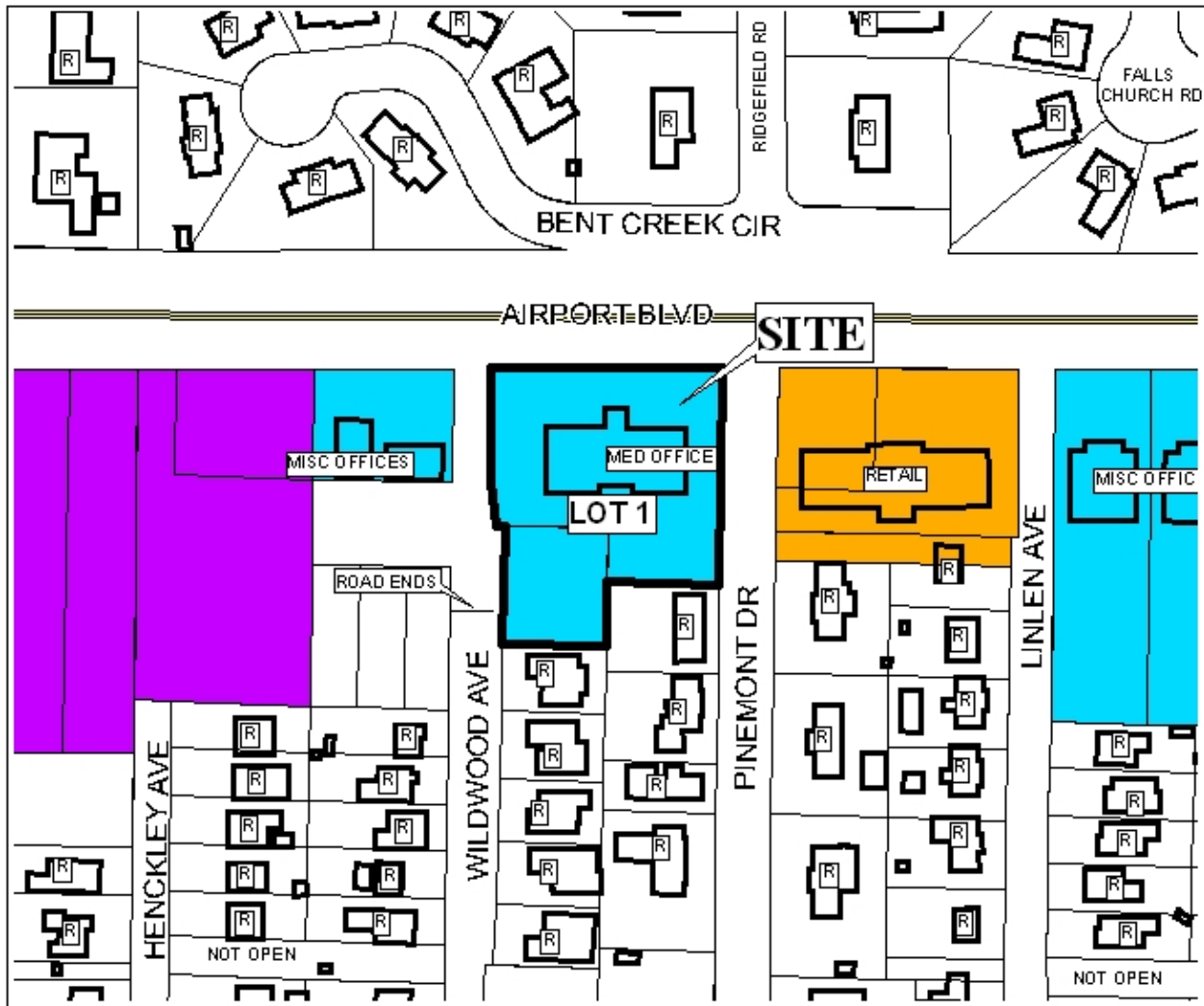

The site is surrounded by single-family residential units.
Commercial sites are located to the east and west to the site.

APPLICATION NUMBER 4 DATE October 1, 2009

APPLICANT Mobile Medical Group Subdivision

REQUEST Subdivision

LEGEND

| | | | | | | | | | | | | | | | |
|-----|-----|-----|-----|-----|-----|-----|-----|------|-----|-----|-----|-----|-----|-----|-----|
| R-1 | R-2 | R-3 | R-A | R-B | H-B | T-B | B-1 | LB-2 | B-2 | B-3 | B-4 | B-5 | I-1 | I-2 | NTS |
|-----|-----|-----|-----|-----|-----|-----|-----|------|-----|-----|-----|-----|-----|-----|-----|

PLANNING COMMISSION VICINITY MAP - EXISTING ZONING



The site is surrounded by single-family residential units.
Commercial sites are located to the east and west to the site.

APPLICATION NUMBER 4 DATE October 1, 2009

APPLICANT Mobile Medical Group Subdivision

REQUEST Subdivision



NTS