

**TURTLE CREEK SUBDIVISION**  
**PHASE II**

Engineering Comments: Must comply with the Mobile County Flood Damage Prevention Ordinance.

The plat illustrates the proposed 25.6 acre $\pm$ , 59 lot subdivision which is located at the East and North termini of Highfield Way, extending South to the East terminus of Turtle Creek Lane South. The subdivision is served by public water and sanitary facilities (South Alabama Utilities).

The proposed subdivision was part of a previously approved subdivision that was to be developed in four phases, and as proposed, would have had two points of access - one to Repoll Road and one to Howard Pearson Road. However, after Phase I was recorded, the approval expired.

While the application now before the Commission represents what was shown as Phase II on the original submission, the plat does not reflect the entire parcel, nor does it reflect compliance with conditions of the previous approval which would be applicable to this unit or Phase.

Based on the preceding, it is recommended that this application be heldover until the July 6 meeting to allow the applicant time to submit a revised plat that includes all of the parent parcel(s), including additional information and postage fees for notification (submissions must be received by June 12).

## LOCATOR MAP



APPLICATION NUMBER 24 DATE January 6, 2005  
APPLICANT Turtle Creek Subdivision  
REQUEST Subdivision



# TURTLE CREEK SUBDIVISION

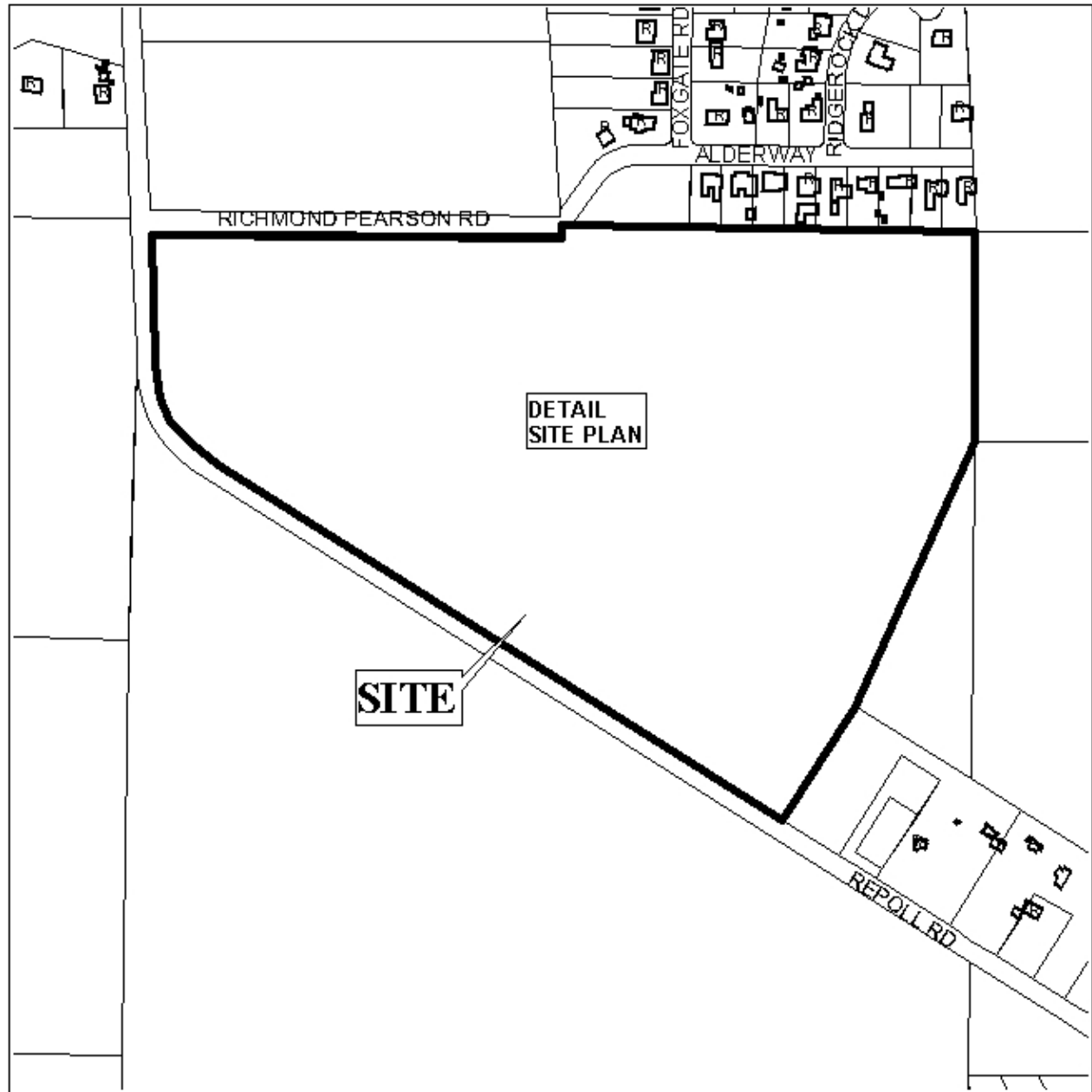

APPLICATION NUMBER 24 DATE January 6, 2005

LEGEND



# DETAIL SITE PLAN

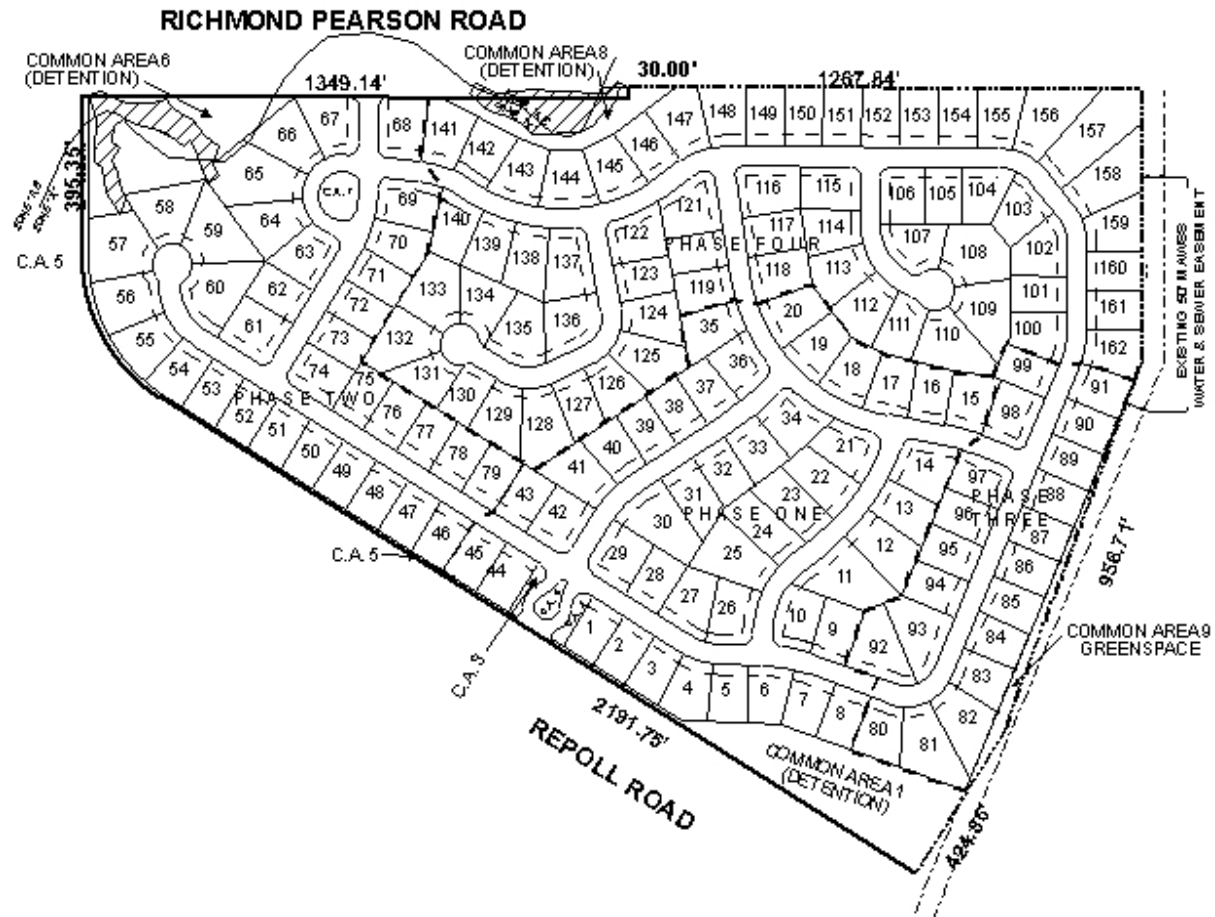

APPLICATION NUMBER 24 DATE January 6, 2005  
APPLICANT Turtle Creek Subdivision  
REQUEST Subdivision

