

**REBECCA HILLS SUBDIVISION**

This is a request for a one-year extension of a previously approved 61-lot subdivision. The subdivision is located at the east terminus of Charmingdale Drive South and the west terminus of Thorman Drive.

There have been no extensions since the subdivision was originally approved on October 19, 2006, and no units have been recorded. There have been no changes in the condition of the surrounding area(s) that would affect the subdivision as previously approved.

There have been no changes to the regulations that would affect the previous approval.

Based on the preceding, it is recommended that this request for extension be approved.

# LOCATOR MAP

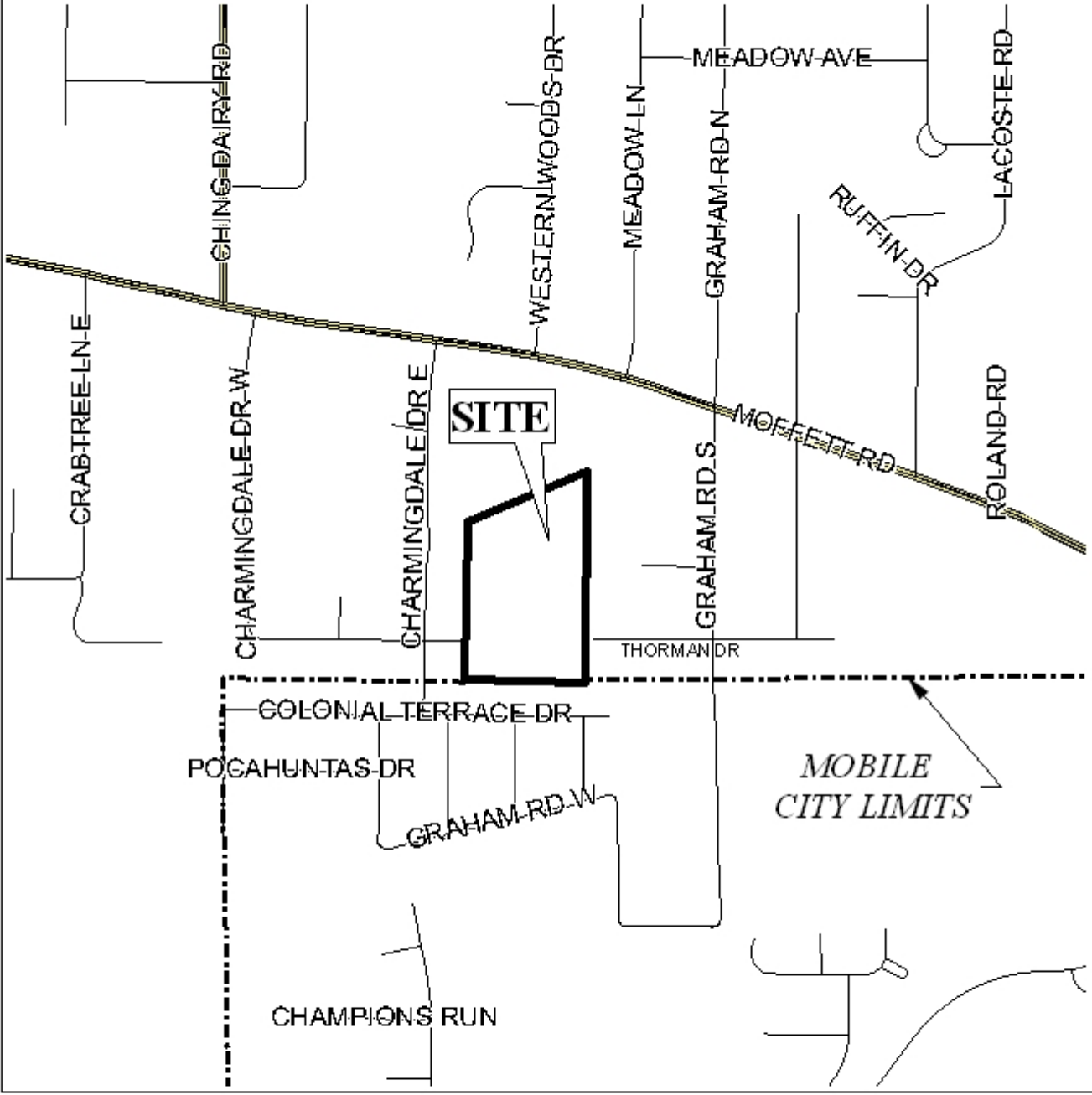

APPLICATION NUMBER 18 DATE October 18, 2007

APPLICANT Rebecca Hills Subdivision, Resubdivision of Lot 1

REQUEST \_\_\_\_\_ Subdivision \_\_\_\_\_

NTS

# REBECCA HILLS SUBDIVISION, RESUBDIVISION OF LOT 1



APPLICATION NUMBER 18 DATE October 18, 2007

LEGEND

R-1	R-2	R-3	R-A	R-B	H-B	T-B	B-1	LB-2	B-2	B-3	B-4	B-5	I-1	I-2
-----	-----	-----	-----	-----	-----	-----	-----	------	-----	-----	-----	-----	-----	-----



NTS

# DETAIL SITE PLAN

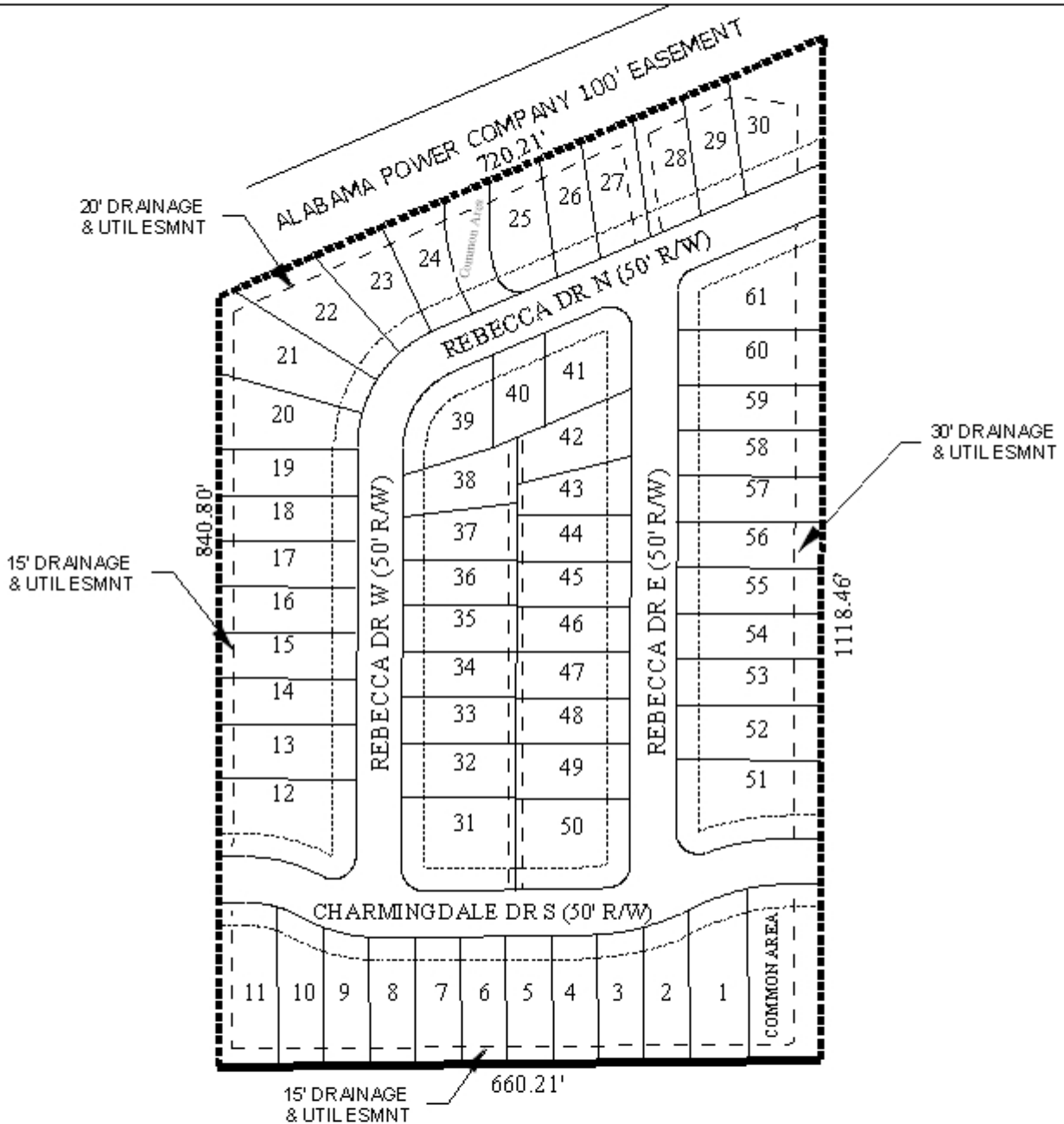

APPLICATION NUMBER 18 DATE October 18, 2007  
 APPLICANT Rebecca Hills Subdivision, Resubdivision of Lot 1  
 REQUEST Subdivision



NTS