

**SOLLIE ROAD SUBDIVISION (NOW KNOWN AS
FALLING LEAF SUBDIVISION, UNIT ONE)**

This is a request for a one-year extension of a previously approved 51-lot subdivision. The subdivision is located on the East side of Sollie Road, 400'± North of the East terminus of Isle of Palms Drive, extending to the East terminus of Raleigh Boulevard.

This is the first request for an extension since the subdivision was originally approved in July, 2006. A Land Disturbance permit has recently been issued for road construction under the new Falling Leaf Subdivision name. There have not been changes in conditions in the surrounding area that would affect the subdivision as previously approved, nor have there been changes to the regulations that would affect the previous approval. Also, Falling Leaf Subdivision, Unit Two, was approved at the May 3 meeting.

Based on the preceding, it is recommended that this request for extension be approved.

LOCATOR MAP

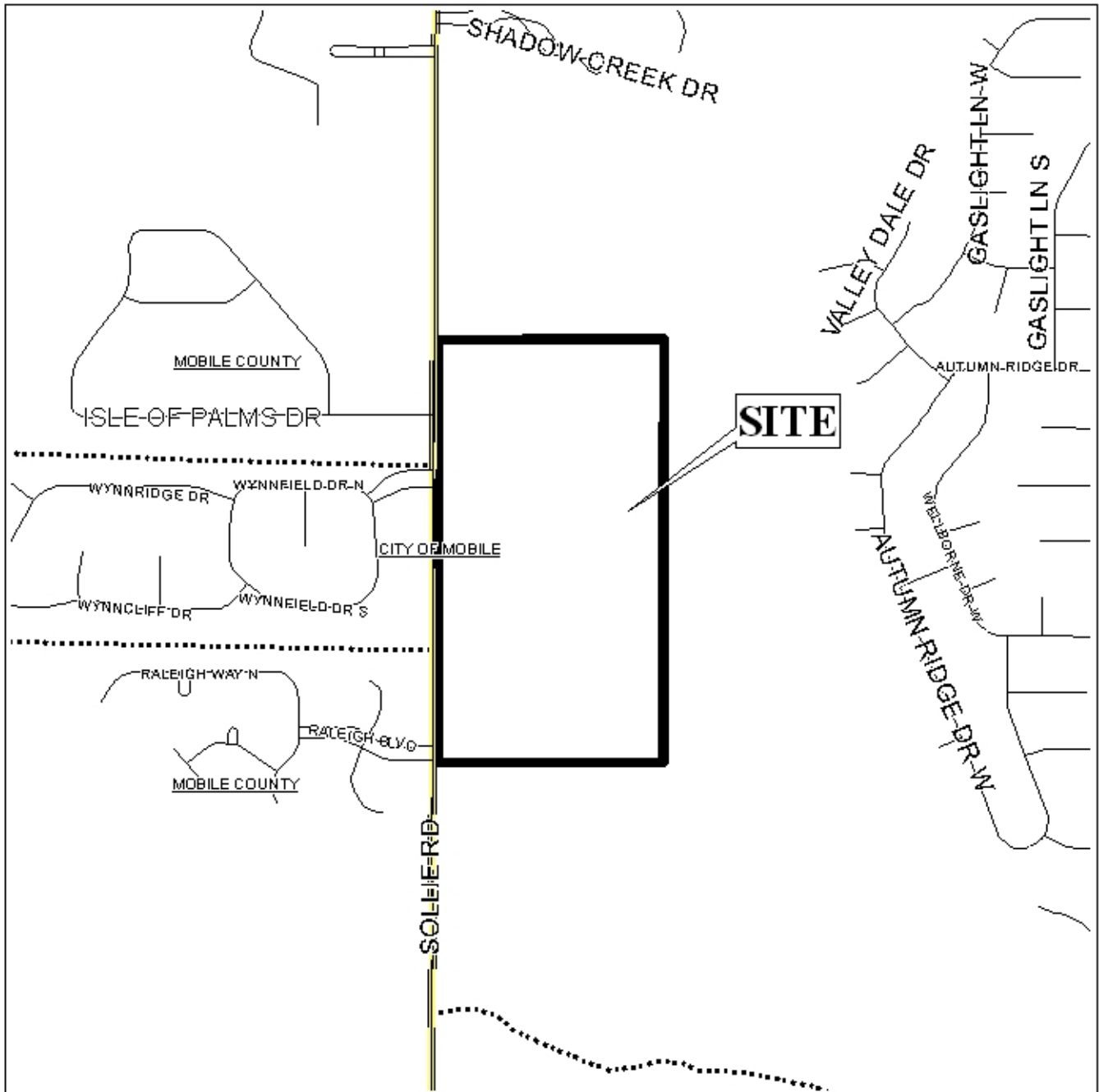

APPLICATION NUMBER 17 DATE July 20, 2006

APPLICANT Falling Leaf Subdivision, Unit One (Formerly Known as Sollie Road Subdivision)

REQUEST Subdivision



DETAIL SITE PLAN

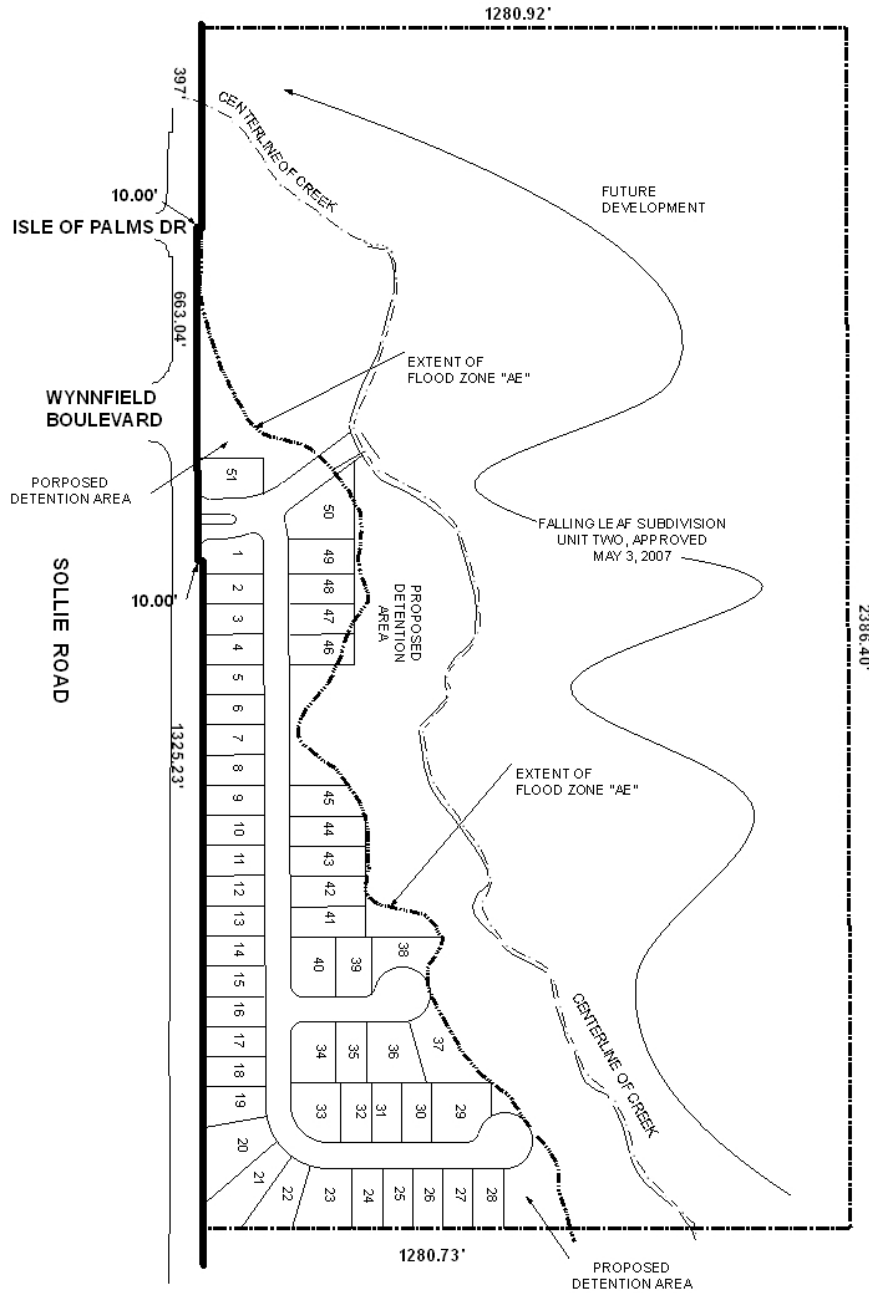

APPLICATION NUMBER 17 DATE July 19, 2007

APPLICANT Falling Leaf Subdivision, Unit One (Formerly Known as Sollie Road Subdivision)

REQUEST Subdivision



NTS