

DIXON ESTATES SUBDIVISION,
UNIT ONE

This is a request for a one-year extension of a previously approved two-lot subdivision. The subdivision is located on the Northeast corner of Tuthill Lane and Stein Avenue.

This is the second request for an extension since the subdivision was originally approved in 2006. There have not been changes in conditions in the surrounding area that would affect the subdivision as previously approved, nor have there been changes to the regulations that would affect the previous approval.

It should be noted, however, that no road construction was required for this subdivision. In addition, the applicant was advised after the first extension that additional extensions would be unlikely.

Based on the preceding, it is recommended that this request for extension be denied.

LOCATOR MAP

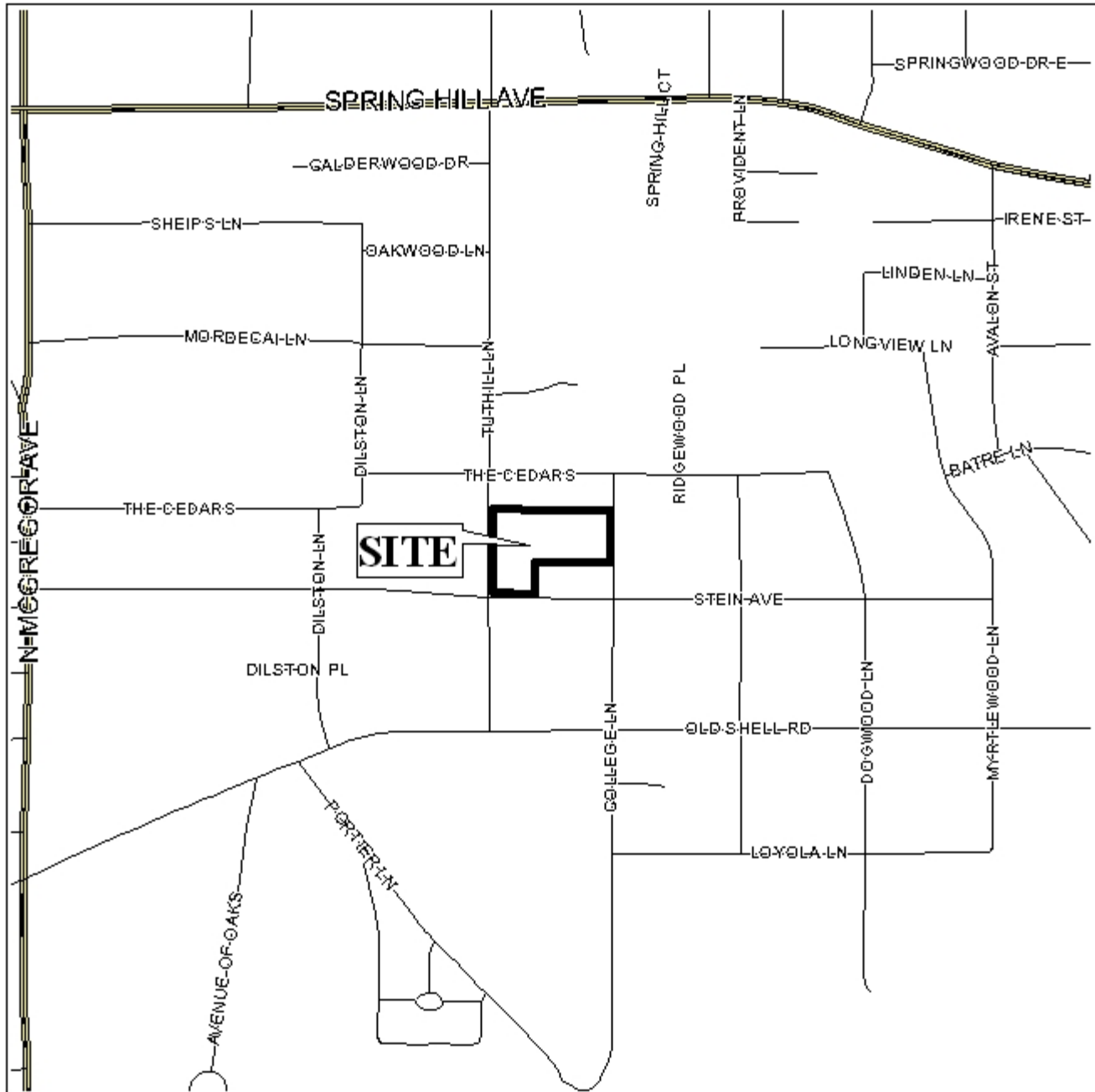

APPLICATION NUMBER 16 DATE March 6, 2008

APPLICANT Dixon Estates Subdivision, Unit One

REQUEST Subdivision



NTS

DIXON ESTATE SUBDIVISION, UNIT ONE

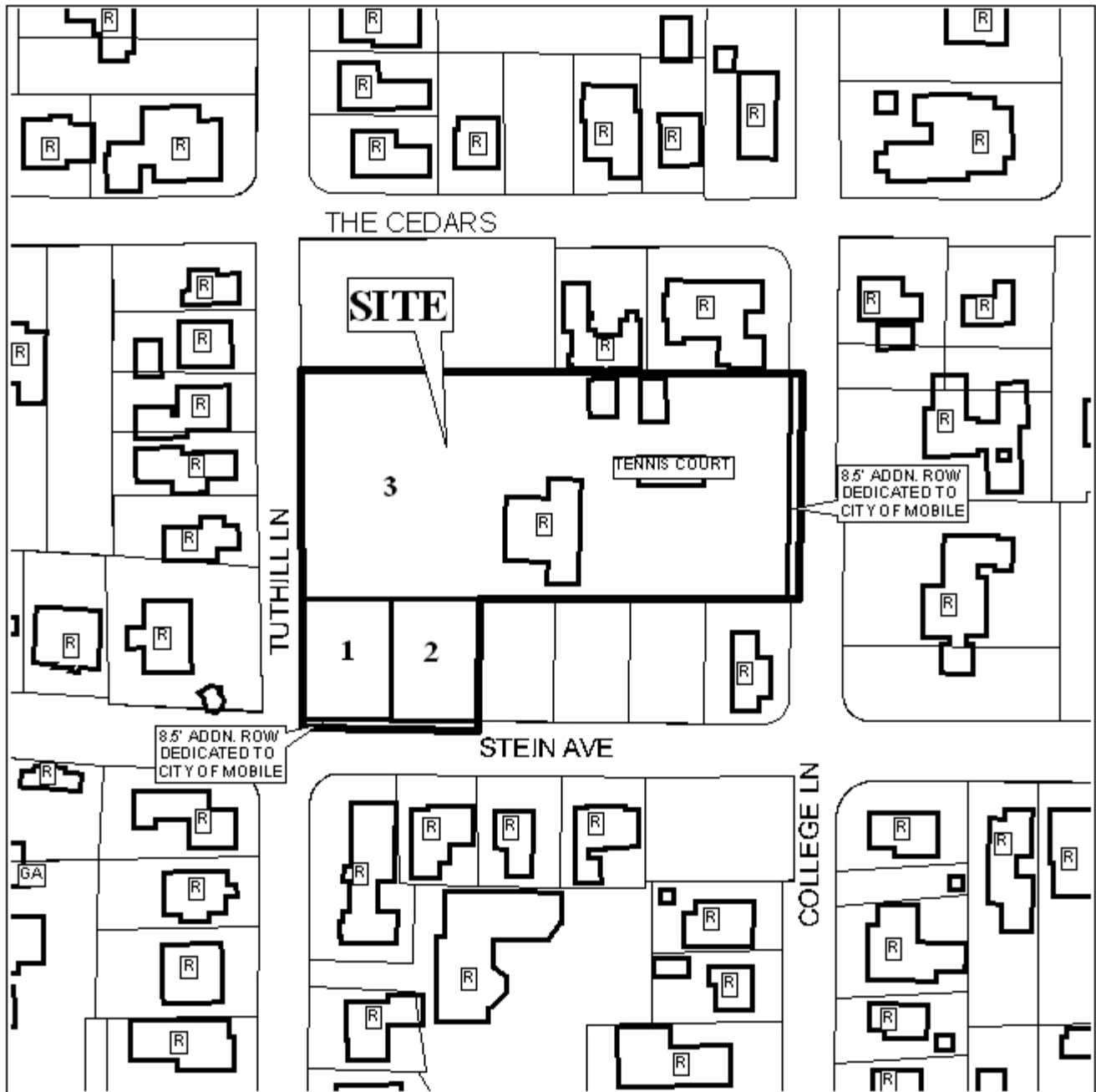

APPLICATION NUMBER 16 DATE March 6, 2008

