

BELLINGRATH ROAD COUNTRY CLUB ESTATES
SUBDIVISION, ADDITION TO

This is a request for a one-year extension of a previously approved 569-lot subdivision. The subdivision is located at the East terminus of Country Club Boulevard and extends through to the Southwest corner of Old Military Road and Section Line Road.

There have been several extensions and units recorded since the subdivision was originally approved in 1996. The last unit recording was July, 2007, which would effectively continue the case to July, 2008; however, roads are under construction in preparation to record another unit, and this extension would continue the case to January 2009, if approved. There have been no changes in the condition of the surrounding area(s), nor have there been any changes to the regulations, that would affect the previous approval.

Based on the preceding, it is recommended that this request for extension be approved.

LOCATOR MAP

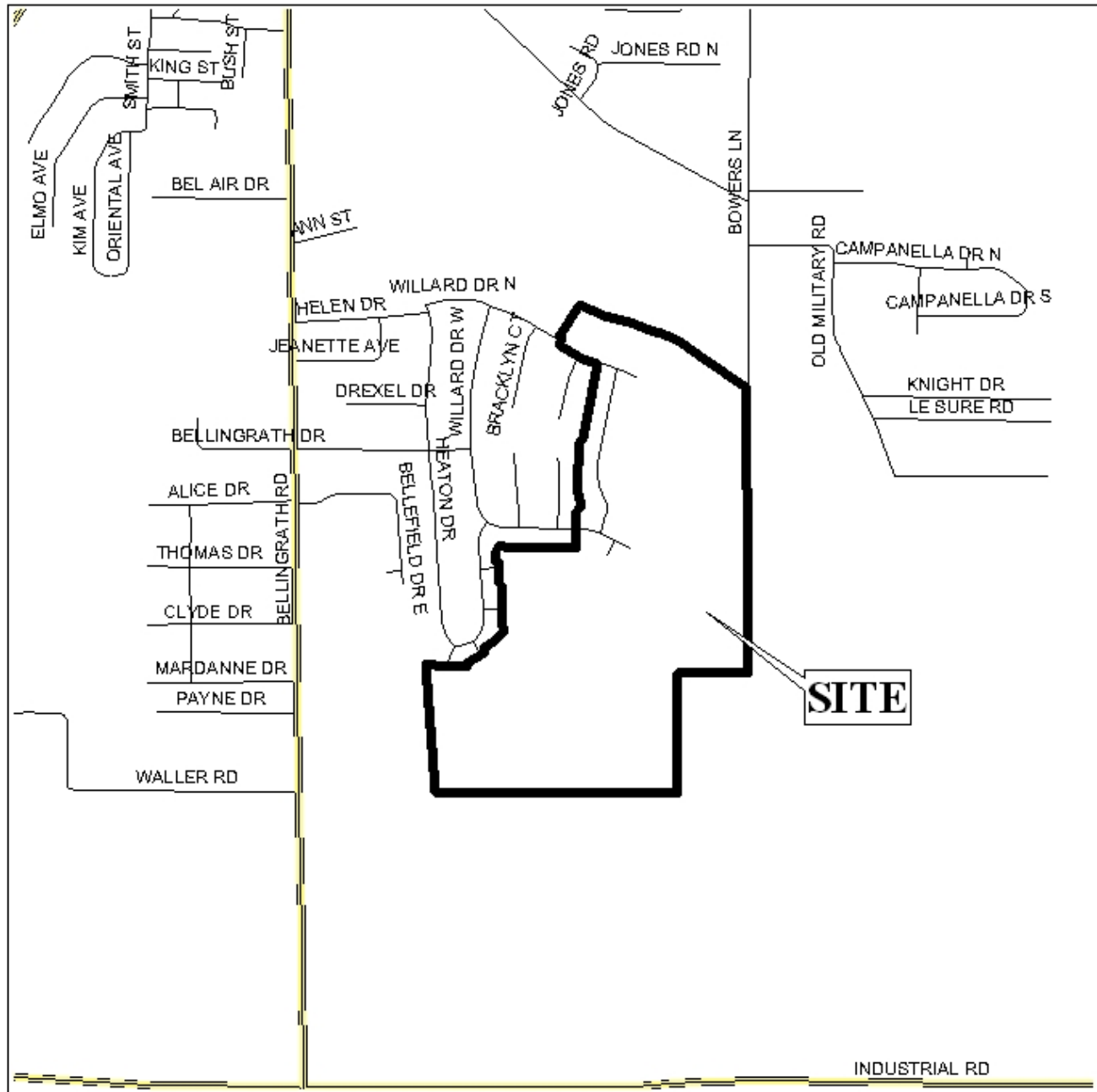

APPLICATION NUMBER 15 DATE January 3, 2008

APPLICANT Bellingrath Road Country Club Estates Sub, Addition to

REQUEST Subdivision



BELLINGRATH ROAD COUNTRY CLUB ESTATES SUBDIVISION, ADDITION TO

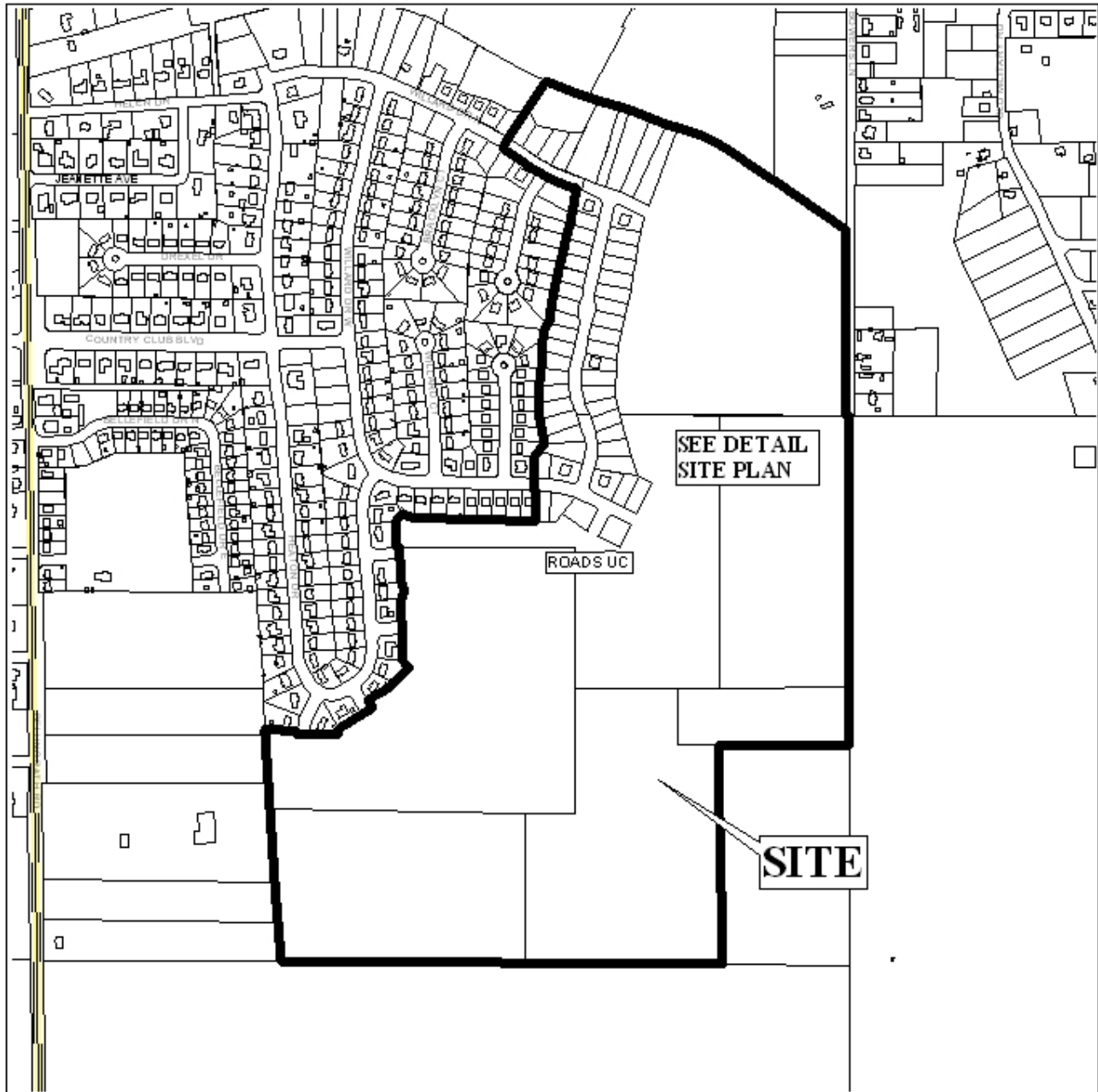

APPLICATION NUMBER 15 DATE January 3, 2008

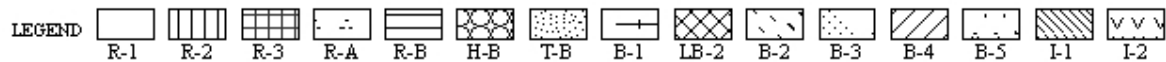

DETAIL SITE PLAN

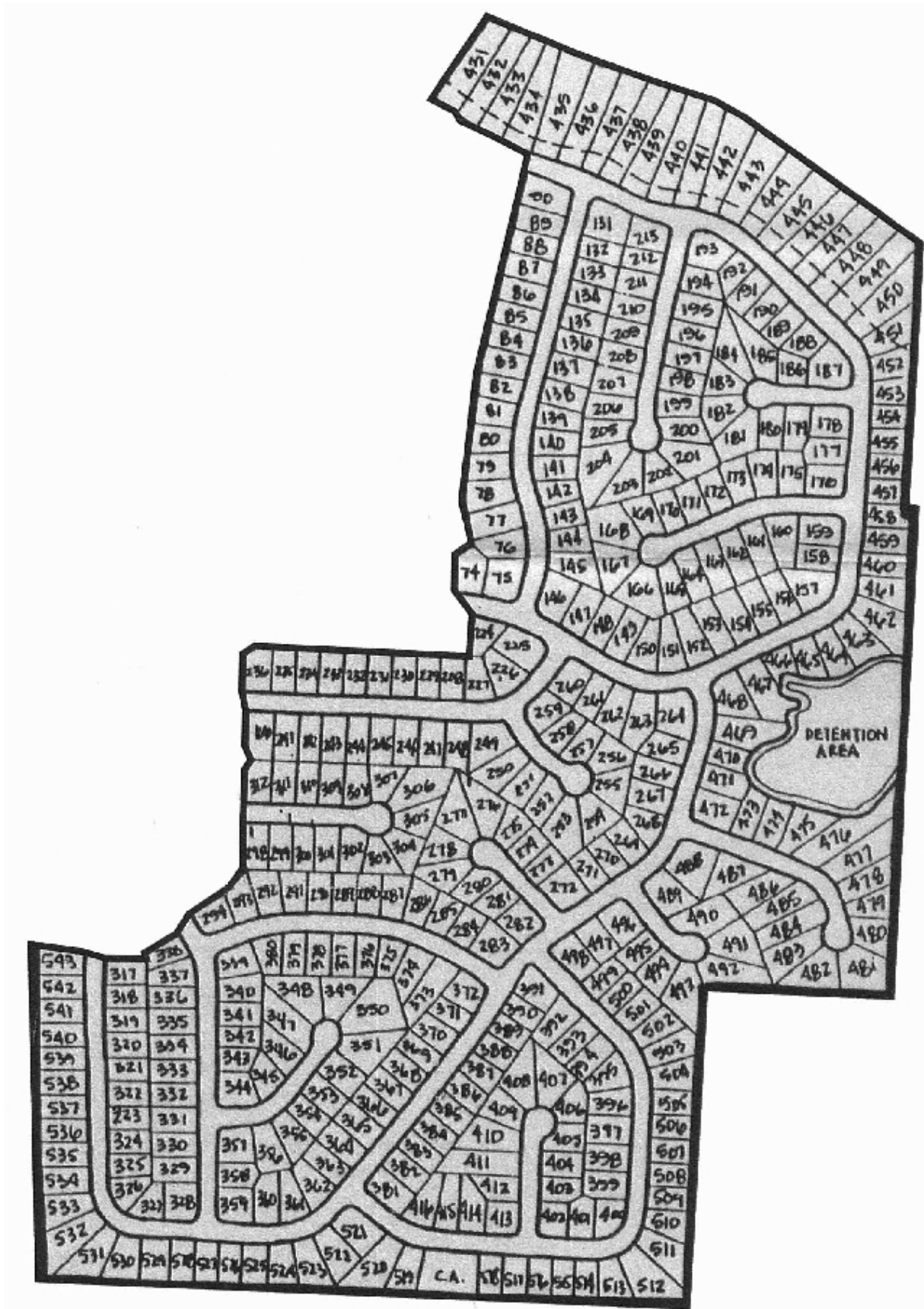

APPLICATION NUMBER 15 DATE January 3, 2008

APPLICANT Bellingrath Road Country Club Estates Subdivision, Addition To

REQUEST Subdivision

N
NTS