

## **MADDOX PLACE SUBDIVISION**

This is a request for a one-year extension of a previously approved 71-lot subdivision. The subdivision is located on the West side of McFarland Road, 290'± South of Hamilton Creek Drive.

There have been no extensions since the subdivision was originally approved on October 5, 2006, and no units have been recorded. There have been no changes in conditions in the surrounding area that would affect the subdivision as previously approved.

There have been no changes to the regulations that would affect the previous approval.

Based on the preceding, it is recommended that this request for extension be approved, but the applicant is advised that, unless road construction is underway or units are recorded, no further extensions are likely.

# LOCATOR MAP

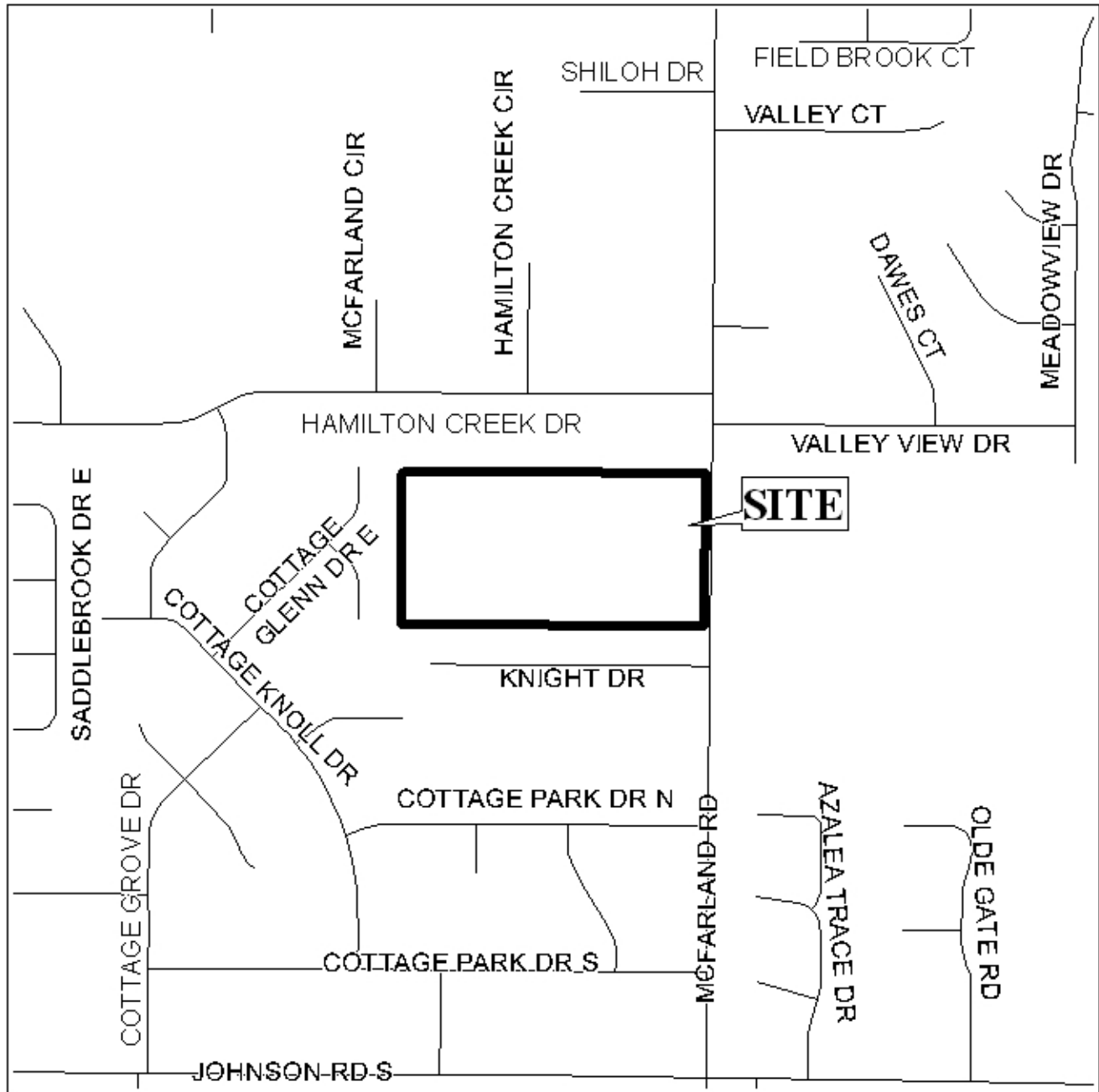

APPLICATION NUMBER 14 DATE August 16, 2007

APPLICANT Maddox Place Subdivision

REQUEST Subdivision



NTS

# MADDOX PLACE SUBDIVISION

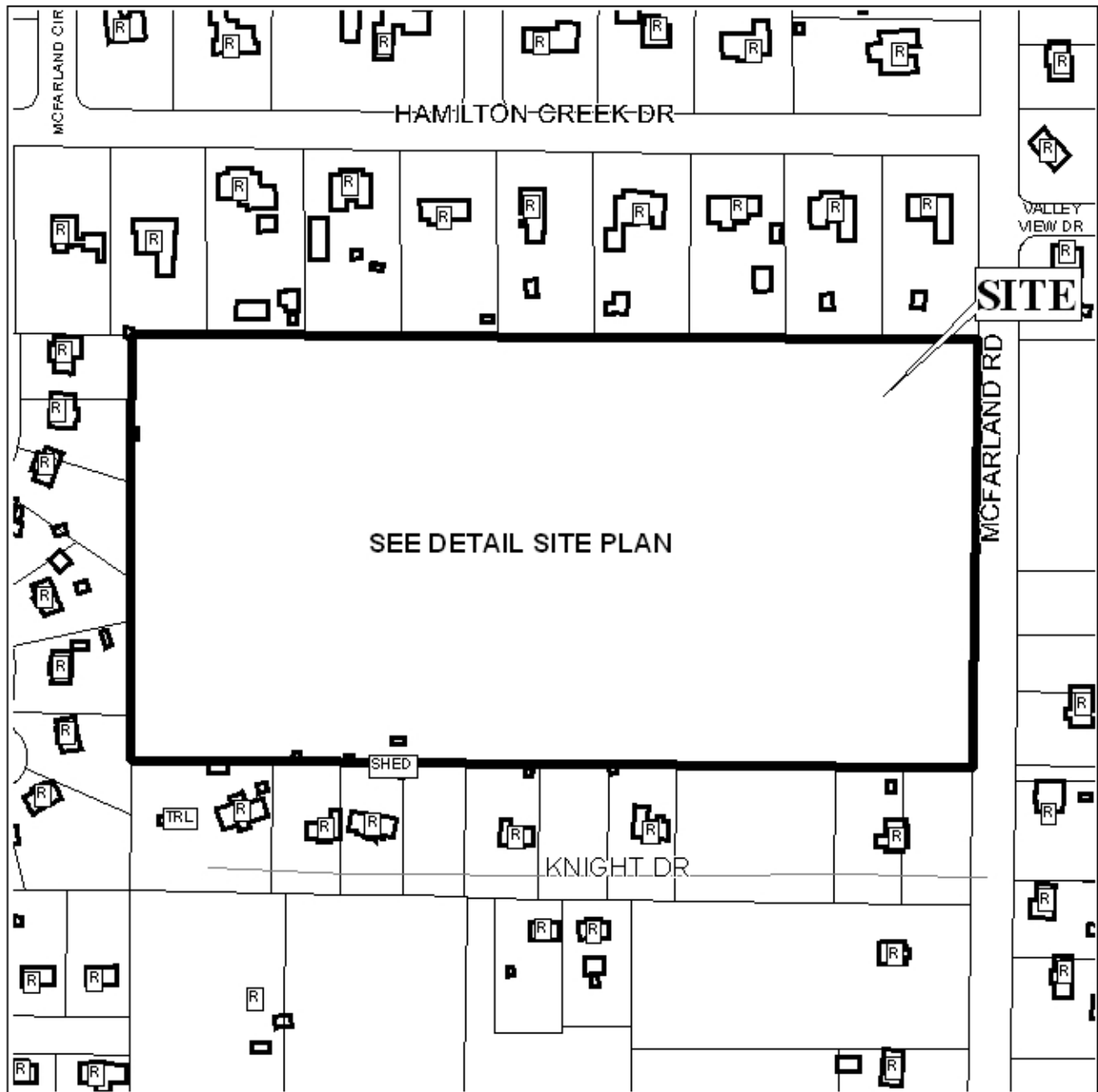

APPLICATION NUMBER 14 DATE August 16, 2007

LEGEND

R-1	R-2	R-3	R-A	R-B	H-B	T-B	B-1	LB-2	B-2	B-3	B-4	B-5	I-1	I-2
-----	-----	-----	-----	-----	-----	-----	-----	------	-----	-----	-----	-----	-----	-----



NTS

# DETAIL SITE PLAN

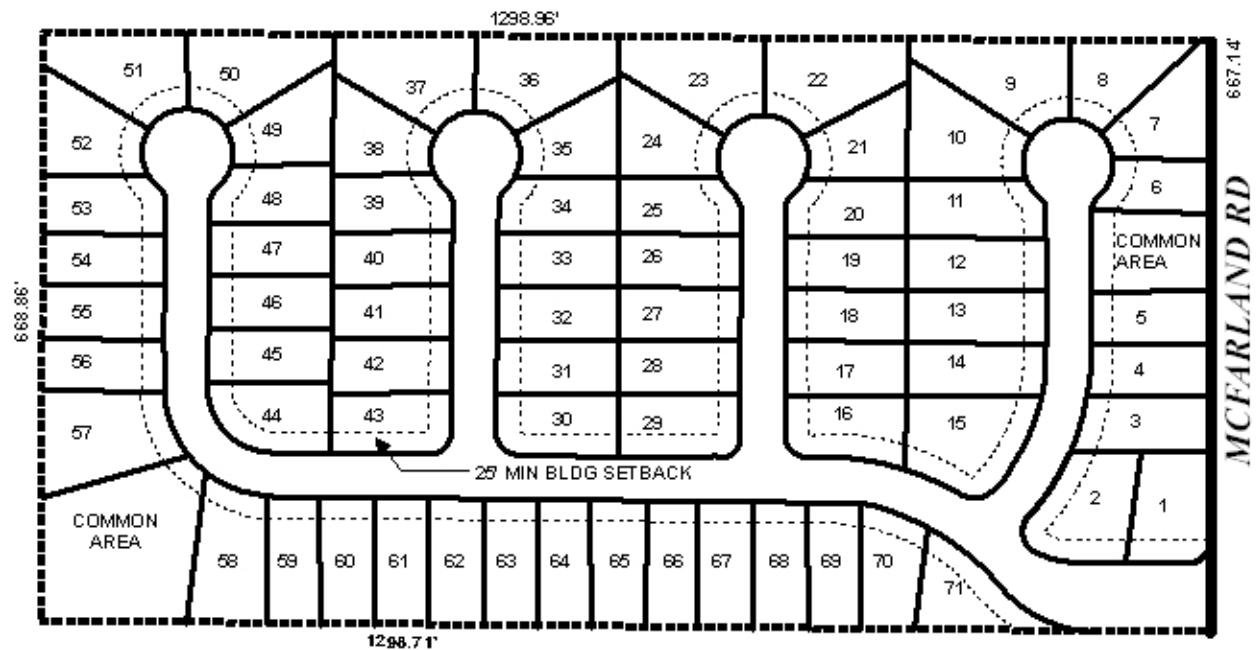

APPLICATION NUMBER 14 DATE August 16, 2007

APPLICANT Maddox Place Subdivision

REQUEST Subdivision



NTS