

LIBERTY SUBDIVISION

This is a request for a one-year extension of a previously approved 262-lot/120.2± acre subdivision. The subdivision is located on the East side of Schillinger Road, 730'± North of Meadows Boulevard extending to the Northern termini of Meadow Drive North, Meadow Dale Drive, Meadow Run Drive, Meadow Height Drive and to the Western terminus of Augustine Drive and is located within the Planning Jurisdiction.

This is the second extension request since the subdivision was originally approved at the Planning Commission's December 15, 2011 meeting. In the Letter of Decision from the first Extension request, which was approved one year later at the Planning Commission's January 3, 2013 meeting, the applicant was advised that future extensions would be unlikely. There have been no changes in conditions in the surrounding area that would affect the subdivision as previously approved; nor have the changes to the Regulations affected the previous approval.

The applicant's justification for a second extension is in "Anticipation for future growth," which was the same justification mentioned for the first extension request.

It should be noted that road construction is required prior to the recording of the subdivision.

RECOMMENDATION Based on the preceding, it is recommended that the request for a one-year extension be Denied.

LOCATOR MAP

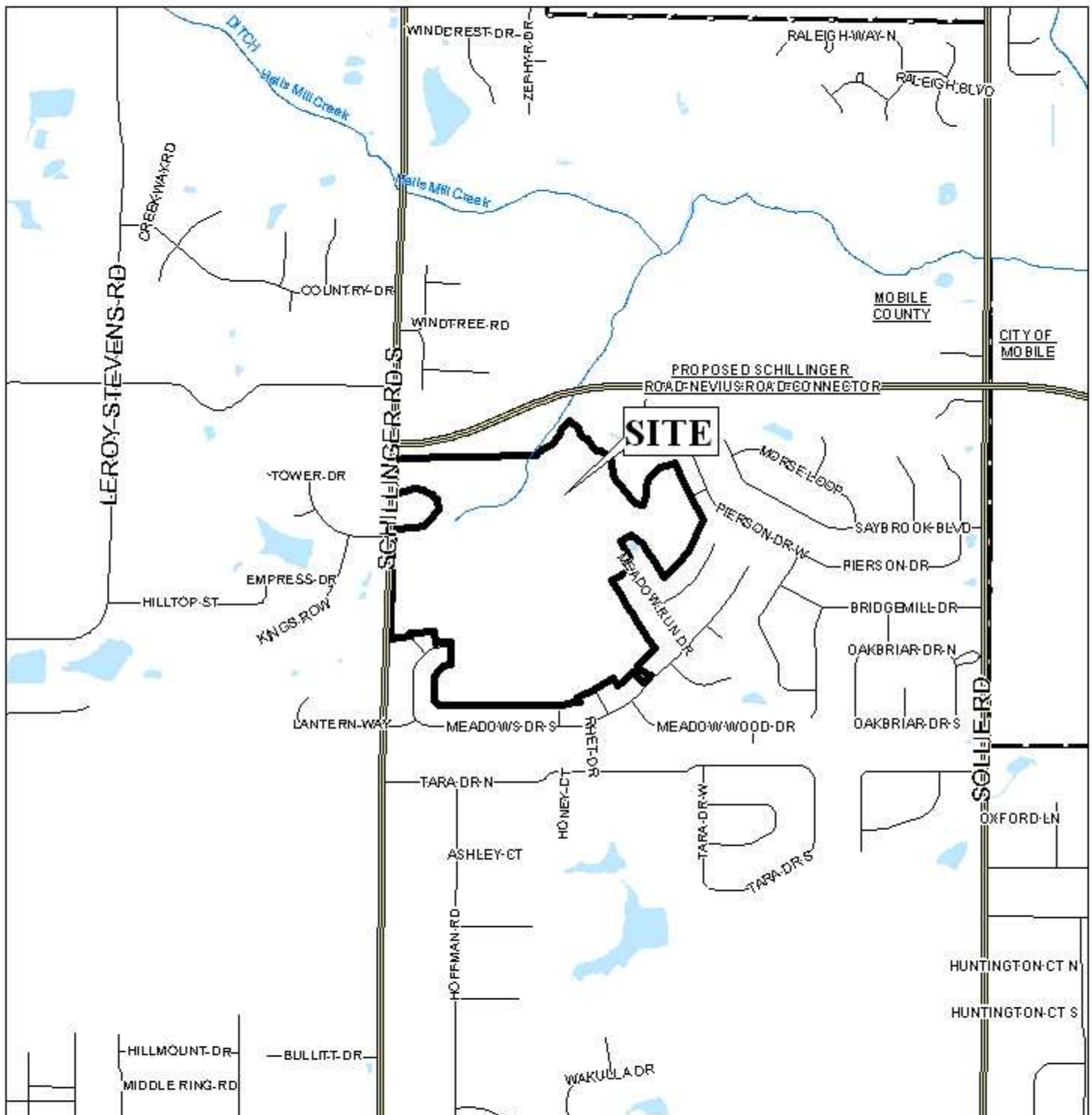

APPLICATION NUMBER 13 DATE January 2, 2014

APPLICANT Liberty Subdivision

REQUEST Subdivision



LIBERTY SUBDIVISION

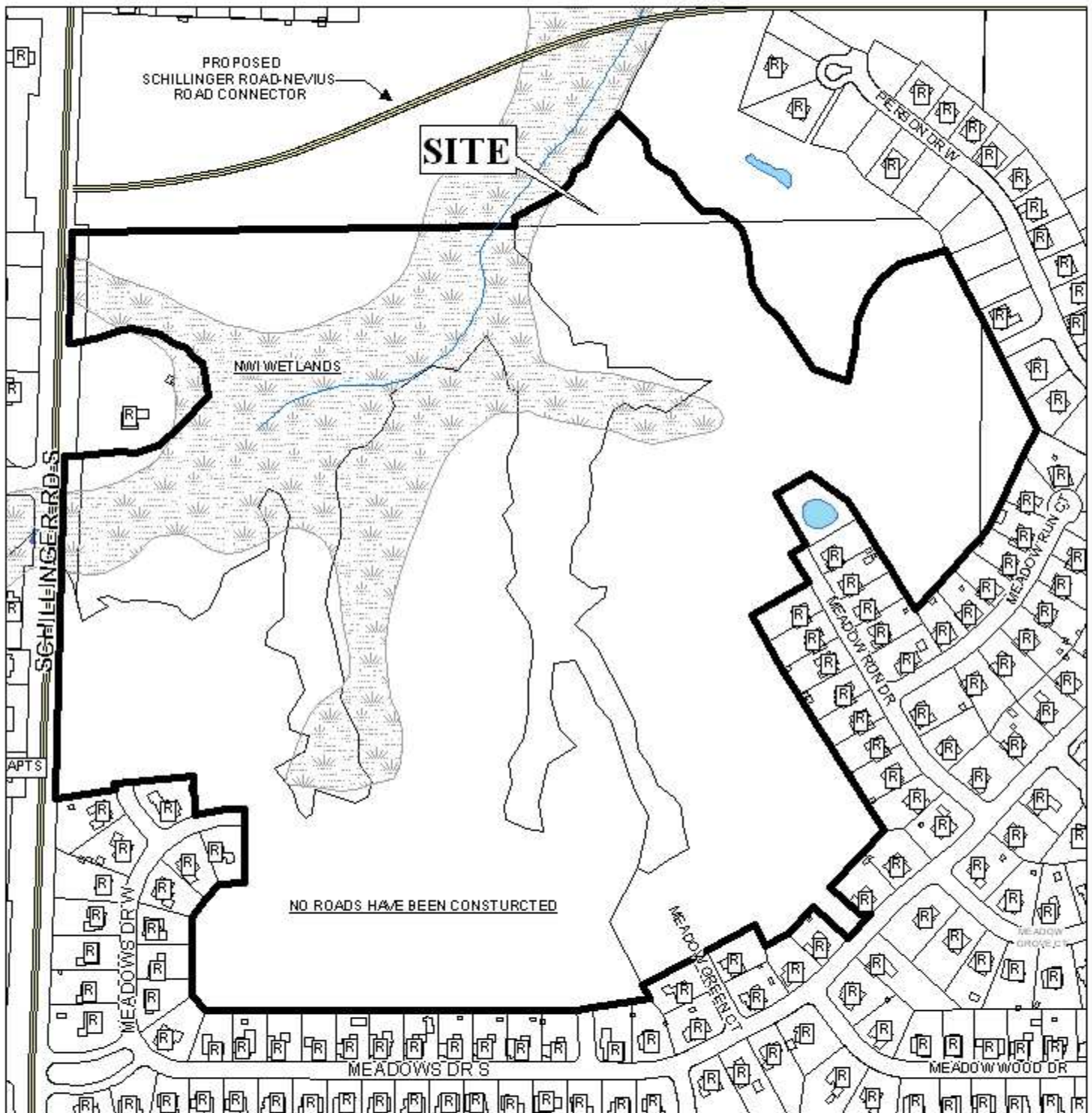

APPLICATION NUMBER 13 DATE January 2, 2014

LEGEND

R-1	R-2	R-3	R-A	R-B	H-B	T-B	B-1	LB-2	B-2	B-3	B-4	B-5	I-1
													I-2

N
NTS

LIBERTY SUBDIVISION



APPLICATION NUMBER 13 DATE January 2, 2014



DETAIL SITE PLAN

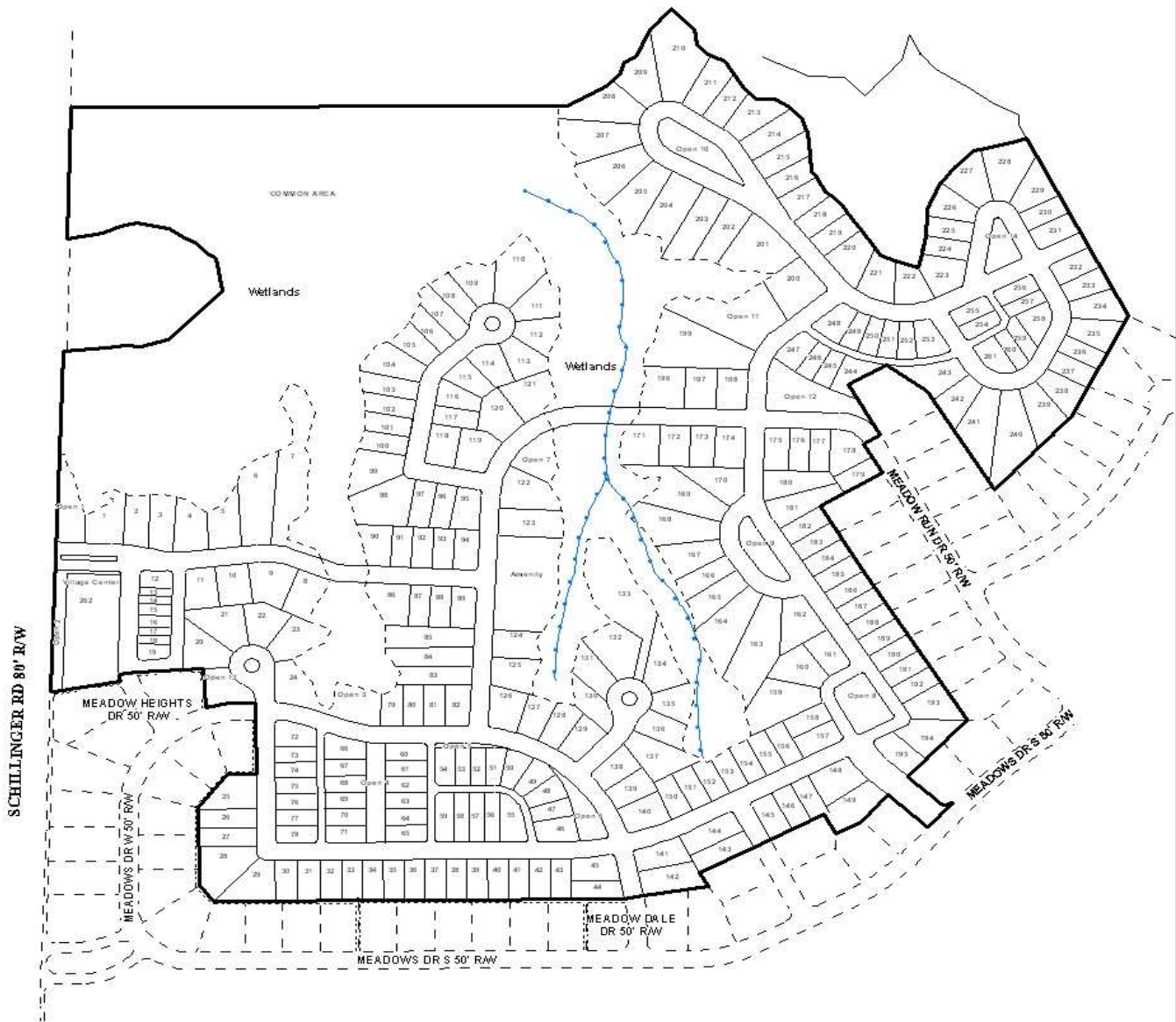

APPLICATION NUMBER 13 DATE January 2, 2014
APPLICANT Liberty Subdivision
REQUEST Subdivision



NTS