

RALEIGH SUBDIVISION

This is a request for a one-year extension of a previously approved 165-lot subdivision. The subdivision is located on the West side of Cody Road, 870'+ south of Wynnfield Boulevard, and extending to the East terminus of Longview Drive.

There have been six extensions since the subdivision was originally approved in 1999 and four units have been recorded, with the last recording being in December 2005. There have been no changes in conditions in the surrounding area that would affect the subdivision as previously approved; nor have there been changes to the Regulations that would affect the previous approval.

The staff recommendation for the 2005 extension request suggested a further extension would be unlikely. However, that suggestion was not included in the Commission's approval, and another extension was approved in 2006. For this extension request, the staff land use survey did not indicate any road construction activity on the remaining portion of the originally-approved subdivision which has been granted previous extensions.

Based on the preceding, it is recommended that this request for extension be denied.

LOCATOR MAP

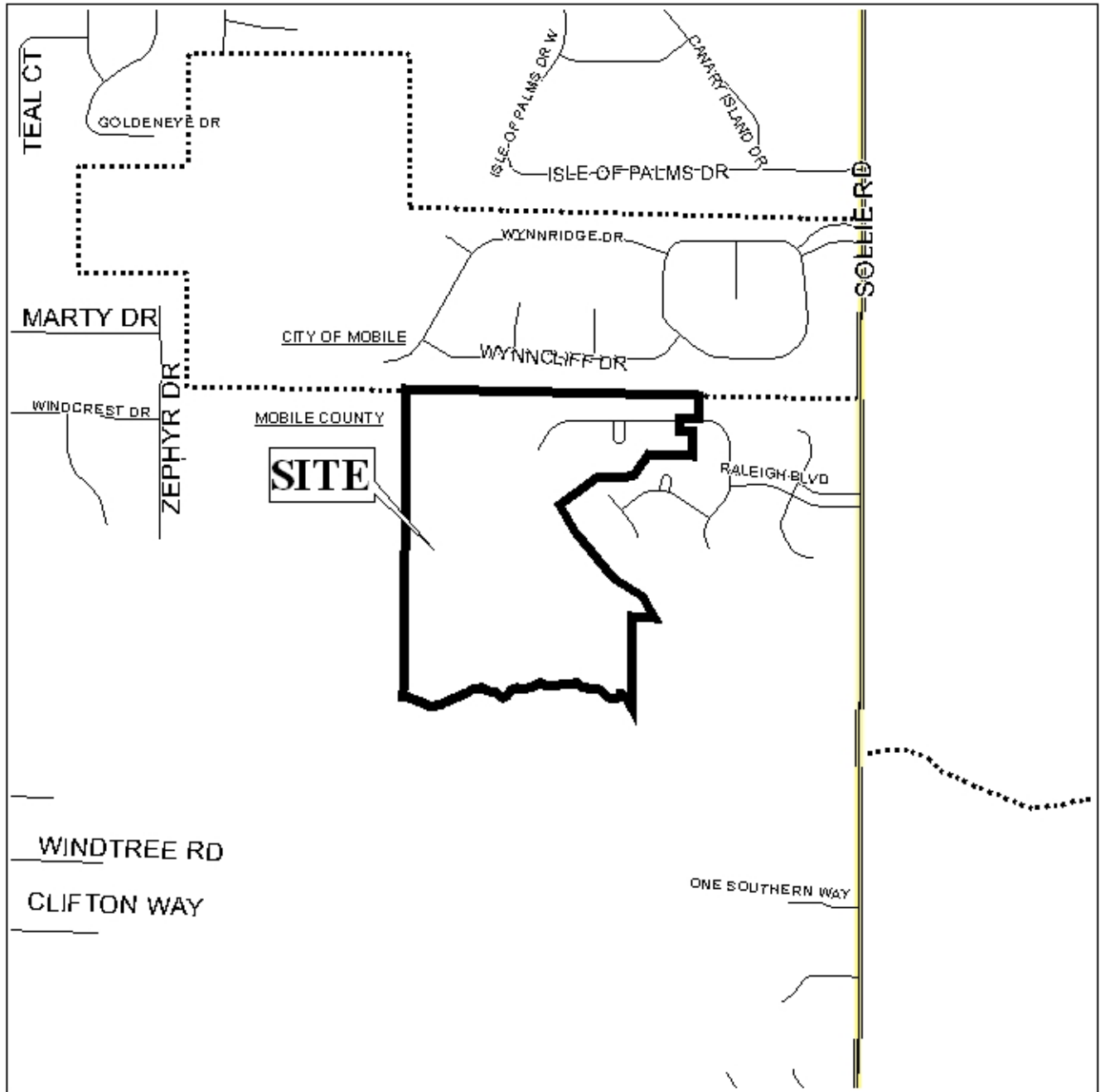

APPLICATION NUMBER 11 DATE December 6, 2007

APPLICANT Raleigh Subdivision

REQUEST Subdivision



NTS

RALEIGH SUBDIVISION

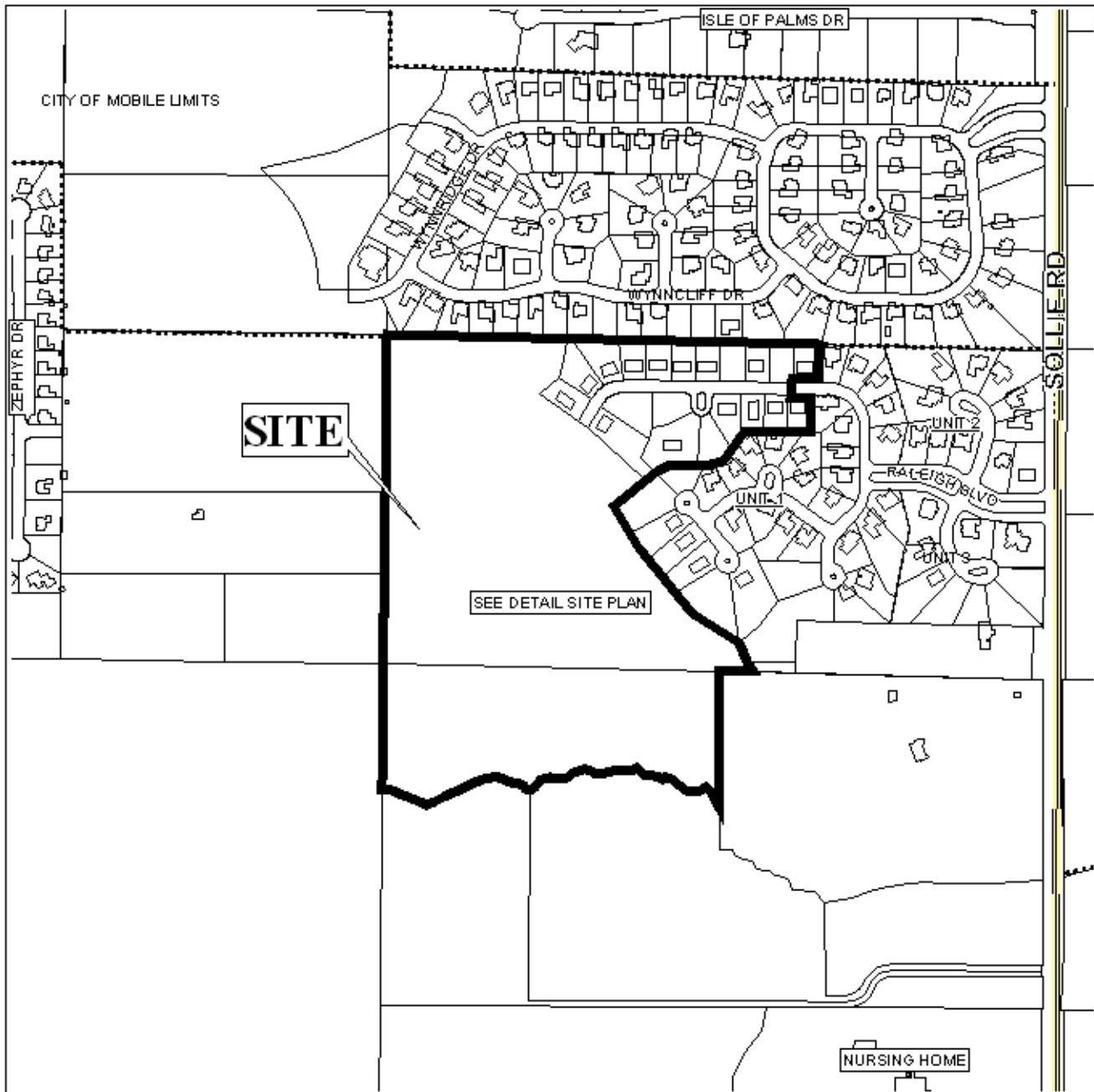

APPLICATION NUMBER 11 DATE December 6, 2007



NTS

DETAIL SITE PLAN

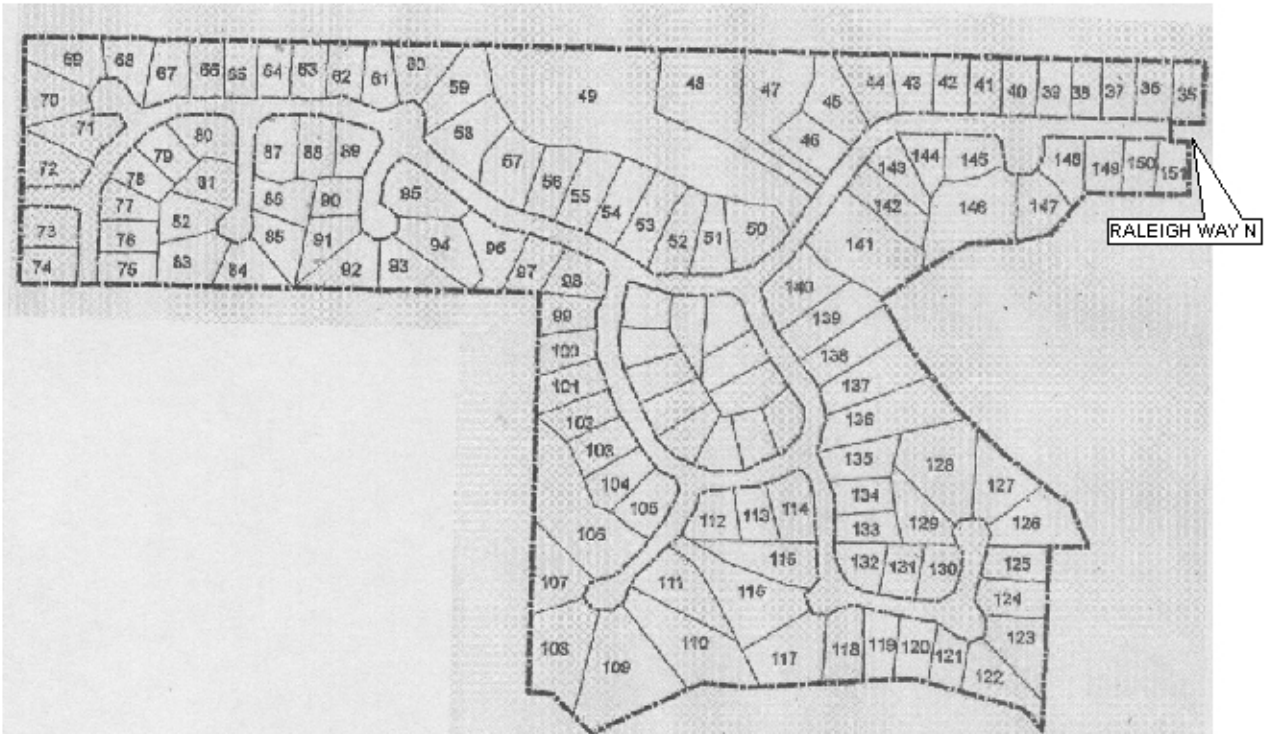

APPLICATION NUMBER 11 DATE December 6, 2007
APPLICANT Raleigh Subdivision
REQUEST Subdivision



NTS