

OLD MILITARY ADDITION TO BELLINGRATH SUBDIVISION, UNIT TWO, RESUBDIVISION OF LOT 4

Engineering Comments: Must comply with the Mobile County Flood Damage Prevention Ordinance.

The plat illustrates the proposed 1.0 ± acres, 2 lot subdivision which is located on the South side of Old Military Road at the South terminus of Gipson Road. The subdivision is served by public water and sewer.

The purpose of this application is to subdivide one lot into two lots.

This site is located in the County, thus a note should be placed on the final plat stating that any lots which are developed commercially, and adjoin residentially developed property, must provide a buffer, in compliance with Section V.A.7. of the Subdivision Regulations.

The plat meets the minimum requirements of the Subdivision Regulations and is recommended for Tentative Approval subject to the following condition: 1) the placement of a note on the final plat stating that if any property is developed commercially, and adjoins residential property, a buffer, in compliance with Section V.A.7. of the Subdivision Regulations will be provided.

LOCATOR MAP

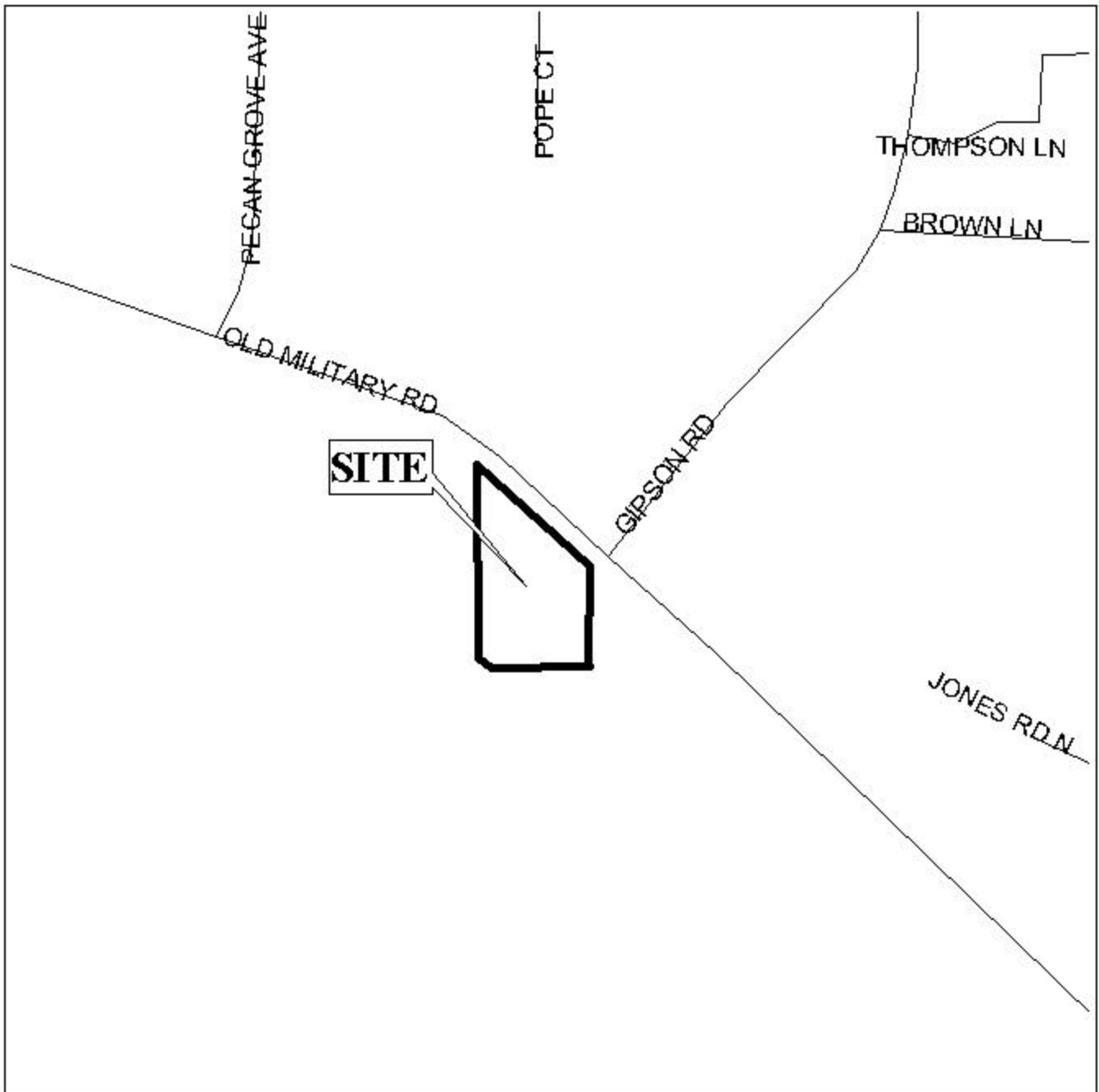

APPLICATION NUMBER 11 DATE April 3, 2003

APPLICANT Old Military Addition to Bellingrath Subdivision, Unit Two, Resubdivision of Lot 4

REQUEST Subdivision



OLD MILITARY ADDITION TO BELLINGRATH SUBDIVISION, UNIT TWO, RESUBDIVISION OF LOT 4

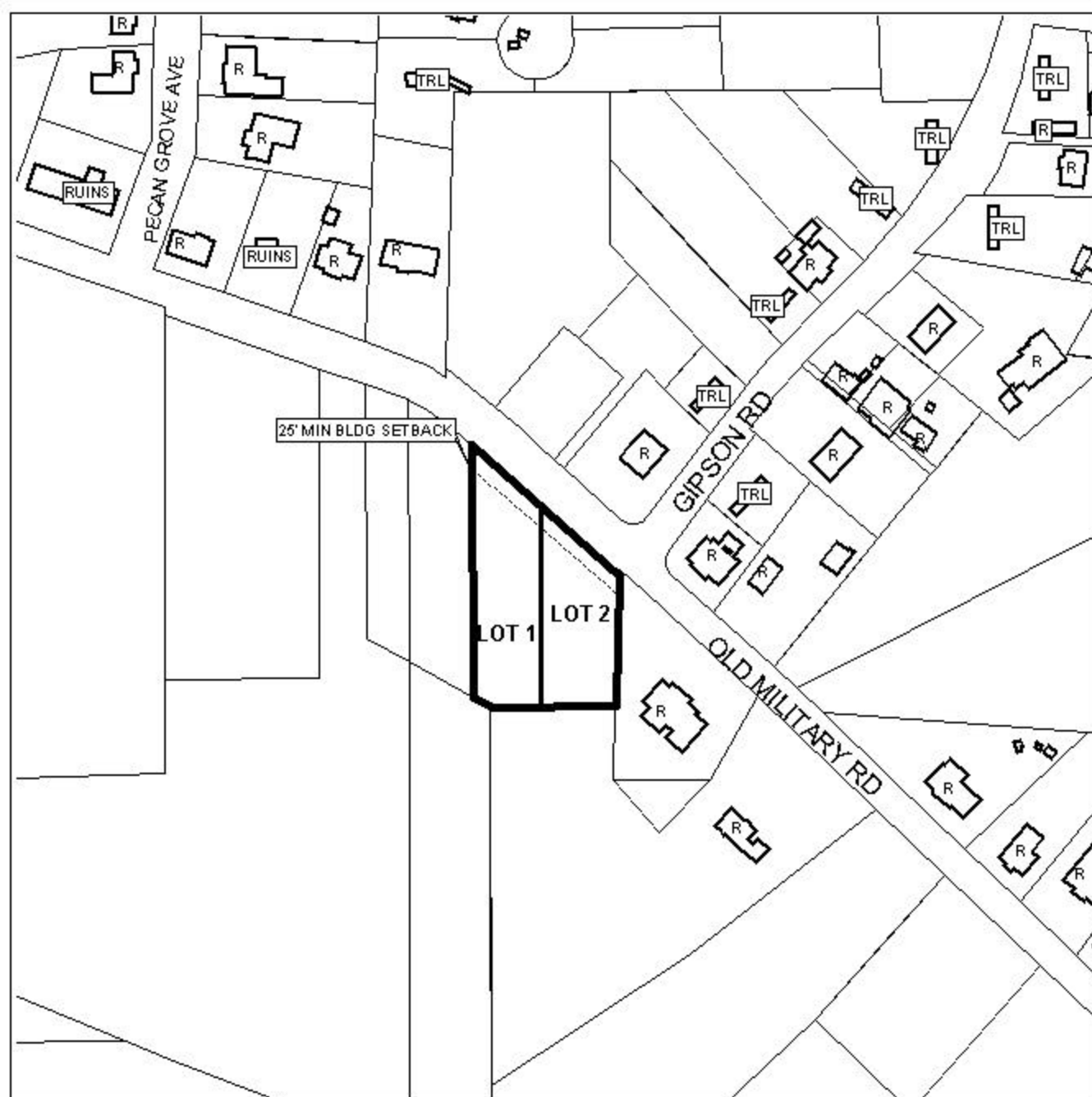

APPLICATION NUMBER 11 DATE April 3, 2003

LEGEND



