

OFFSHORE INLAND SUBDIVISION

Engineering Comments: Must comply with all stormwater and flood control ordinances. Any work performed in the right of way will require a right of way permit. The applicant is responsible for verifying if the site contains wetlands. The site can be checked against the National Wetlands Inventory on the COM web site Environmental Viewer. If the site is included on the NWI, it is the applicant's responsibility to confirm or deny the existence of regulatory wetlands.

Traffic Engineering Comments: Driveway number, sizes, location and design to be approved by Traffic Engineering and conform to AASHTO standards.

Urban Forestry Comments: Property to be developed in compliance with state and local laws that pertain to tree preservation and protection on both city and private properties (State Act 61-929 and City Code Chapters 57 and 64).

The plat illustrates the proposed 3.7± acre, two-lot subdivision, which is located on the South side of Brookdale Drive South at Brookdale Drive West, and is in Council District 1. The site is served by public water and sanitary sewer.

The purpose of the application is to create two lots from four lots of record.

The site fronts Brookdale Drive West and Brookdale Drive South, both of which have 50-foot rights-of-way.

The site is located in the AE floodplain and may be considered environmentally sensitive; therefore approval from all applicable federal, State, and local agencies would be required prior to the issuance of any permits.

The plat meets the minimum standards of the Subdivision Regulations and is recommended for Tentative Approval, subject to the following condition: 1) the approval of all federal, State, and local agencies prior to the issuance of any permits.

LOCATOR MAP

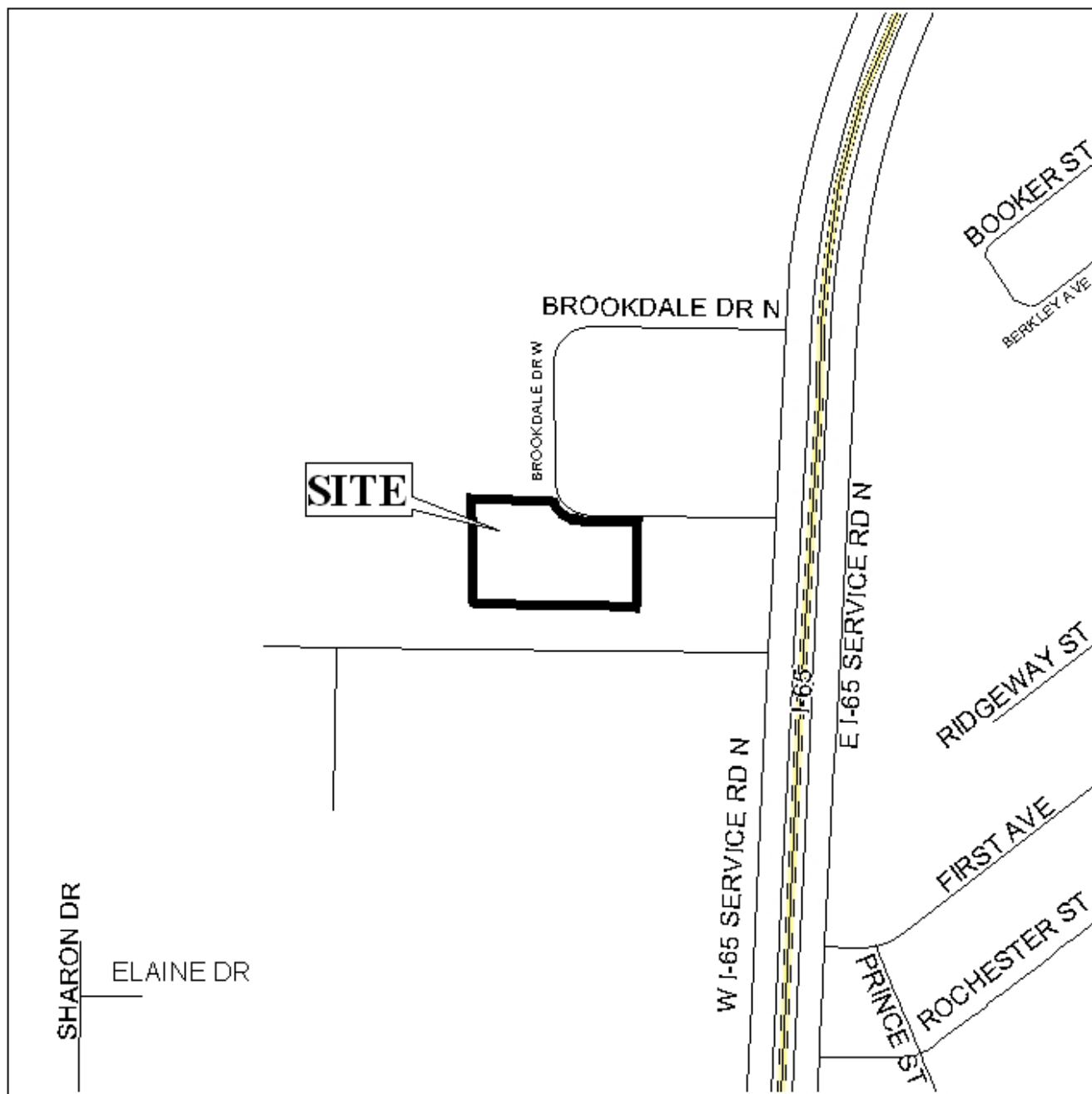

APPLICATION NUMBER 10 DATE June 1, 2006

APPLICANT Offshore Inland Subdivision, Resubdivision of

REQUEST Subdivision



NTS

OFFSHORE ISLAND SUBDIVISION, RESUBDIVISION OF

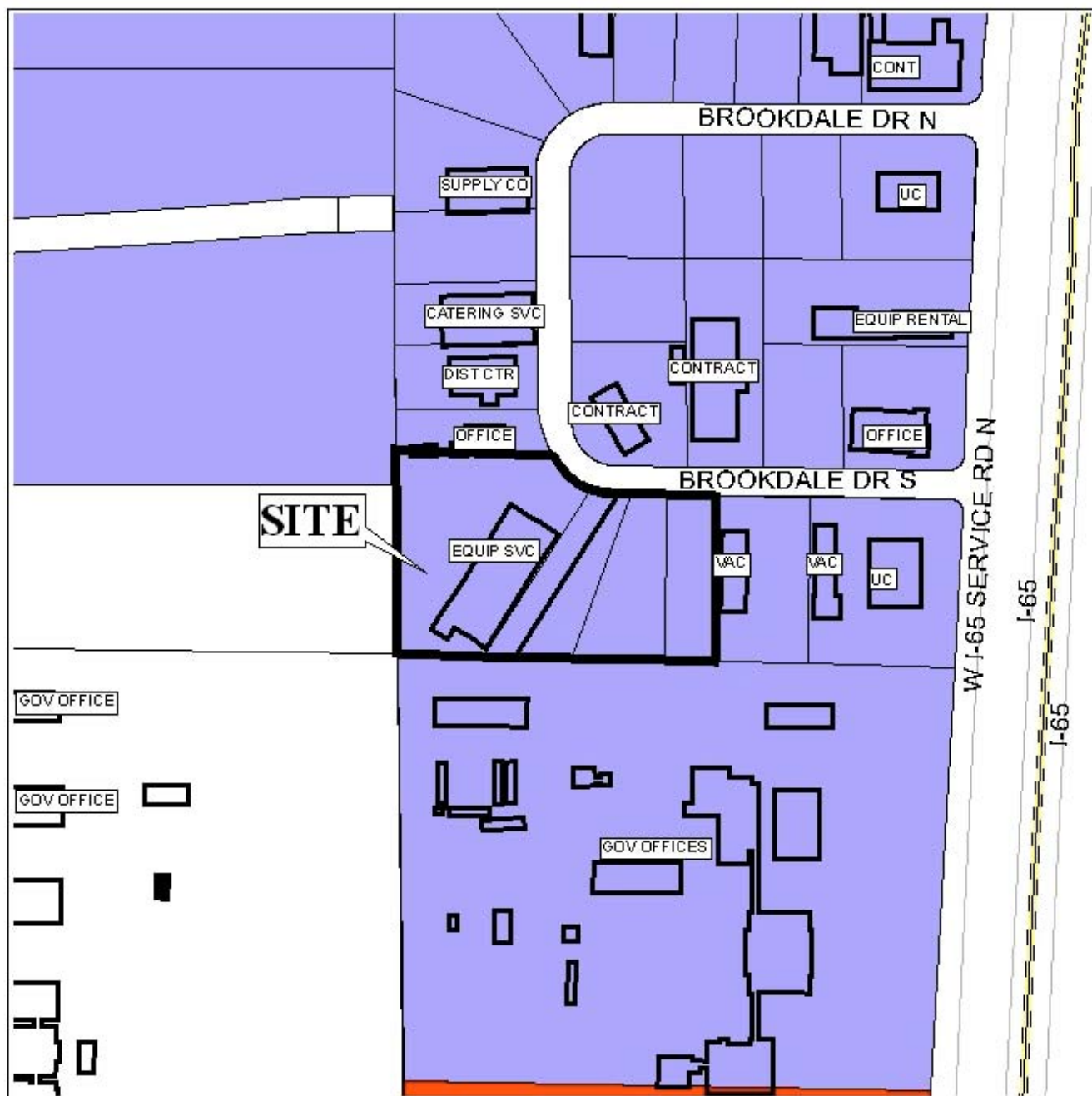

APPLICATION NUMBER 10 DATE June 1, 2006

LEGEND

R-1	R-2	R-3	R-A	R-B	H-B	B-1	LB-2	B-2	B-3	B-4	B-5	I-1	I-2
-----	-----	-----	-----	-----	-----	-----	------	-----	-----	-----	-----	-----	-----



NTS