

WOODLAND GLEN SUBDIVISION

This is a request for a one-year extension of a previously approved 198-lot subdivision. The subdivision is located on the East side of Schillinger Road South, 815'± North of Meadows Boulevard, extending to the North termini of Meadow Heights Drive, Meadow Drive North, Meadow Dale Drive, Meadow Green Drive, and Meadow Run Drive.

This is the first extension request since the subdivision was approved in January, 2007. There have been no changes in the condition of the surrounding area(s), nor have there been any changes to the regulations, that would affect the previous approval.

Based on the preceding, it is recommended that this request for extension be approved.

LOCATOR MAP

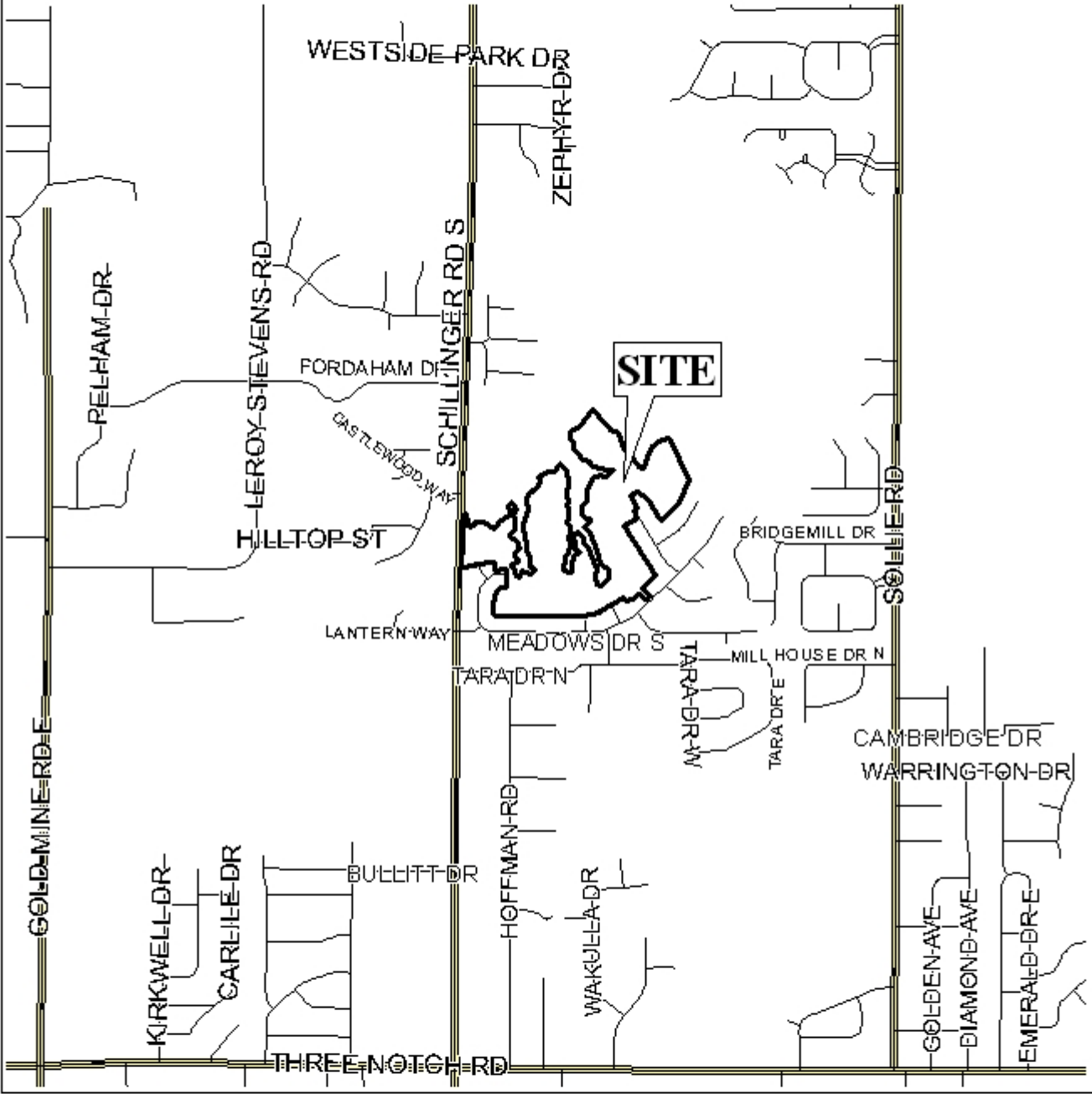

APPLICATION NUMBER 10 DATE January 17, 2008

APPLICANT Woodland Glen Subdivision

REQUEST _____ Subdivision _____



NTS

WOODLAND GLEN SUBDIVISION

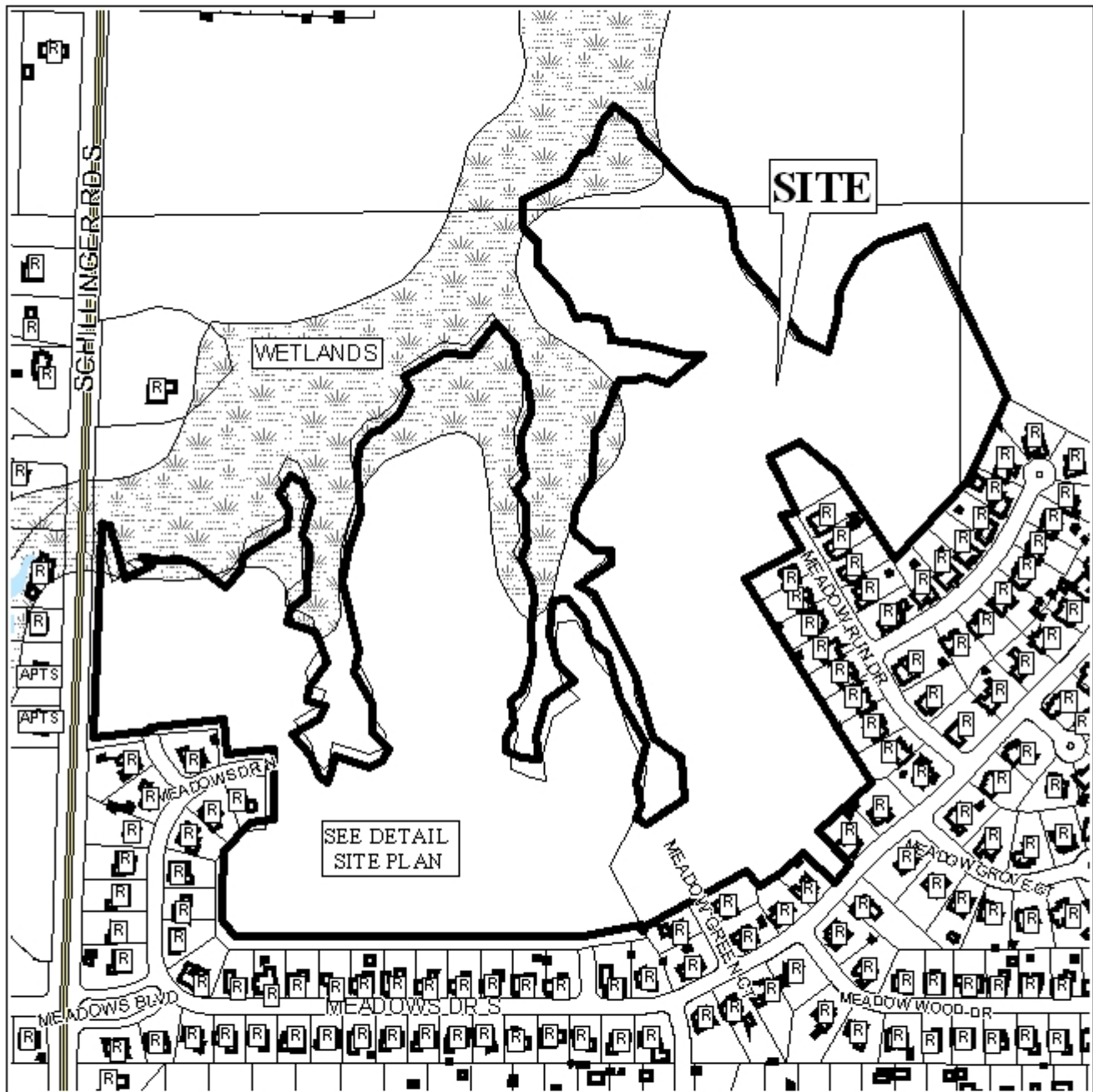

APPLICATION NUMBER 10 DATE January 17, 2008

LEGEND

R-1	R-2	R-3	R-A	R-B	H-B	T-B	B-1	LB-2	B-2	B-3	B-4	B-5	I-1	I-2
-----	-----	-----	-----	-----	-----	-----	-----	------	-----	-----	-----	-----	-----	-----



NTS

DETAIL SITE PLAN

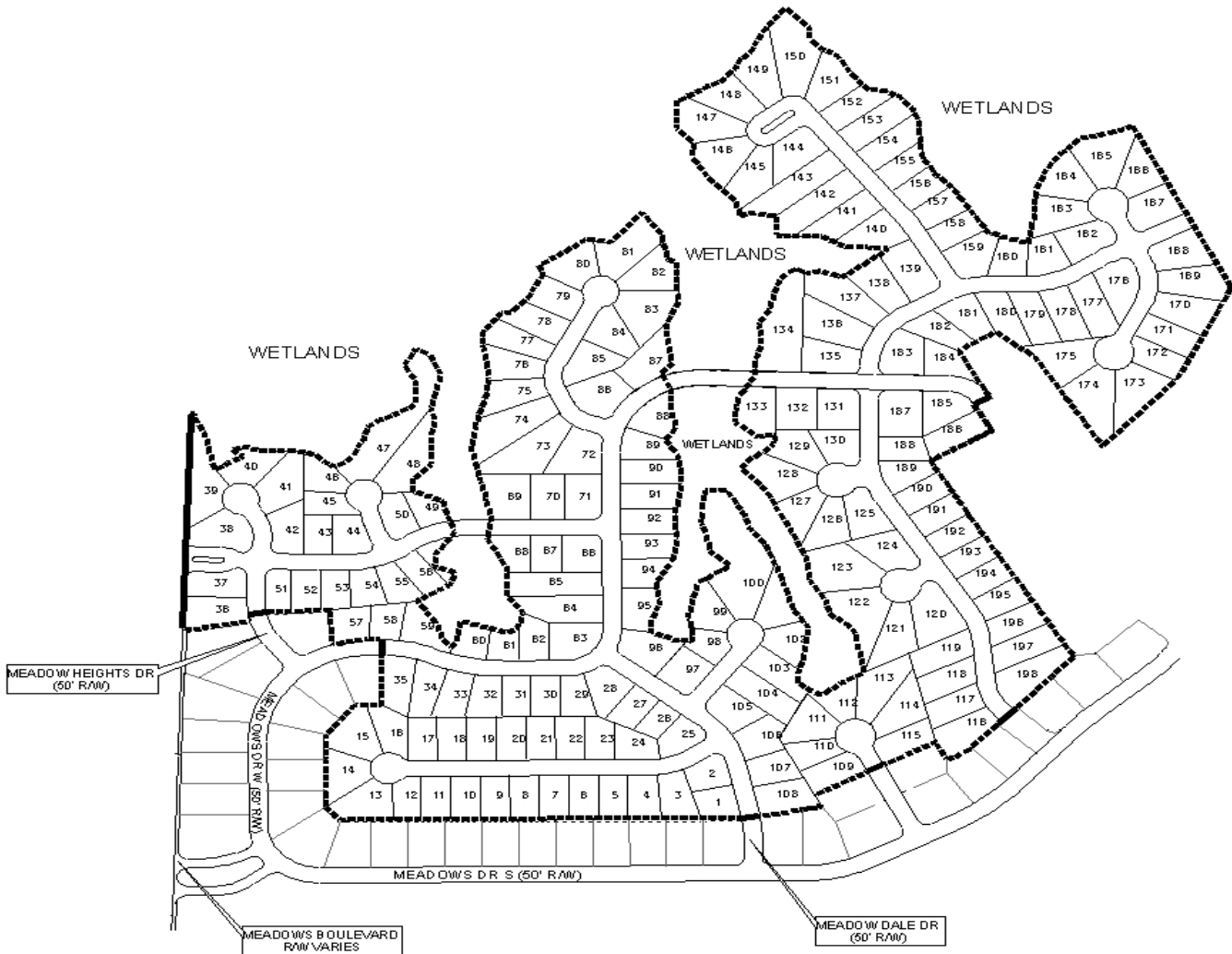

APPLICATION NUMBER 10 DATE January 17, 2008

APPLICANT Woodland Glen Subdivision

REQUEST Subdivision



NTS