

PLANNING APPROVAL STAFF REPORT**Date: August 4, 2011****NAME**

The Wooden Boat Ministry

LOCATION360 Rapier Avenue
(Northwest corner of Rapier Avenue and Texas Street)**CITY COUNCIL
DISTRICT**

District 2

PRESENT ZONING

R-1, Single-Family Residential District

AREA OF PROPERTY1 Lot / 0.1 \pm Acre**CONTEMPLATED USE**

Planning Approval to allow a boat building apprenticeship Christian ministry in an R-1, Single-Family Residential District.

**TIME SCHEDULE
FOR DEVELOPMENT**

Upon approval.

**ENGINEERING
COMMENTS**

Must comply with all storm water and flood control ordinances. Any increase in impervious area in excess of 4,000 square feet will require detention. Any work performed in the right of way will require a right of way permit. Drainage from any dumpster pads cannot discharge to storm sewer; must have connection to sanitary sewer.

**TRAFFIC ENGINEERING
COMMENTS**

Driveway number, size, location, and design to be approved by Traffic Engineering and ALDOT and conform to AASHTO standards.

**URBAN FORESTRY
COMMENTS**

Property to be developed in compliance with state and local laws that pertain to tree preservation and protection on both city and private properties (State Act 61-929 and City Code Chapters 57 and 64).

**FIRE DEPARTMENT
COMMENTS**

All projects within the City of Mobile Fire Jurisdiction must comply with the requirements of the 2009 International Fire Code, as adopted by the City of Mobile.

REMARKS

The applicant is requesting Planning Approval to allow a boat building apprenticeship Christian ministry in an R-1, Single-Family Residential District.

Since the activity is church-sponsored, Planning Approval is required in an R-1 District. The actual use as a boat-building operation and vocational/trade school is the subject of a Use Variance request before the Board of Zoning Adjustment, as well as Parking Ratio and Landscaping and Tree Planting Variances.

The subject site pre-dates the Zoning Ordinance and was originally built as a neighborhood grocery/retail store and used for such and various other commercial purposes until losing its legal nonconforming commercial status in 1985. It was used as a furniture, antique and collectibles shop for a short period following the granting of a Use Variance in 2005. The applicant proposes to use the building primarily as a vocational/trade school for at-risk youth with instruction in building trades focusing on traditional wooden boat construction. Students would be in the program from a variety of scenarios including voluntary admittance, court ordering, or voluntary court option as an alternative to incarceration. Classes would be from 8:00 AM to 5:00 PM on Friday, Saturday and Sunday until approximately 2012 when the operation would be Monday through Friday if further staff is obtained. Mornings would be devoted to classroom instruction and afternoons would be for working on boats. There would be no more than twelve students enrolled at a time. Standard woodworking hand and power tools would be employed and a dust collection vacuum system would serve the stationary power tools. It is also stated that there will be no spraying of paints or varnishes as all applications of such would be via brush or roller.

It is stated that vehicular traffic to the facility would consist of the instructor and student vehicles, possibly two trucks per month delivering supplies, and possibly two customers per week. As the site has no on-site parking, the Parking Ratio Variance is required and over-flow off-site parking is proposed at businesses on Government Street and Michigan Avenue (several blocks away), although an application for an Off-Site Parking Variance has not been submitted.

The review required for Planning Approval examines the applicant's location and site plan with regard to transportation, parking and access, public utilities and facilities, traffic congestion and hazard, and to determine if the proposal is in harmony with the orderly and appropriate development of the district.

It is very important to note that the Planning Approval review is site plan specific; therefore *any* future changes to the site plan or to the scope of operations for the church, as approved, by current or future applicants must be submitted for Planning Approval.

The subject site is embedded in an area where all active land uses are residential. As proposed, the project could create some parking congestion concerns and traffic congestion concerns when boats are moved into and out of the facility directly on the public right-of-way. But the primary concern is that this activity, although church-sponsored, is quite different from the norm of church activities within R-1 districts. Unlike congregational activities such as regular services, prayer meetings, and social functions, the proposed activity is centered on vocation and trades instruction and commercial building of boats. Albeit churches provide a high degree of leadership and guidance to at-risk youth in society within core residential neighborhoods, the proposed activity is outside of what is normally provided by a church and well beyond what would normally be found within a residential neighborhood. Although the program is very well-

intended, given the nature of the proposed students, the activity would be out of character with the residential neighborhood.

RECOMMENDATION:

Planning Approval: Based upon the preceding, this application is recommended for denial.

LOCATOR MAP



APPLICATION NUMBER 9 DATE August 4, 2011

APPLICANT The Wooden Boat Ministry

REQUEST Planning Approval



PLANNING COMMISSION VICINITY MAP - EXISTING ZONING



There are multi-family residential units to the north and east of the site,
and single family residential units to the west and south.

APPLICATION NUMBER 9 DATE August 4, 2011

APPLICANT The Wooden Boat Ministry

REQUEST Planning Approval

LEGEND

R-1	R-2	R-3	R-A	R-B	H-B	T-B	B-1	LB-2	B-2	B-3	B-4	B-5	I-1	I-2
-----	-----	-----	-----	-----	-----	-----	-----	------	-----	-----	-----	-----	-----	-----



PLANNING COMMISSION VICINITY MAP - EXISTING ZONING



There are multi-family residential units to the north and east of the site,
and single family residential units to the west and south.

APPLICATION NUMBER 9 DATE August 4, 2011

APPLICANT The Wooden Boat Ministry

REQUEST Planning Approval

N
NTS

SITE PLAN

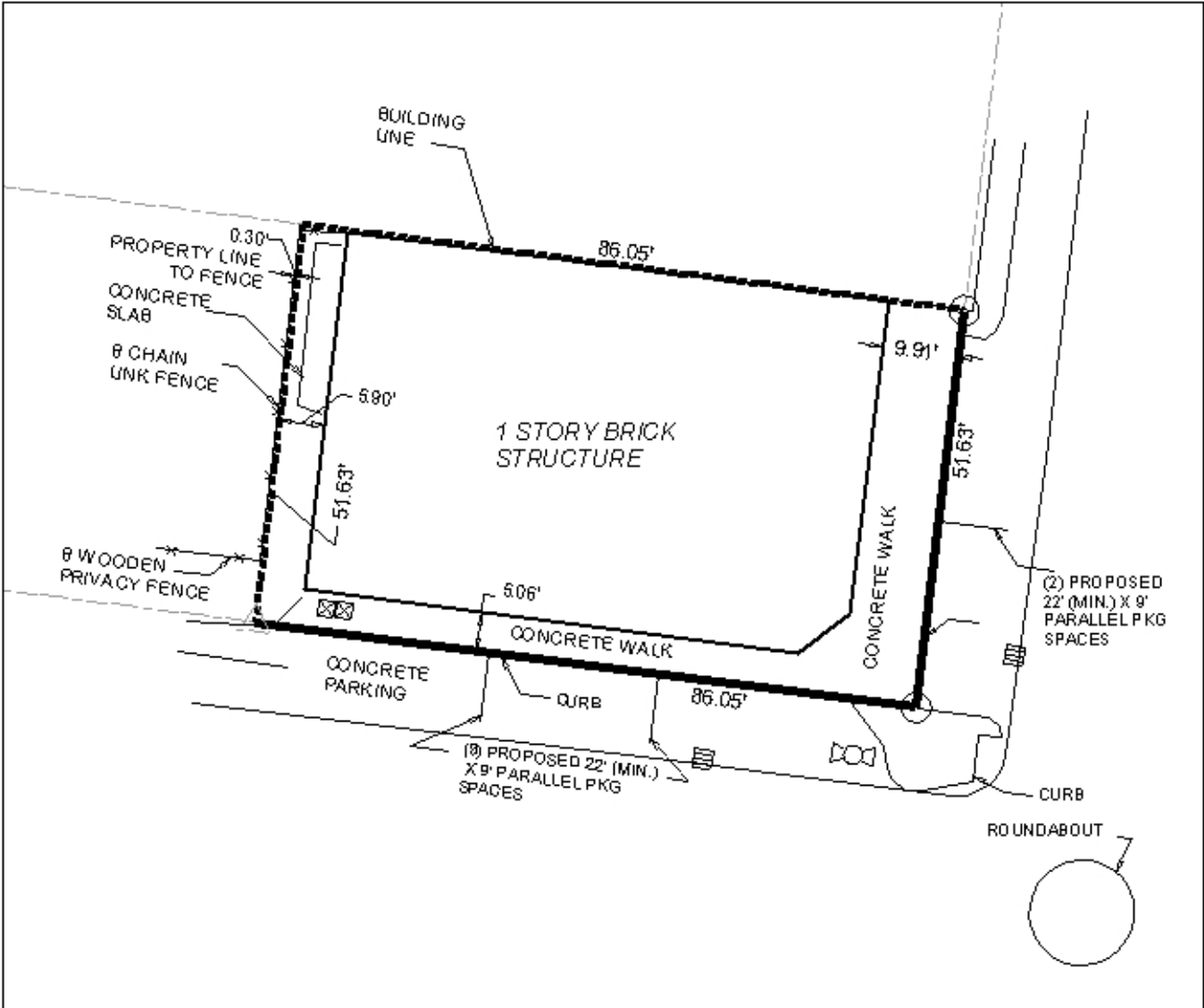

The site plan illustrates the existing building, parking, and fence.

APPLICATION NUMBER 9 DATE August 4, 2011 N

APPLICANT The Wooden Boat Ministry

REQUEST _____ Planning Approval _____

