

MOBILE MEDICAL GROUP SUBDIVISION

This is a request for a one-year extension of a previously approved 1-lot subdivision. The subdivision is located on the South side of Airport Boulevard, between Wildwood and Pinemont Avenues.

There has been one extension granted since the subdivision was originally approved on October 6, 2005. There have been no changes in the surrounding area that would affect the subdivision as previously approved, nor have there been any changes to the regulations that would affect the previous approval.

No indication of permitting or plan submittal activity for the site has been found.

Based on the preceding, it is recommended that this request for extension be approved, but the applicant is advised that, without permitting or plan review activity for the site, no further extensions are likely.

LOCATOR MAP



APPLICATION NUMBER 9 DATE October 4, 2007

APPLICANT Mobile Medical Group Subdivision

REQUEST Subdivision



NTS

PLANNING COMMISSION VICINITY MAP - EXISTING ZONING

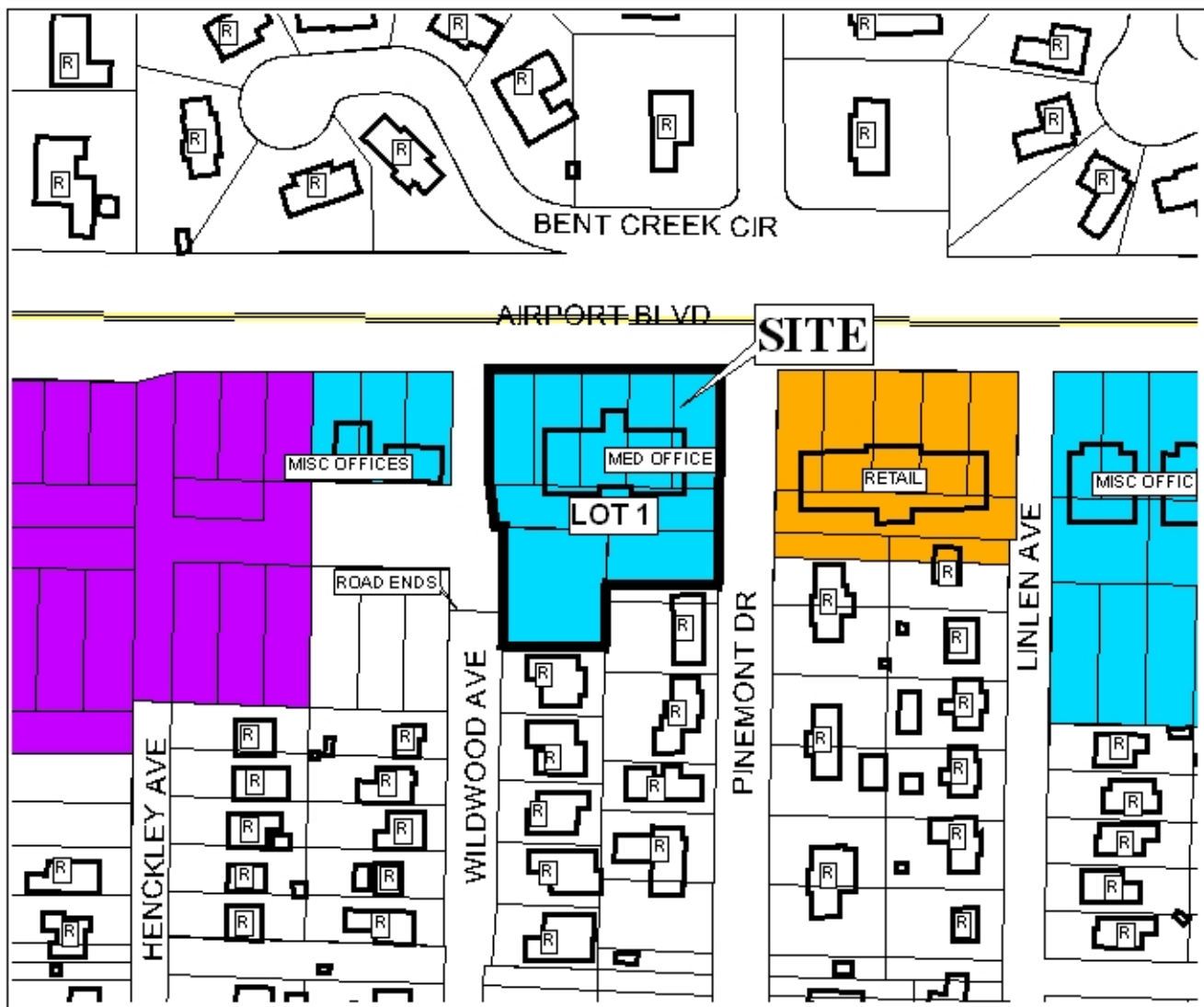

The site is surrounded by single-family residential units.
Commercial sites are located to the east and west to the site.

APPLICATION NUMBER 9 DATE October 4, 2007

APPLICANT Mobile Medical Group Subdivision

REQUEST Subdivision

LEGEND

R-1	R-2	R-3	R-A	R-B	H-B	T-B	B-1	LB-2	B-2	B-3	B-4	B-5	I-1	I-2	NTS
-----	-----	-----	-----	-----	-----	-----	-----	------	-----	-----	-----	-----	-----	-----	-----

