

WMSHC SUBDIVISION

This is a request for a one-year extension of a previously approved 1-lot subdivision. The subdivision is located on the East side of Hillcrest Road, 625'± South of Cedar Bend Court.

This is the first extension request since the subdivision was originally approved in 2007. There have been no changes in conditions in the surrounding area that would affect the subdivision as previously approved; nor have the changes to the Regulations affected the previous approval.

It should be noted that the applicant has applied for a building permit but was unable to obtain one due to an incomplete subdivision process.

Based on the preceding, it is recommended that this request for extension be approved and that the applicant be advised that future extensions will be unlikely.

LOCATOR MAP



APPLICATION NUMBER 7 DATE August 7, 2008
APPLICANT WMSHC Subdivision
REQUEST Subdivision



PLANNING COMMISSION VICINITY MAP - EXISTING ZONING

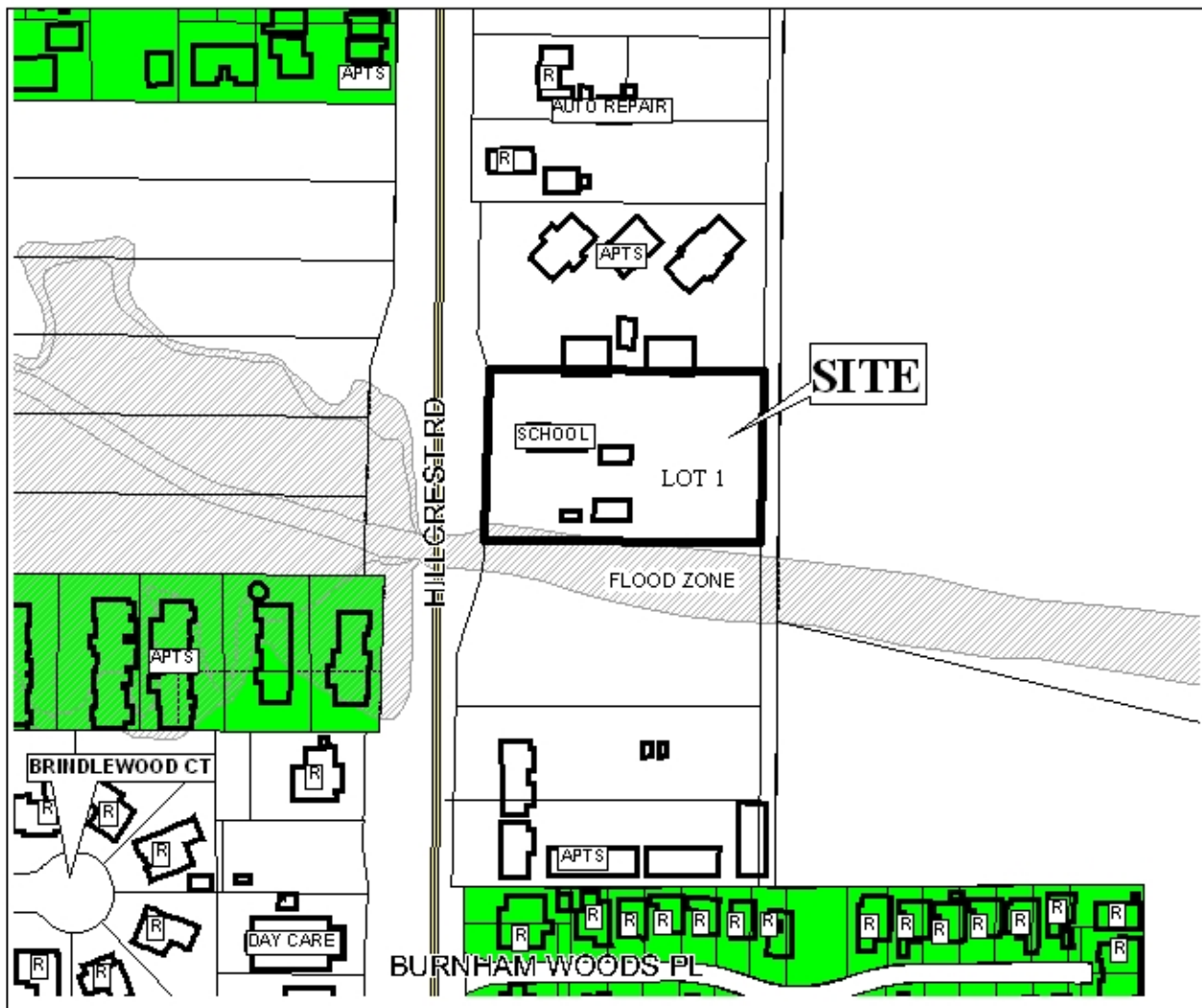

Apartments are to the north, west, and south of site and single family residential units are to the north and southwest.

APPLICATION NUMBER 7 DATE August 7, 2008

APPLICANT WMSHC Subdivision

REQUEST Subdivision

LEGEND

R-1	R-2	R-3	R-A	R-B	H-B	T-B	B-1	LB-2	B-2	B-3	B-4	B-5	I-1	I-2
-----	-----	-----	-----	-----	-----	-----	-----	------	-----	-----	-----	-----	-----	-----

NTS



SITE PLAN

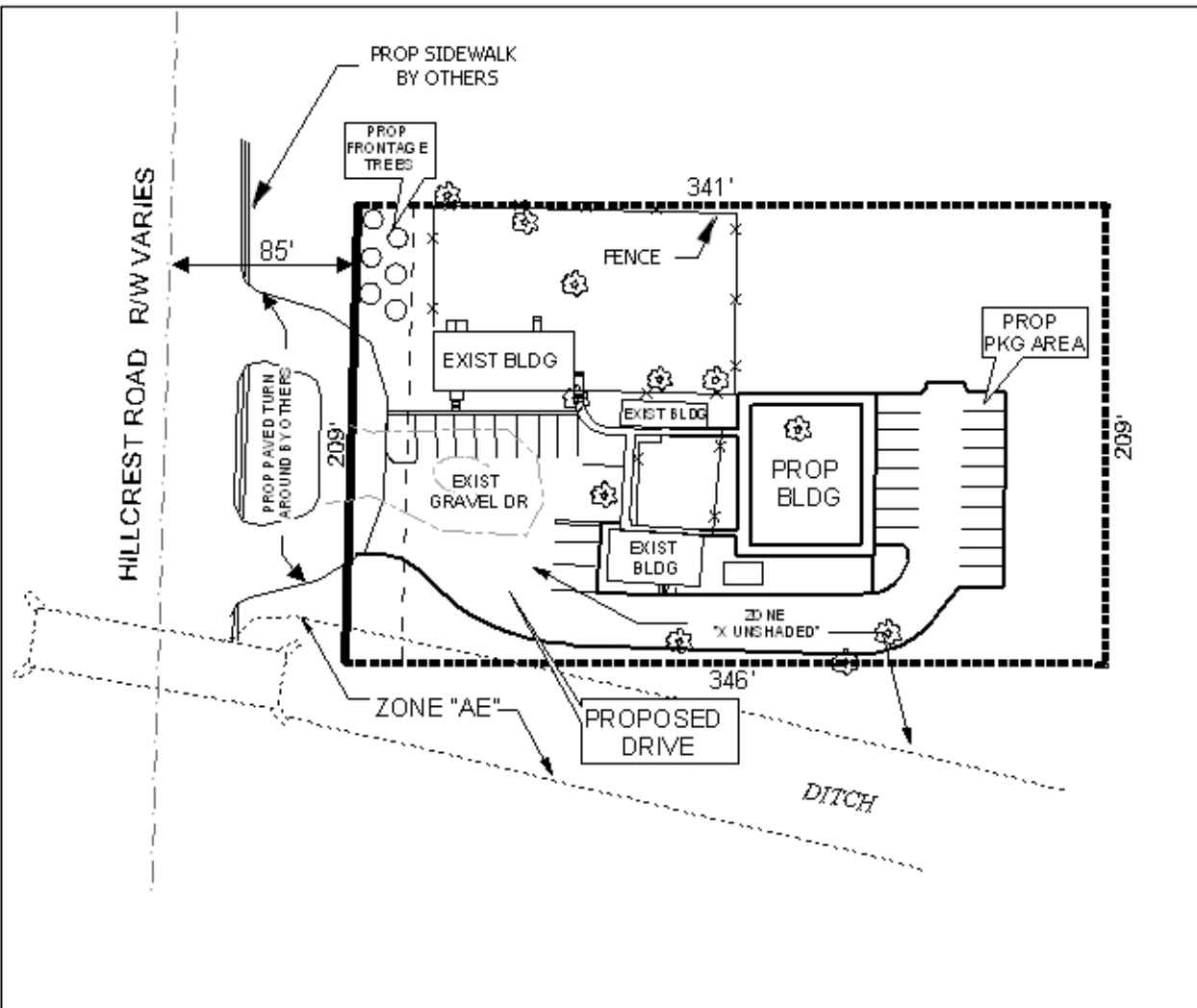

The site plan illustrates the proposed building, existing buildings, proposed drive, and fences.

APPLICATION NUMBER 7 DATE August 7, 2008
 APPLICANT WMSHC Subdivision
 REQUEST Subdivision



NTS