

**NORTH RIDGELAWN SUBDIVISION**  
**RESUBDIVISION OF AND ADDITION TO LOT 13**

This is a request for a one-year extension of a previously approved 2-lot subdivision. The subdivision is located on the West side of Ridgelawn Drive East, 330'± South of Woodhill Circle.

There have been no extensions since the subdivision was originally approved on February 21, 2008, and no units have been recorded. There have been no changes in the condition of the surrounding area(s) that would affect the subdivision as previously approved, nor have there been any changes to the regulations that would affect the previous approval.

Based on the preceding, it is recommended that this request for extension be approved.

# LOCATOR MAP

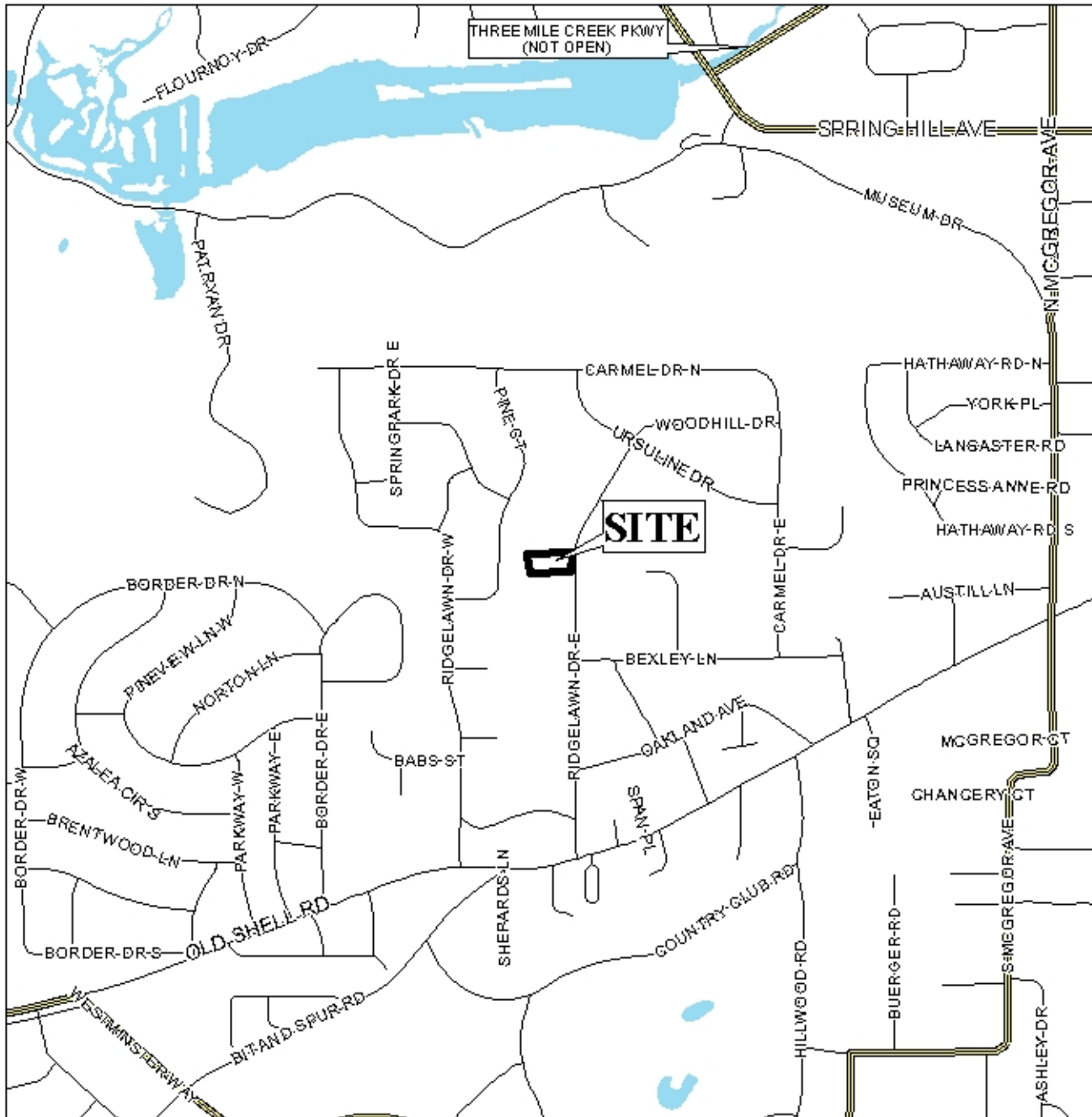

APPLICATION NUMBER 7 DATE February 19, 2009

APPLICANT North Ridgelawn Subdivision,  
Resubdivision of and Addition to Lot 13

REQUEST Subdivision



NTS

# NORTH RIDGELAWN SUBDIVISION, RESUBDIVISION OF AND ADDITION TO LOT 13



APPLICATION NUMBER 7 DATE February 19, 2009

LEGEND

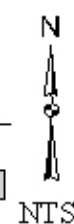
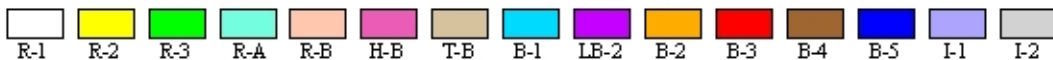



**NORTH RIDGELAWN SUBDIVISION,  
RESUBDIVISION OF AND ADDITION TO LOT 13**



APPLICATION NUMBER 7 DATE February 19, 2009

