

WOODLAND GLEN SUBDIVISION

This is a request for a one-year extension of a previously approved 275-lot subdivision. The subdivision is located at the Eastern terminus of Meadow Drive North, extending to the Northern terminus of Meadow Heights Drive, the Northern terminus of Meadow Run Drive, and the Northern terminus of Meadow Dale Drive and Meadow Green Court, extending to the Western terminus of Augustine Drive.

This is the first extension request since the subdivision was originally approved on October 15, 2009. No lots have been recorded, and road construction has not begun.

There have been no changes in the condition of the surrounding area(s) that would affect the subdivision as previously approved, and there have been no changes to the regulations that would affect the previous approval.

Based on the preceding, it is recommended that this request for extension be approved.

LOCATOR MAP

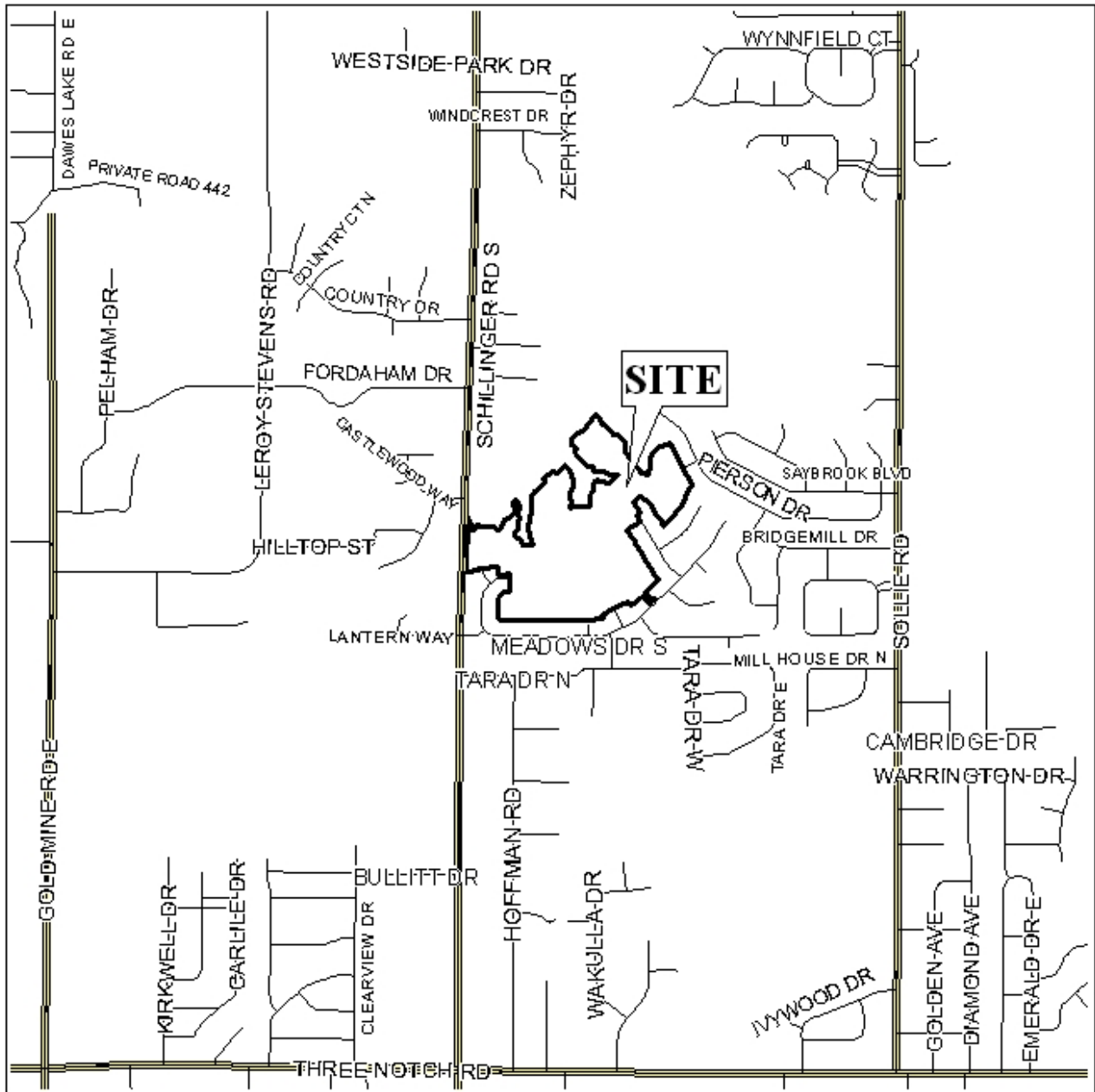

APPLICATION NUMBER 6 DATE October 7, 2010

APPLICANT Woodland Glen Subdivision

REQUEST Subdivision



NTS

WOODLAND GLEN SUBDIVISION

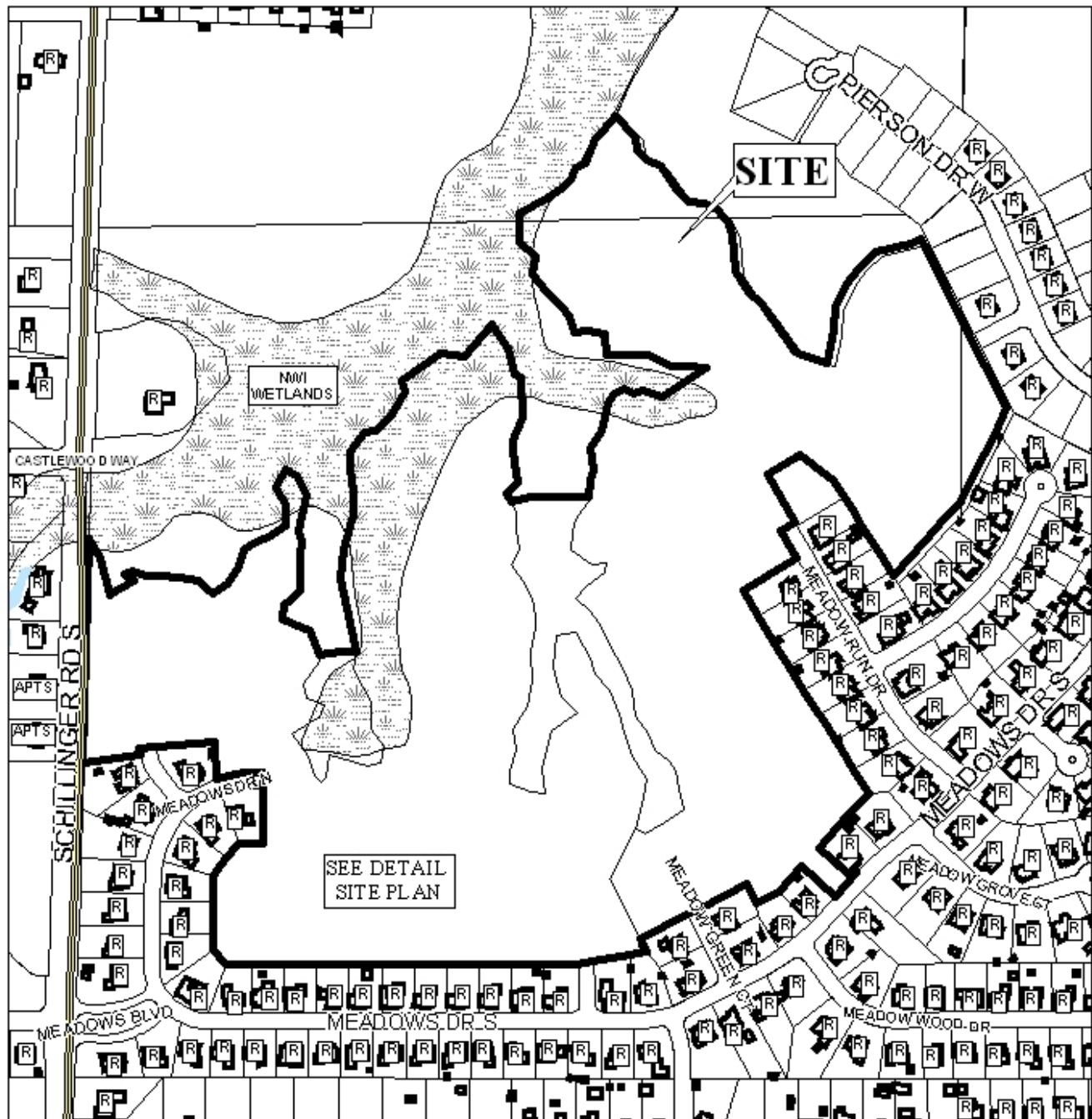

APPLICATION NUMBER 6 DATE October 7, 2010

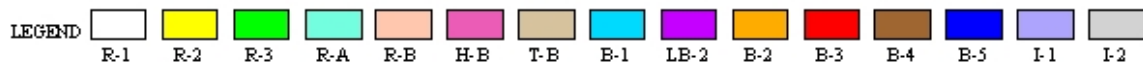

WOODLAND GLEN SUBDIVISION



APPLICATION NUMBER 6 DATE October 7, 2010



DETAIL SITE PLAN

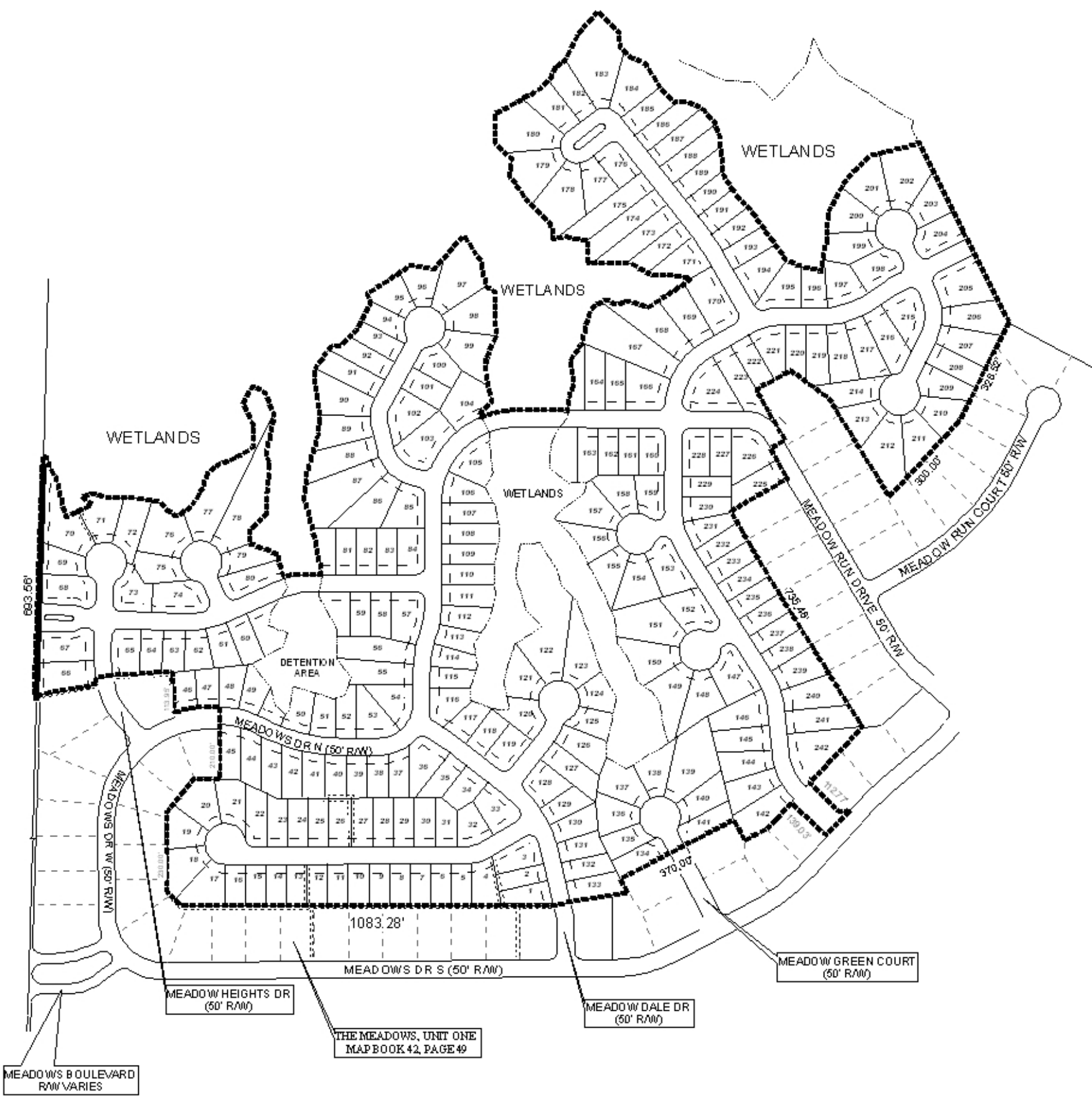

APPLICATION NUMBER 6 DATE October 7, 2010
APPLICANT Woodland Glen Subdivision
REQUEST Subdivision

