

LIBERTY SUBDIVISION

This is a request for a one-year extension of a previously approved 262-lot/120.2± acre subdivision. The subdivision is located on the East side of Schillinger Road, 730'± North of Meadows Boulevard extending to the Northern termini of Meadow Drive North, Meadow Dale Drive, Meadow Run Drive, Meadow Height Drive and to the Western terminus of Augustine Drive and is located within the Planning Jurisdiction.

This is the first extension request since the subdivision was originally approved in 2011. There have been no changes in conditions in the surrounding area that would affect the subdivision as previously approved; nor have the changes to the Regulations affected the previous approval.

It should be noted that road construction is required prior to the recording of the subdivision.

Based on the preceding, it is recommended that this request for extension be approved and that the applicant be advised that future extensions may be unlik

LOCATOR MAP

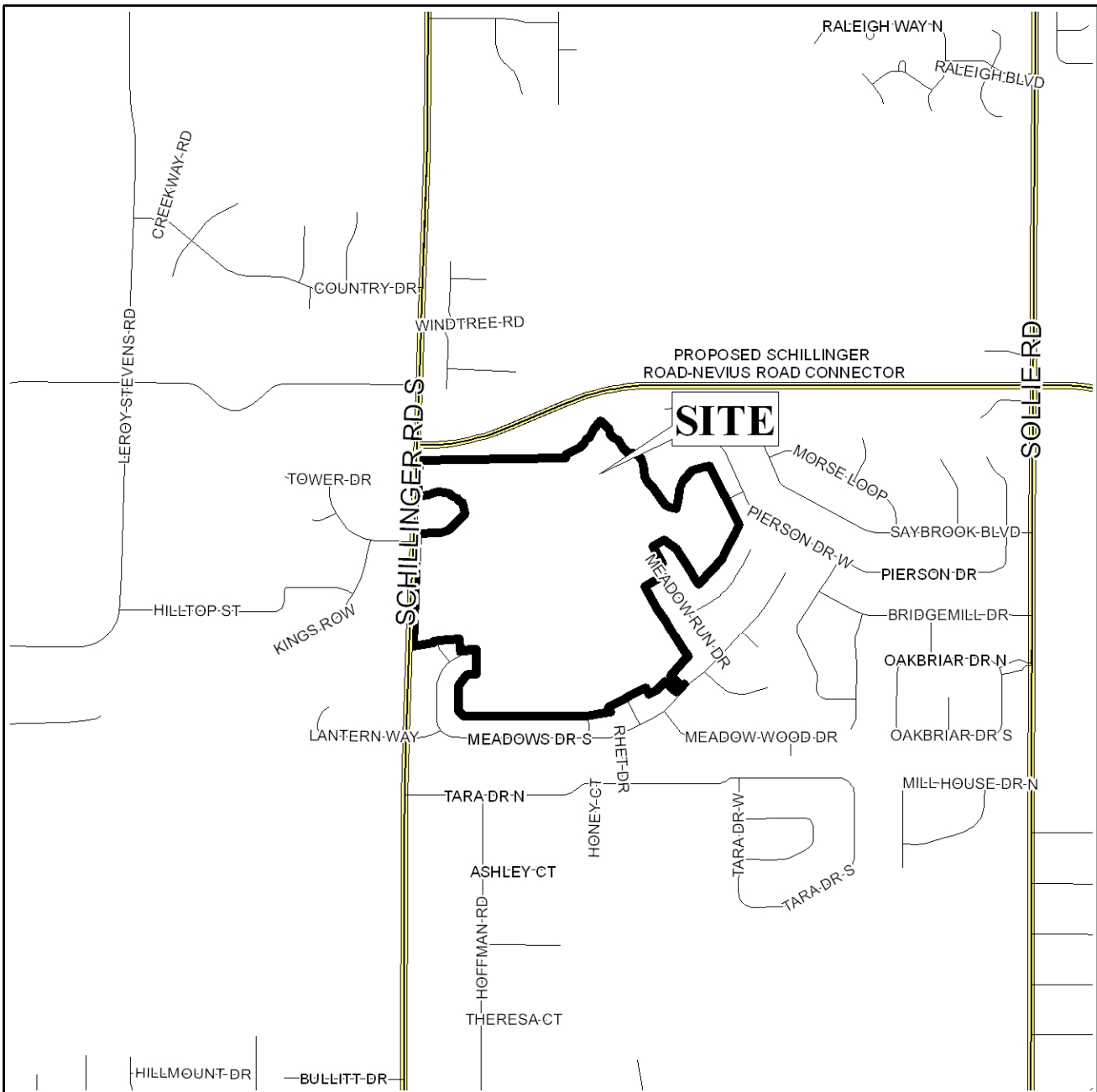

APPLICATION NUMBER 6 DATE January 3, 2013

APPLICANT Liberty Subdivision

REQUEST Subdivision



NTS

LIBERTY SUBDIVISION

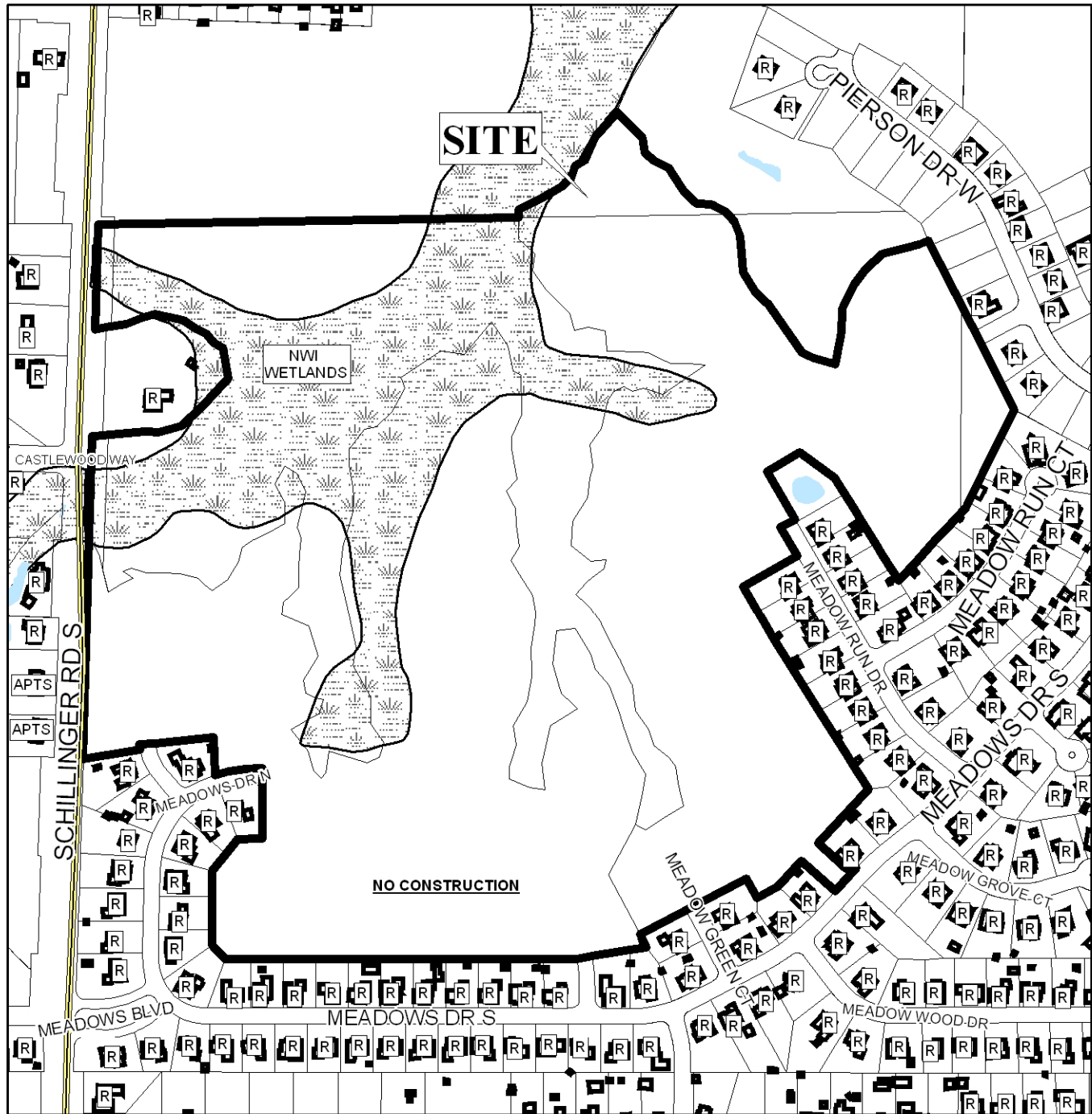

APPLICATION NUMBER 6 DATE January 3, 2013

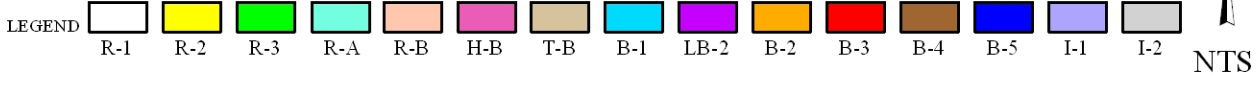

LIBERTY SUBDIVISION



APPLICATION NUMBER 6 DATE January 3, 2013



DETAIL SITE PLAN

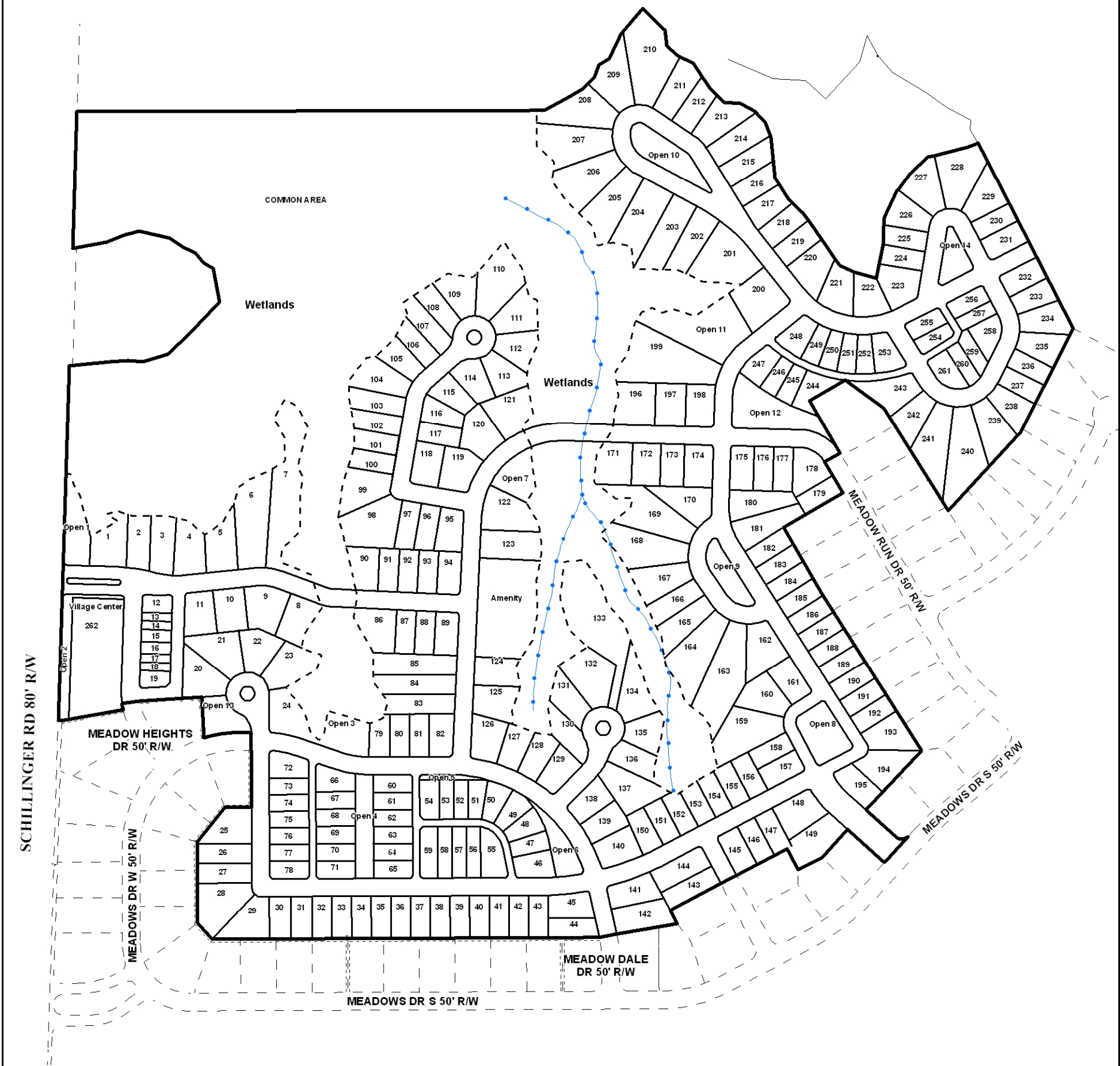

APPLICATION NUMBER 6 DATE January 3, 2013
APPLICANT Liberty Subdivision
REQUEST Subdivision

