

C & W ESTATES SUBDIVISION

Engineering Comments: Must comply with the Mobile County Flood Damage Prevention Ordinance.

The plat illustrates the proposed 2 lot, 2.0 \pm acres subdivision which is located on the East side of Latigo Road, $\frac{1}{4}$ mile \pm South of Scott Dairy Loop Road South. The subdivision is served by individual wells and septic tanks.

The purpose of this application is to create a two-lot subdivision from two metes and bounds parcels.

This site is located in the County, thus a note should be placed on the final plat stating that any lots which are developed commercially and adjoin residentially developed property must provide a buffer, in compliance with Section V.A.7. of the Subdivision Regulations.

The plat meets the minimum requirements of the Subdivision Regulations and is recommended for Tentative Approval subject to the following condition: 1) the placement of a note on the final plat stating that any lots which are developed commercially and adjoin residentially developed property must provide a buffer, in compliance with Section V.A.7. of the Subdivision Regulations.

LOCATOR MAP

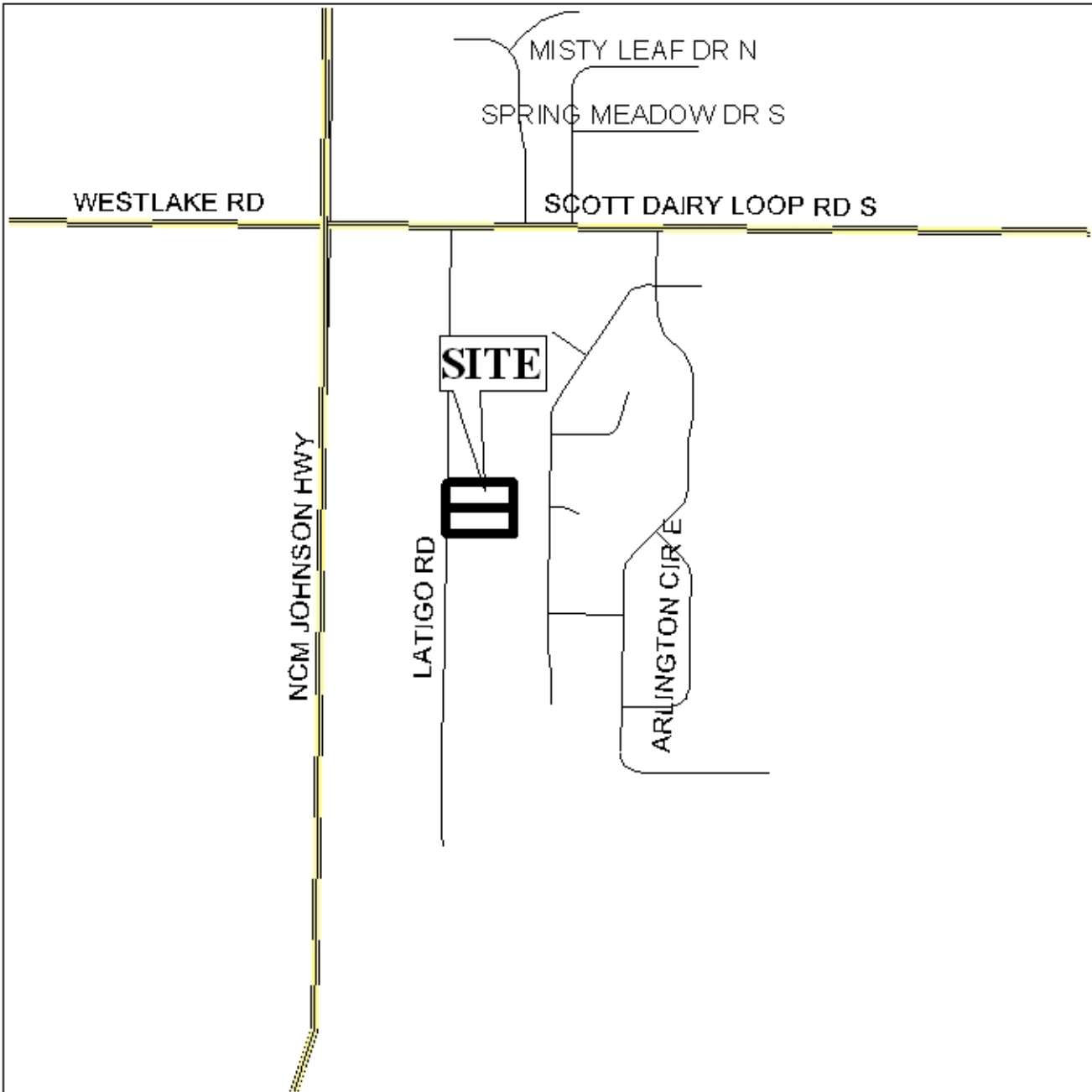

APPLICATION NUMBER 6 DATE November 3, 2005

APPLICANT C & W Estates Subdivision

REQUEST Subdivision



C & W SUBDIVISION

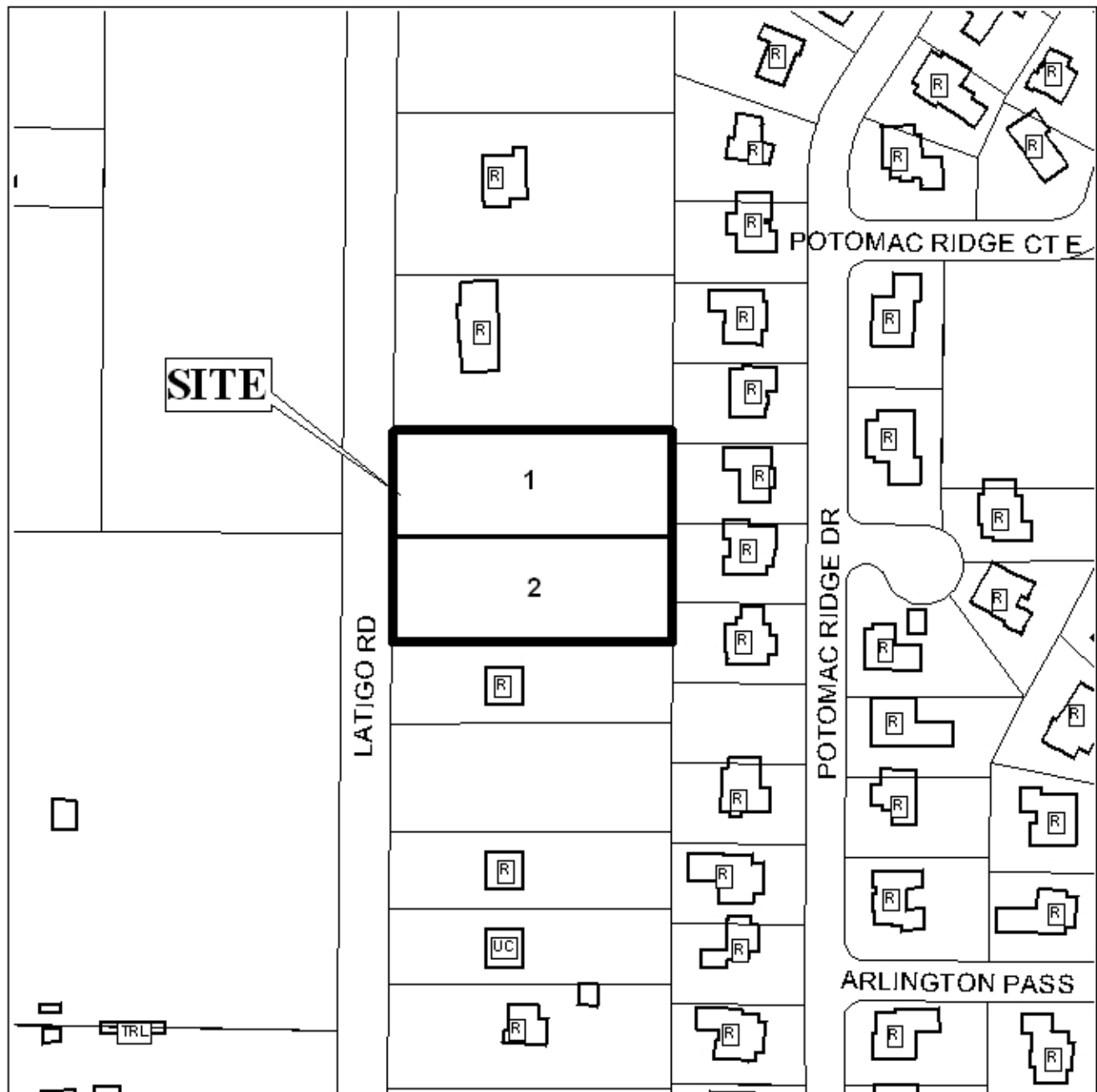

APPLICATION NUMBER 6 DATE November 3, 2005

LEGEND

R-1	R-2	R-3	R-A	R-B	H-B	B-1	LB-2	B-2	B-3	B-4	B-5	I-1	I-2

