

COLONIAL HILLS SUBDIVISION, UNIT 6

This is a request for a one-year extension of a previously approved 23-lot subdivision. The subdivision is located on the North terminus of Colonial Crossing, extending to the South side of Airport Boulevard, 220'± East of Snow Road South, in the county.

This is the second extension request since the subdivision was originally approved in 2008.

There have been no changes in conditions in the surrounding area that would affect the subdivision as previously approved. Roads for the subdivision are currently under construction, and the applicant states that additional time is needed to complete the roads.

Due to the fact that road construction has begun, this request for extension is recommended for approval.

LOCATOR MAP

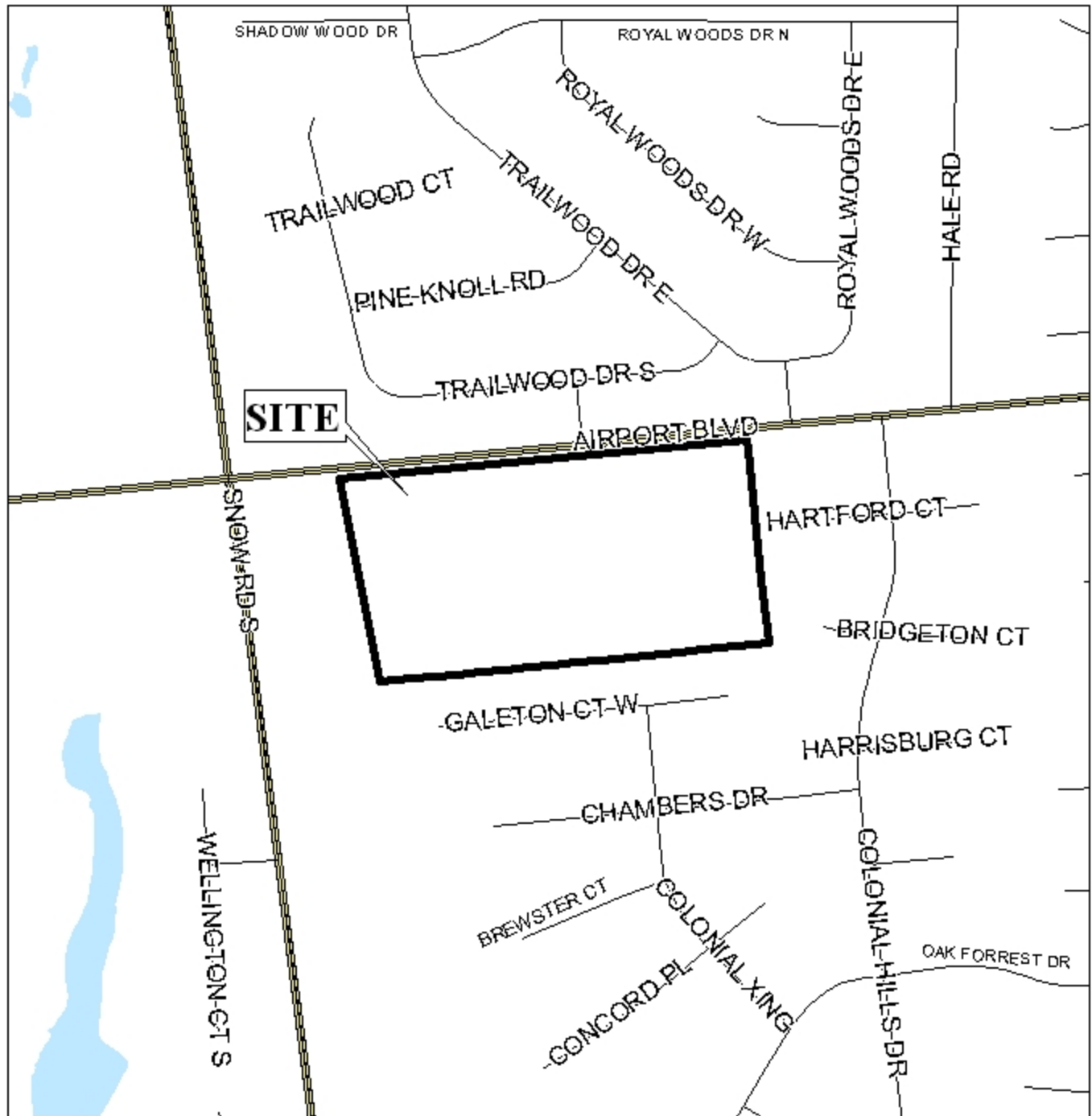

APPLICATION NUMBER 5 DATE October 7, 2010

APPLICANT Colonial Hills Subdivision, Unit 6

REQUEST Subdivision



PLANNING COMMISSION VICINITY MAP - EXISTING ZONING



The site is surrounded by single family residential units.

APPLICATION NUMBER 5 DATE October 7, 2010

APPLICANT Colonial Hills Subdivision, Unit 6

REQUEST Subdivision

LEGEND

R-1	R-2	R-3	R-A	R-B	H-B	T-B	B-1	LB-2	B-2	B-3	B-4	B-5	I-1	I-2
-----	-----	-----	-----	-----	-----	-----	-----	------	-----	-----	-----	-----	-----	-----

NTS

PLANNING COMMISSION VICINITY MAP - EXISTING ZONING



The site is surrounded by single family residential units.

APPLICATION NUMBER 5 DATE October 7, 2010
APPLICANT Colonial Hills Subdivision, Unit 6
REQUEST Subdivision

N
NTS

DETAIL SITE PLAN

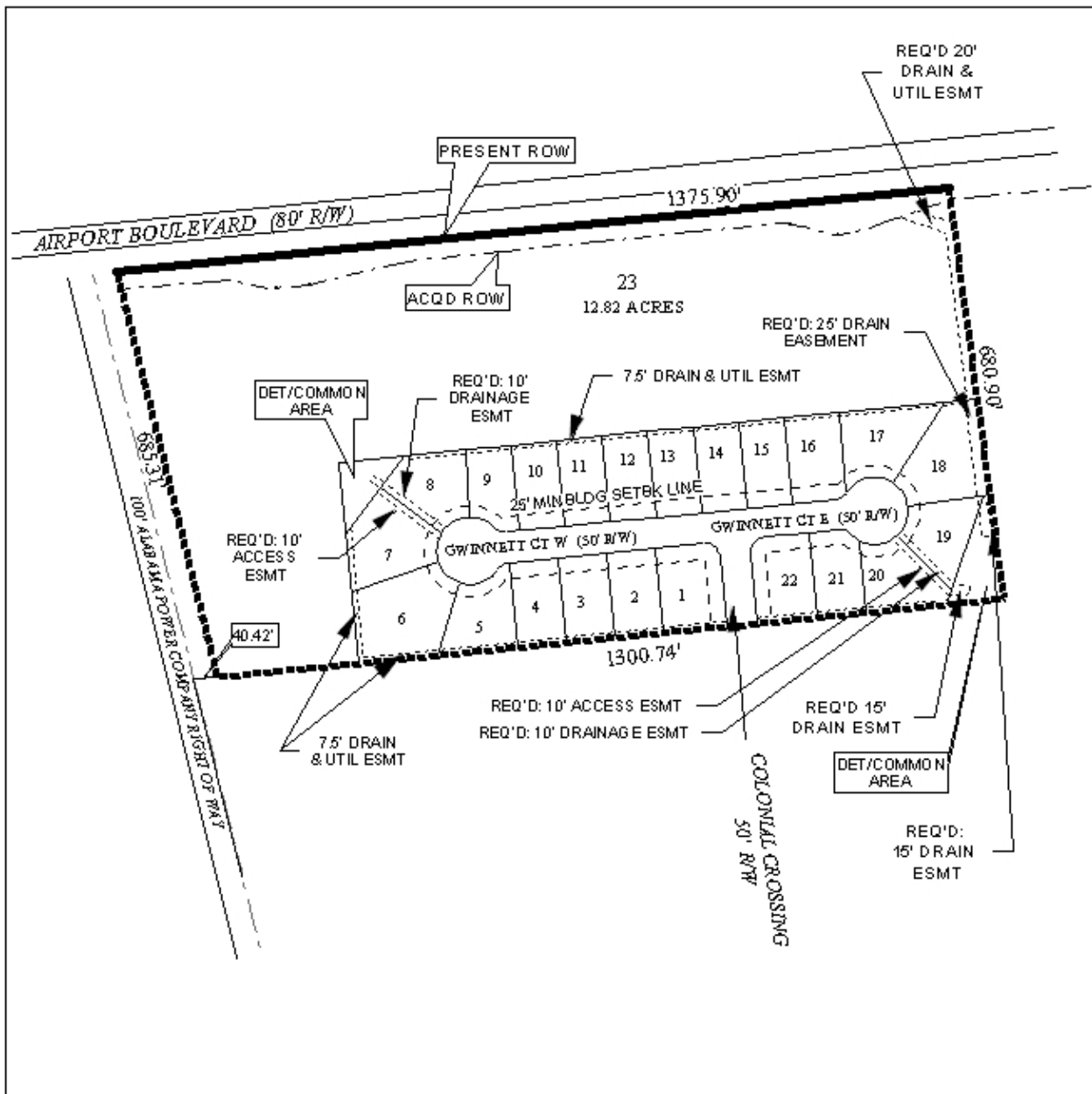

APPLICATION NUMBER 5 DATE October 7, 2010
 APPLICANT Colonial Hills Subdivision, Unit 6
 REQUEST Subdivision



NTS