

**MOBILE TREE COMMISSION  
STAFF REPORT****Date: February 21, 2017****APPLICANT NAME**

Thomas Doyle, Agent for Joseph Kenny

**LOCATION**400 St. Louis Street  
(North side of St Louis Street, between N Hamilton and N  
Franklin Streets)**REQUEST**Remove five trees: one 3" caliper Live Oak; one 6" caliper  
Live Oak; one 10" caliper Live Oak; and two 18' tall Crepe Myrtles**CITY COUNCIL  
DISTRICT**

District 2

**PRESENT ZONING**

T-5.

**HEALTH OF TREE**

The tree appears to be in good health

**CONTRIBUTING  
FACTORS**

N/A

**ENGINEERING  
COMMENTS**

None

**TRAFFIC ENGINEERING  
COMMENTS**

None

**URBAN FORESTRY  
COMMENTS**

Urban Forestry recommends removal of tree #1,#3 and #4. The 3 inch live oak, is covered by the canopy of a large live oak and will never reach its potential because of soil compaction and the canopy being covered. The crepe myrtles will be replaced by a better quality trees on private property. Urban Forestry recommends denying to remove #2 and #5 as the live oaks are healthy with access to full sun and are beginning to show some real growth.

**PLANNING  
COMMENTS**

The site is under redevelopment, and was before the Planning Commission December 15, 2016 for Subdivision and an amendment to the Regulating Plan for the Downtown Development District (DDD). Due to its location in the DDD, the proposed redevelopment was also considered by the Consolidated Review Committee. Both applications were approved. Please note that those reviews and approvals do not include reviews of trees to be planted in or removed from the right-of-way, other than a statement to the applicant(s) that compliance with the state act and zoning ordinance with regard to trees on private or public property is required.

**MAWSS**

N/A

**ANALYSIS**

As indicated above, the property is undergoing redevelopment, and has been reviewed for private property improvements and compliance with the DDD regulations and the applicant advised that any trimming and/or removal of trees in the right-of-way would have to be reviewed and approved by the Tree Commission.

Also as indicated above, Urban Forestry has reviewed the plans and visited the site and determined that the 6" and 10" live oaks should remain. Forestry further determined that the 3" live oak would not reach its potential due to the canopy of a much larger live oak on the private property and soil compaction. The two 18' tall crepe myrtles are to be replaced with more appropriate trees. Based on this information, Forestry recommended that the 3" live oak and the two crepe myrtles be approved for removal.

**RECOMMENDATION**

Based on the preceding, this request is recommended as follows:

1. Denial of the request to remove the 6" and 10" live oaks;
2. Approval of the request to remove the 3" live oak and two crepe myrtles;
3. All work is to be at the applicant's expense; and
4. All work in the right-of-way requires a right-of-way permit.



2017 JAN 17 A 11:25

### APPLICATION FOR PERMIT

CITY OF MOBILE  
MOBILE TREE COMMISSION

Application No. \_\_\_\_\_  
Date: January 12, 2017

**1. Applicant:**

Name: Thomas Doyle (LA+SOUTH)

Address: PO Box 40878

Mobile, AL Zip Code: 36640

E-mail: design@lasouth.com

Telephone Number: 251.431.7174

**2. Owner (if different from applicant):**

Name: Joseph Kenny (Precision Engineering)

Address: 5550 Commerce Blvd. E

Mobile, AL Zip Code: 36619

E-mail: joe.kenny@precision-eng.com

Telephone Number: 251.443.8844

3. Location of Tree: 400 St. Louis Street (Block) City Council District: 2

4. Type of Tree: See Attached Trim: Remove: ☒

5. Approximate Diameter four (4) feet from the ground: See Attached Height: See Attached

6. Reason for Removal or Trimming as Requested: See Attached

Applicant

Owner - if different from applicant

Application Fee - None

Applicant or Agent must be present at meeting to represent request.

All supporting information (photos, location plan, names and addresses of the applicant, property owner, adjacent property owners and directly across the street - on mailing labels, along with postage fee and \$1.00 notification fee for each) must be submitted with the application (Two Copies) by filing date.

Appeals must be made in writing to the Mobile City Council within 15 days of the decision.

Major projects involving multiple trees may be held over to the following month's agenda due to the time required by staff to investigate.

P. O. Box 1827 - Mobile, Alabama 36633-1827

Telephone: 251/208-5895

Fax: 251/208-5896

e-mail: Planning@cityofmobile.org

MTCAPP - 07/15/2015



16 January 2017

Mobile Tree Commission  
City of Mobile  
Request for Removal of Five Trees in R.O.W.

Included with Application: *Tree Location Plan*  
*Proposed Site Plan*

Project: New Offices for Precision Engineering  
400 St. Louis Street

General Description of Work: Precision Engineering is restoring and moving their offices to the old Threaded Fastener's Building at 400 St. Louis Street downtown. There are currently three buildings on the property, one of which will be removed. The building to be removed is immediately adjacent to the trees we are requesting be allowed to be removed. Along with the complete restoration of the remaining buildings and site the project will include the demolition and replacement of all sidewalks, curbs, and gutters around the entire block. Curb bulb-outs are being added to St. Louis Street (similar the proximate Buick Building). Trees and groundcovers will be added on the St. Louis Street frontage. Although not required by code new large canopy trees are being proposed along St. Anthony and N. Franklin Streets, between the parking lot and R.O.W.. All new trees will be Florida Fancy grade, field-grown B&B trees hand selected at the nursery by the Project Landscape Architect. We anticipate all trees will be 3"-3.5" caliper at the time of installation. The trees along St. Anthony and Franklin will serve both as screening and shading for the parking and as they mature will achieve a large continuous street tree canopy. An existing 32" caliper Live Oak in the R.O.W. on N. Hamilton is scheduled to remain. The new design we will be providing additional open soil area around the tree and great care will be taken to protect the tree during construction.

Trees Removal Request: **Tree #1:** 3" caliper Live Oak approximately 20' Tall  
**Tree #2:** 6" caliper Live Oak approximately 22' Tall  
**Tree #3:** 18' Crepe Myrtle  
**Tree #4:** 18' Crepe Myrtle  
**Tree #5:** 10" caliper Live Oak approximately 26' Tall

Reasons for Request: We are concerned about the feasibility of protecting the trees in question during construction due to planned demolition of the adjacent sidewalks and curbs but are particularly concerned due to the planned demolition of the adjacent building. The existing building is approximately 5' +/- from the trees. Tree #1 is already in poor condition. Tree #2 is in better condition but both are under existing utility lines. The two Crepe Myrtles seem to be in good shape as well as the 10" Live Oak (Trees #3, #4, & #5). All trees have extremely limited open soil area. As note before the design is showing approximately (15) new large canopy trees as 'replacements' for the trees we are requesting be removed.

**G&K SERVICES CO A MINNESOTA**  
Attn: TAX DEPARTMENT  
5995 OPUS PKWY STE 500  
MINNITONKA, MN 55343

**WARD PROPERTIES**  
P.O. BOX 1824  
MOBILE, AL 36633

**OFFICE OF CITY CLERK**  
CITY OF MOBILE  
205 GOVERNMENT PLAZA  
MOBILE, AL 36644

**CHRISTIAN BENEVOLENT FUNERAL**  
201 N HAMILTON ST  
MOBILE, AL 36603

**PRECISION ENGINEERING**  
550 COMMERCE BLVD E  
MOBILE, AL 36619

**DAVID W HARBIN**  
354 ST ANTHONY ST  
MOBILE, AL 36603

**THREADED FASTENERS INC**  
3200 CRICHTON ST  
MOBILE, AL 36607

**LA+SOUTH INC**  
PO BOX 40878  
MOBILE, AL 36640

2017 JAN 17 A 11:25

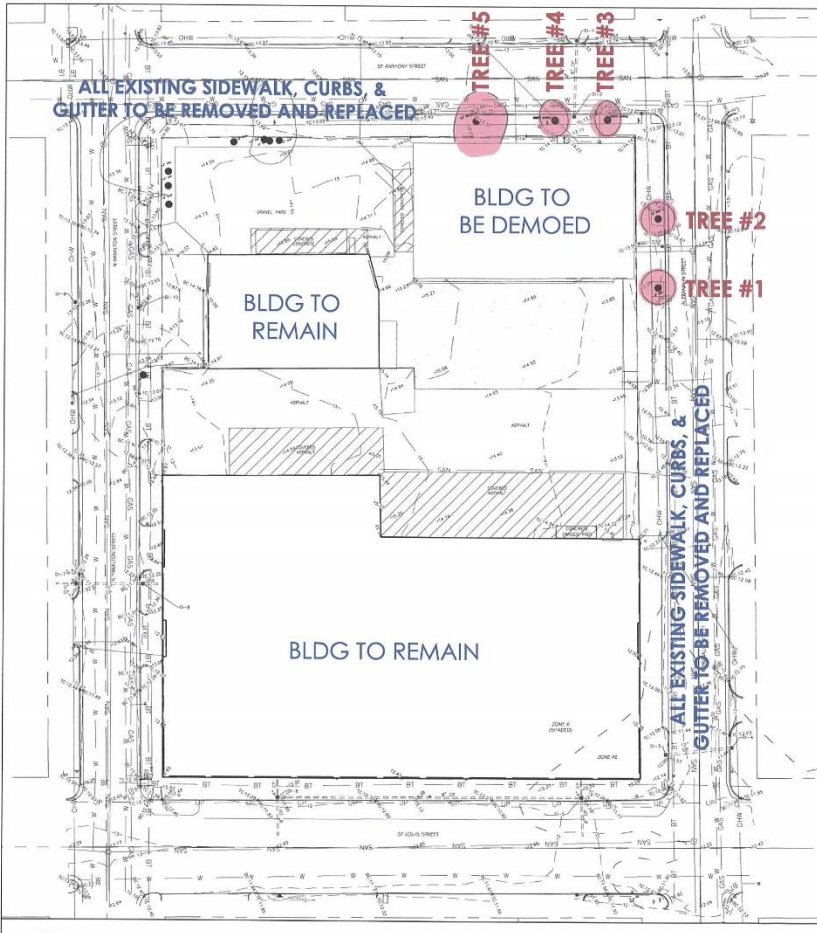

1  
L-001  
EXISTING SITE PLAN  
SCALE 1" = 20'-0"

TREE #3  
18' CREPE MYRTLE

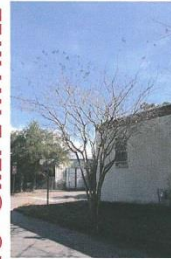

TREE #2  
6" LIVE OAK



TREE #1  
3" LIVE OAK



TREE #5  
10" LIVE OAK



TREE #4  
18' CREPE MYRTLE



2017 JAN 17 A 11:25

SCALE: 1" = 20'-0"



**LA SOUTH**  
LANDSCAPE ARCHITECTURE  
PLANNING

204 Douglas Street  
Mobile, Alabama 36688  
P: 251 431 7124

PRECISION ENGINEERING  
Owner: LA-SOUTH, INC.  
3100 South Central Avenue  
Lubbock, Texas 79424  
Precision Engineering  
Professional Engineer  
Project: Stamps Int'l  
Project Location  
Gulf State Engineering  
Mobile

PROFESSIONAL SEAL

NEW OFFICE FOR PRECISION  
ENGINEERING  
400 ST. LOUIS STREET  
MOBILE, AL 36602

No.	Description	Date
1		
2		
3		
4		
5		
6		
7		
8		
9		
10		
11		
12		
13		
14		
15		
16		
17		
18		
19		
20		
21		
22		
23		
24		
25		
26		
27		
28		
29		
30		
31		
32		
33		
34		
35		
36		
37		
38		
39		
40		
41		
42		
43		
44		
45		
46		
47		
48		
49		
50		
51		
52		
53		
54		
55		
56		
57		
58		
59		
60		
61		
62		
63		
64		
65		
66		
67		
68		
69		
70		
71		
72		
73		
74		
75		
76		
77		
78		
79		
80		
81		
82		
83		
84		
85		
86		
87		
88		
89		
90		
91		
92		
93		
94		
95		
96		
97		
98		
99		
100		

NO COPYING, REPRODUCING, OR DISTRIBUTION OF ANY PART OF THIS DRAWING OR ANY INFORMATION CONTAINED HEREIN IS PERMITTED WITHOUT THE WRITTEN CONSENT OF THE ENGINEER OR ARCHITECT. ANY VIOLATION OF THIS NOTICE SHALL BE CONSIDERED A VIOLATION OF THE PROFESSIONAL ETHICS OF THE ENGINEER OR ARCHITECT.

SHEET TITLE  
EXISTING SITE PLAN

SHEET NUMBER  
L-0.01

XX/XX/XX  
Issue Date

Project Status: XX



# MOBILE TREE COMMISSION LOCATOR MAP

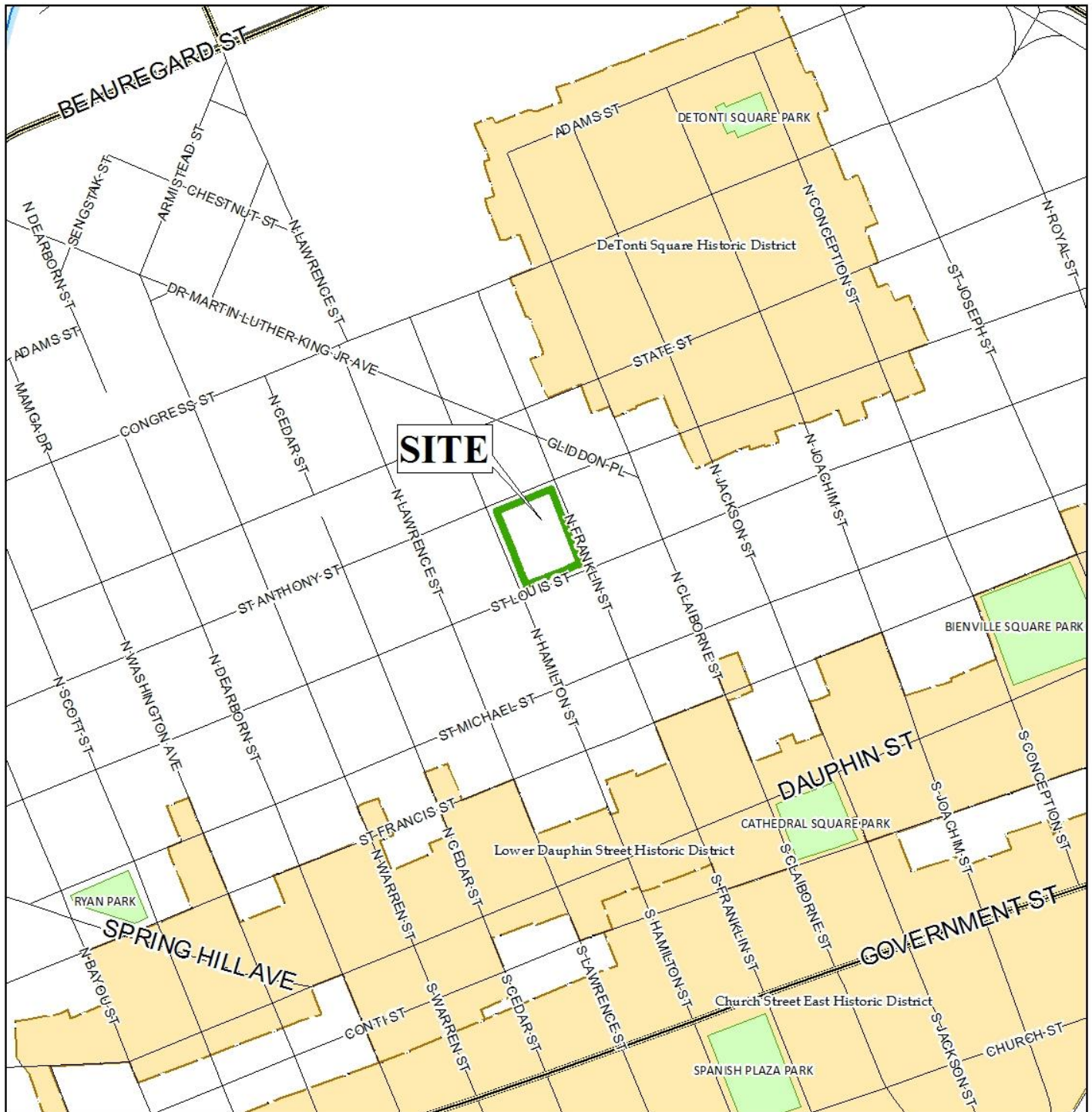

Application P-2017-005 Date February 21, 2017  
Location 400 St. Louis Street  
Request Remove three Live Oaks, and two 18' tall Crepe Myrtles

1 inch = 500 feet





# MOBILE TREE COMMISSION VICINITY MAP



Application P-2017-005 Date February 21, 2017  
Location 400 St. Louis Street  
Request Remove three Live Oaks, and two 18' tall Crepe Myrtles

1 inch = 83 feet





## MOBILE TREE COMMISSION VICINITY MAP

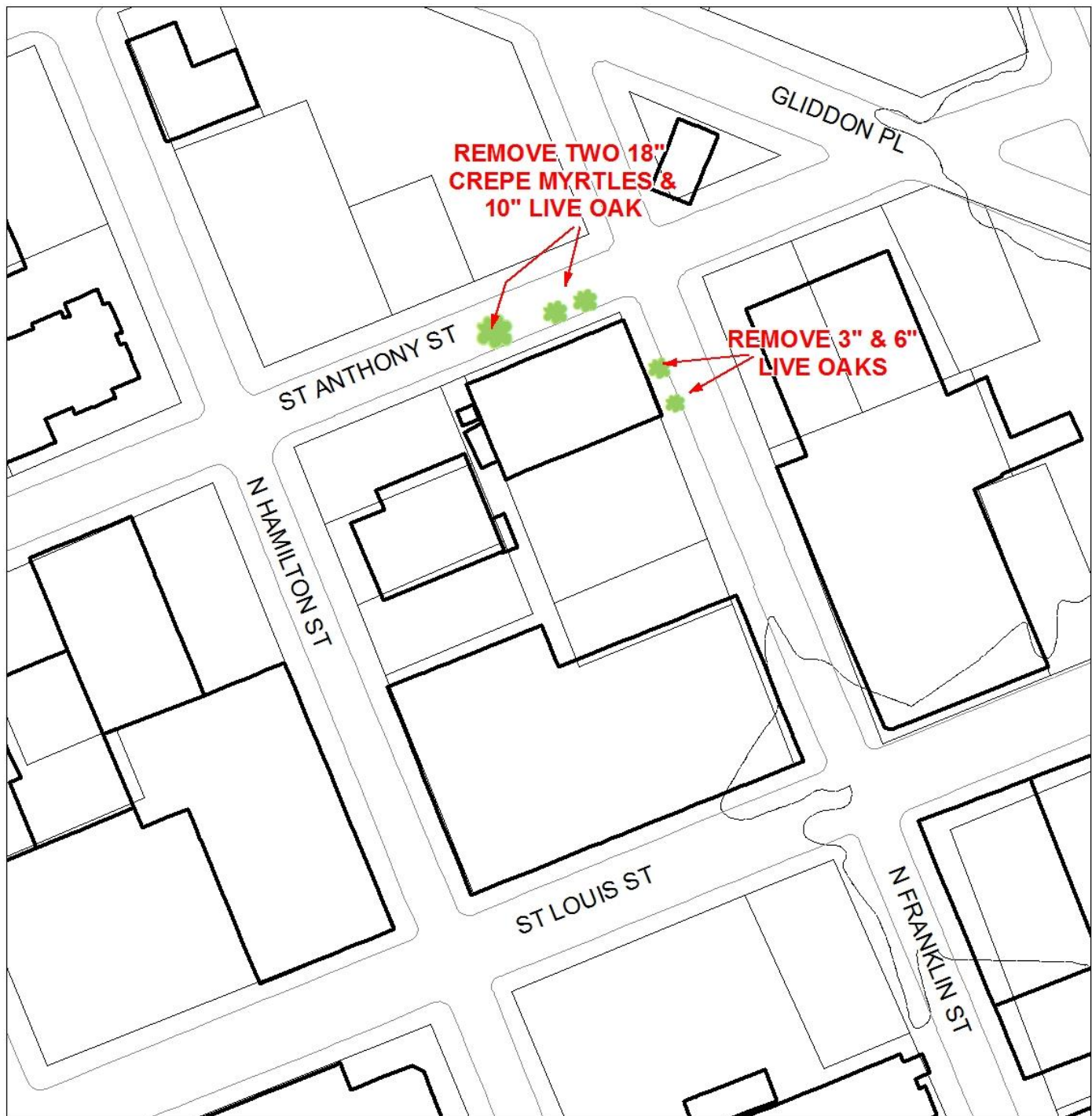

Application P-2017-005 Date February 21, 2017

Location 400 St. Louis Street

Request Remove three Live Oaks, and two 18' tall Crepe Myrtles

1 inch = 83 feet



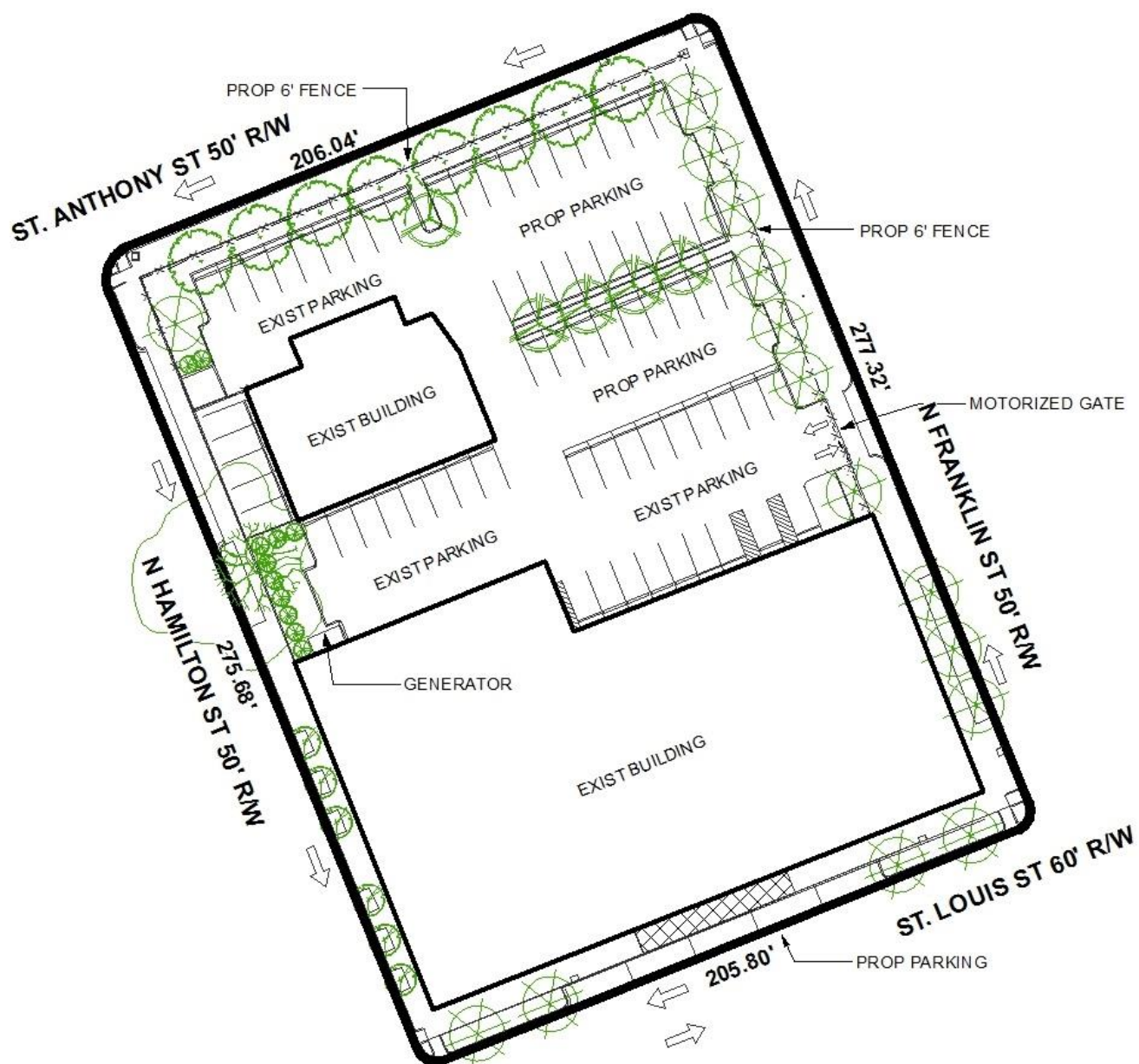



Google Maps 400 St Anthony St



Image capture: Nov 2016 © 2017 Google

Mobile, Alabama  
Street View - Nov 2016



<https://www.google.com/maps/@30.6936172,-88.048039,3a,75y,200.85h,81t/data=!3m6!1e1!3m4!1s2KzxUb9amCx4MPrN PmnbkQ!2e0!7i13312!8i6656!9m1!1e1>

Google Maps 400 St Anthony St



Image capture: Nov 2016 © 2017 Google

Mobile, Alabama

Street View - Nov 2016



[https://www.google.com/maps/@30.6935132,-88.0483042,3a,75y,119.93h,82.98t/data=!3m6!1e1!3m4!1siVWJCecf5p\\_eXjrxPeKw!2e0!7i13312!8i6656!6m1!1e1](https://www.google.com/maps/@30.6935132,-88.0483042,3a,75y,119.93h,82.98t/data=!3m6!1e1!3m4!1siVWJCecf5p_eXjrxPeKw!2e0!7i13312!8i6656!6m1!1e1)



196 N Franklin St



Image capture: Nov 2016 © 2017 Google

Mobile, Alabama  
Street View - Nov 2016



<https://www.google.com/maps/@30.693526,-88.04792,3a,75y,195.11h,71.57t/data=!3m6!1e1!3m4!1szMJ4VCfQTH-cp4B6X9ZQ-gl2e0!7i13312!8i6656!6m1!1e1>